



Operators Manual

815 Rice Lake Street, Owatonna, MN 55060

Phone: 800-443-2476 / 507-451 5430

www.gandy.net / Email: sales@gandy.net

Salt Inator®

42A-S Hopper Carton

42-inch Salt Spreader

For Use with #1 Free Flowing Rock Salt

With Spread Plate & Jigglers

This is used in the 4216T-S (Pull Type) & 4216H-S (Push Type)

Cam Gauge Settings for Salt:

For first starting set the cam gauge at #65 per picture below.

If this does not apply enough salt adjust to a higher number and try again.

Note: Depending on the size of the salt you may have to adjust to setting #80.

Setting Cam Gauge:

Move cam gauge away from the stop (close bottom openings) before attempting adjustment.

Loosen wing nut and turn cam gauge to desired number, using the top surface of the stop as the setting indicator and then tighten wing nut. See picture of cam gauge set at "65".

For example, if the spreader is to be used with the bottom completely open, the cam gauge would be turned until the graduating mark directly opposite the number 80 is in line with the top edge of the stop.

Likewise, if the spreader were to be half open, the graduation mark opposite the number 40 would be in line with the top edge of the stop.

Note: Numbers on the cam gauge DO NOT represent any application rate, they are reference numbers only for setting repeatability.



- 142A-S..... Hopper Carton Containing:**
(All Hardware & Parts in Place Unless Otherwise Specified)
- 12842-LG Hopper, 42-inch (Painted Lite Grey)
 Use: 6 Latch Assembly (280692)
 12 Rivet (4/16) (C17-0250-050)
 1 Decal, Salt Inator (N02-0001-131)
 1 Decal, Small USA
- 12899-1 Retainer, Bearing Left, w/ Spread plate Bracket
 Use: 1 SAE Washer (5/16) (C02-0312-020)
 1 Wing Nut (5/16) (C01-0312-020)
- 12899-2 Retainer, Bearing Right, w/ Spread plate Bracket
 Use: 1 SAE Washer (5/16) (C02-0312-020)
 1 Wing Nut (5/16) (C01-0312-020)
- 2090633-C1 End Bearing
- 12807953 Center Bearing (For 24-36-42 Inch Hoppers)
 Use: 1 Whiz Flange Nut (5/16) (C01-0312-030)
 1 Hex Bolt Self-Tapping (5/16 x 1) (C03-0312-042)
- 228427155 Rotor Bar, Tri-Rod (For 42-inch Hopper)
- 22807156 End Washer
- 12808942-7 Bottom & Slide, Variable Rate (For 42-inch Hopper)
 Use: 4 Nylon Grip Washer (C02-0250-011)
 4 Whiz Flange Nut (3/16) (C01-0187-030)
 1 SAE Washer (5/16) (C02-0312-020)
 1 Wing Nut (5/16) (C01-0312-020)
 1 Cam Gauge (2807175)
 1 Rear Hanger (28426912)
- 12808942-1 Spread Plate, w/ Seal (For 42-inch Hopper)
 Use: 3.48Ft Foam Strip (M05-0500-175)
 2 SAE Washers (5/16) (C02-0312-020)
 2 Sash Chain #25 (16 Links) (F03-0025-016) **(In Hardware Bag)**
 2 Hairpin Cotter (.08 x 1-9/16) (C21-0072-020) **(In Hardware Bag)**
 2 Cotter Pin (3/32 x 3/4) (C20-0093-020) **(In Hardware Bag)**
- 142-AH..... Hardware Bag Containing:**
- 2C20-0093-020 Cotter Pin (3/32 x 3/4)
- 2C21-0072-020 Hairpin Cotter (.08 x 1-9/16)
- 2F03-0025-016 Sash Chain #25 (16 Links)

42A-S Hopper Parts Schematic:

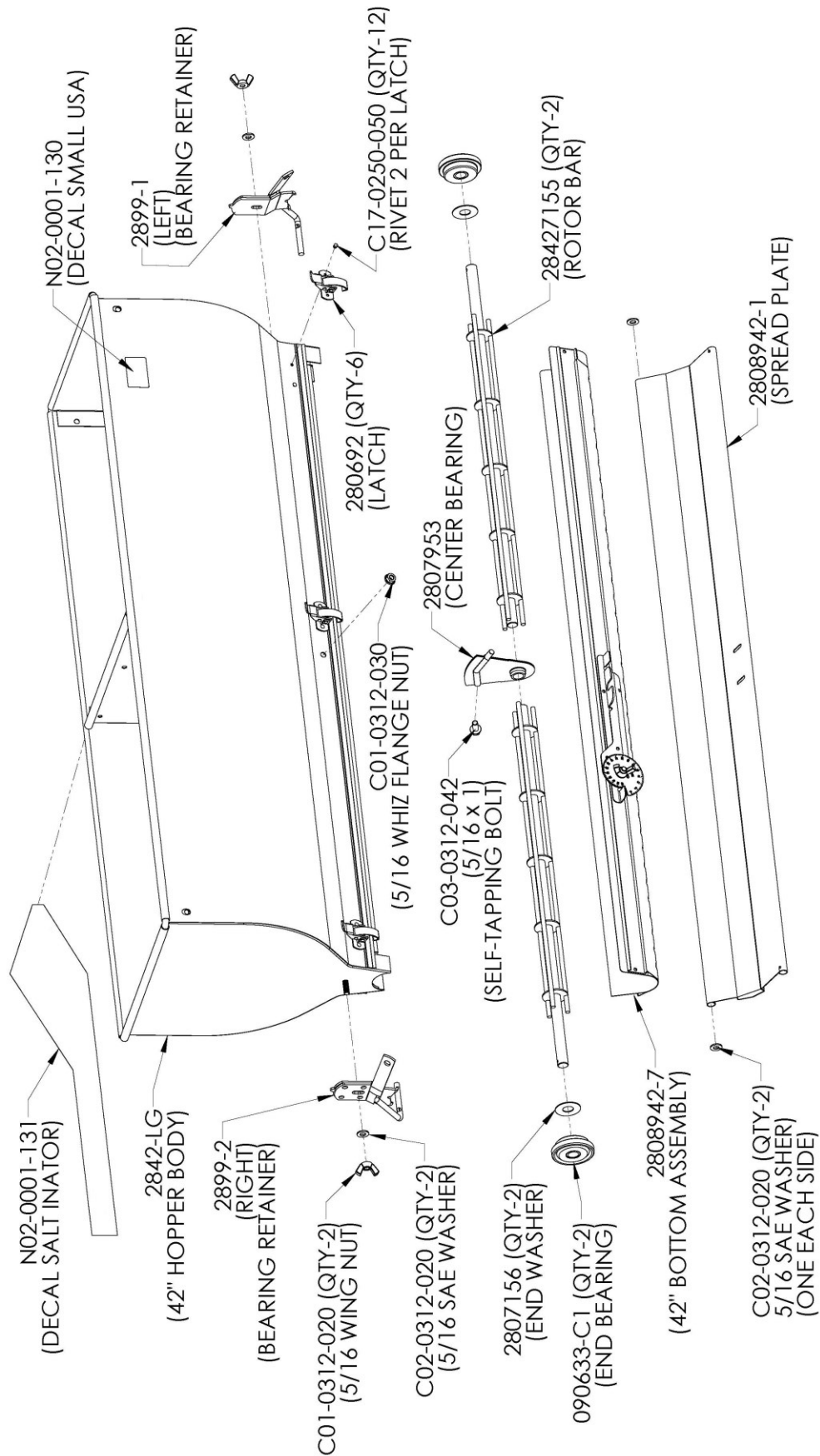

Parts Bag 42-AH Contents:

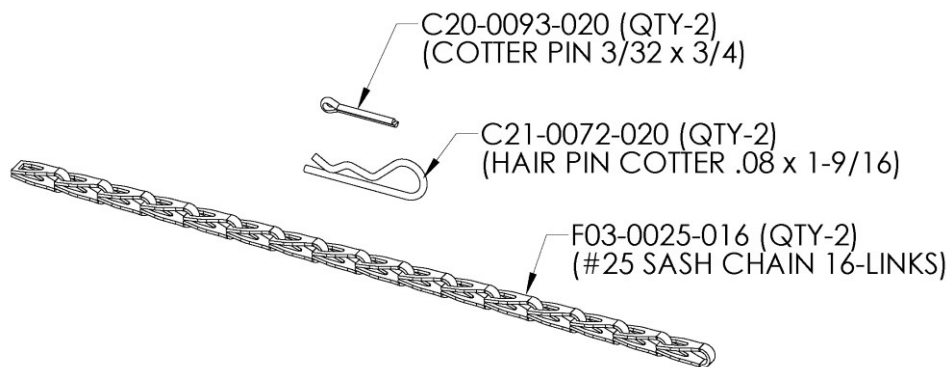

42-AH (2/6/25)

Sash Chain Instructions:

Insert round end of sash chain into round end of spread plat as shown.
Insert cotter pin through spread plate hole & round end of sash chain.
Then bend end of cotter pin to secure in place. Repeat for other side.

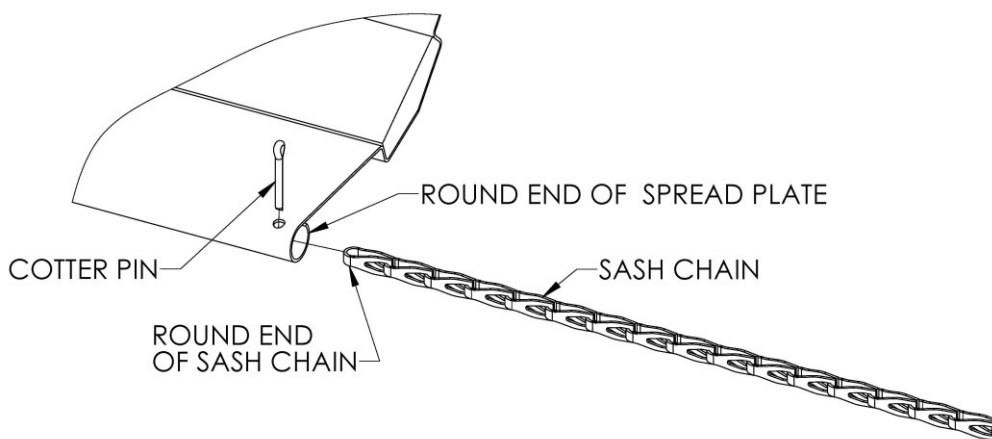

42-AH-A (2/5/25)

Sash Chain Instructions:

Connector the other end of the sash chain to the hole in the bar on the bearing retainer.
Slide sash chain through hole as shown and using the hair pin cotter connect to the fourth link in on the sash chain as shown. Repeat for other side.

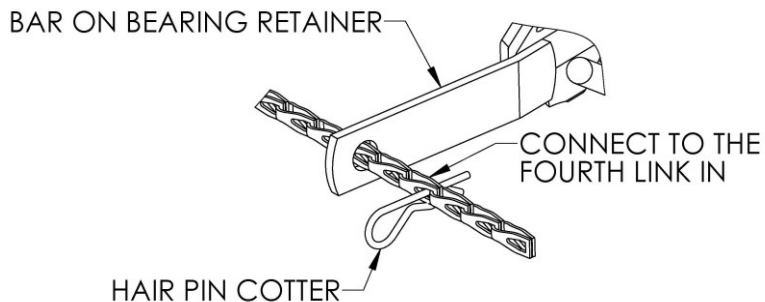

42-AH-B (2/5/25)

Jigglers (in place)

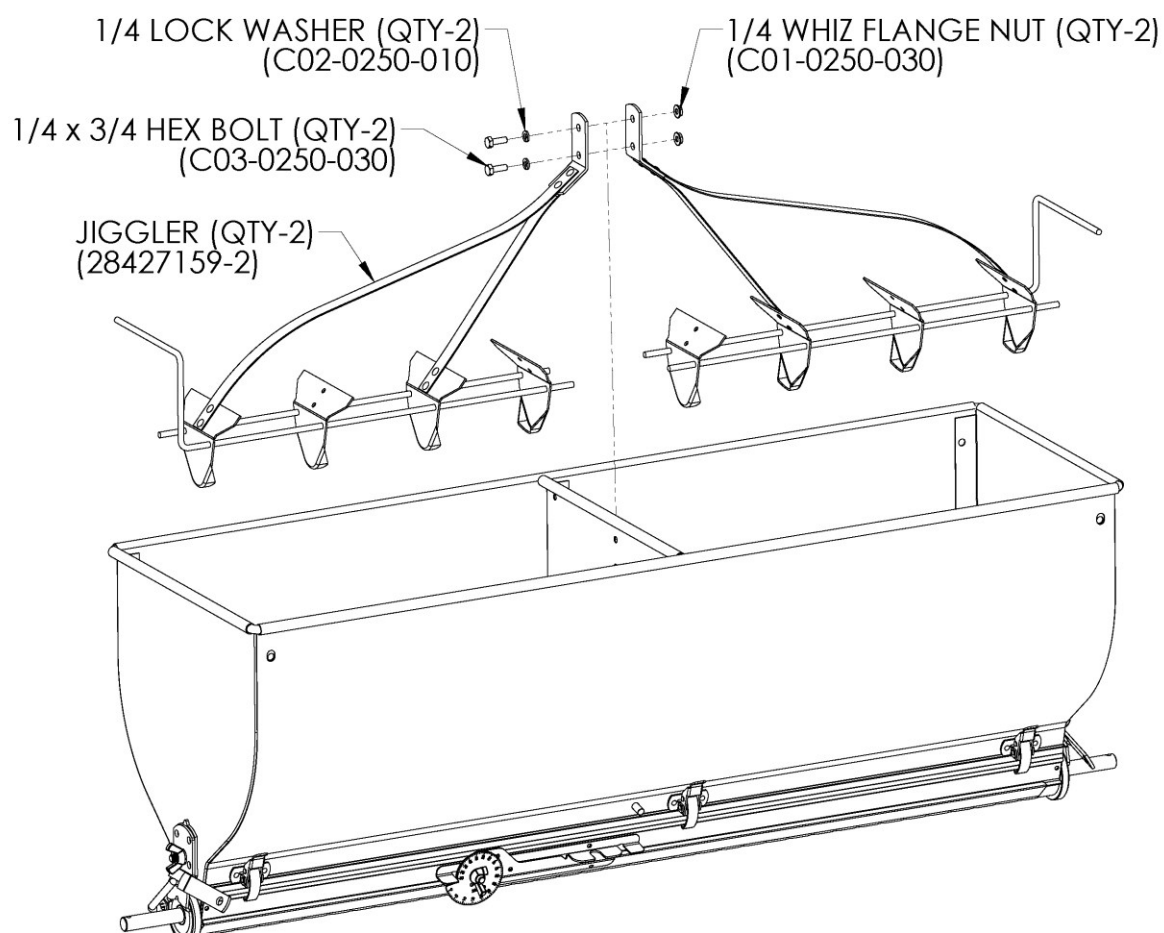

Push Handle Package 42H-A Parts Break Down:
You would only have received this package if you ordered a 42H16 Spreader.

Item #	Part #	Description	Qty
1	2806915	Hitch Pole	1
2	28427125-1	Brace Left 42"	1
3	28427125-2	Brace Right 42"	1
4	28427125-3	Stand 42"	1
5	28427225-4	T-Handle	1
6	2899-3	Pivot Shut-Off Arm	1
7	2899-4	Shut-Off Lever	1
8	2899-7	Pole Clevis	1
9	42H-H	Hardware Bag	1

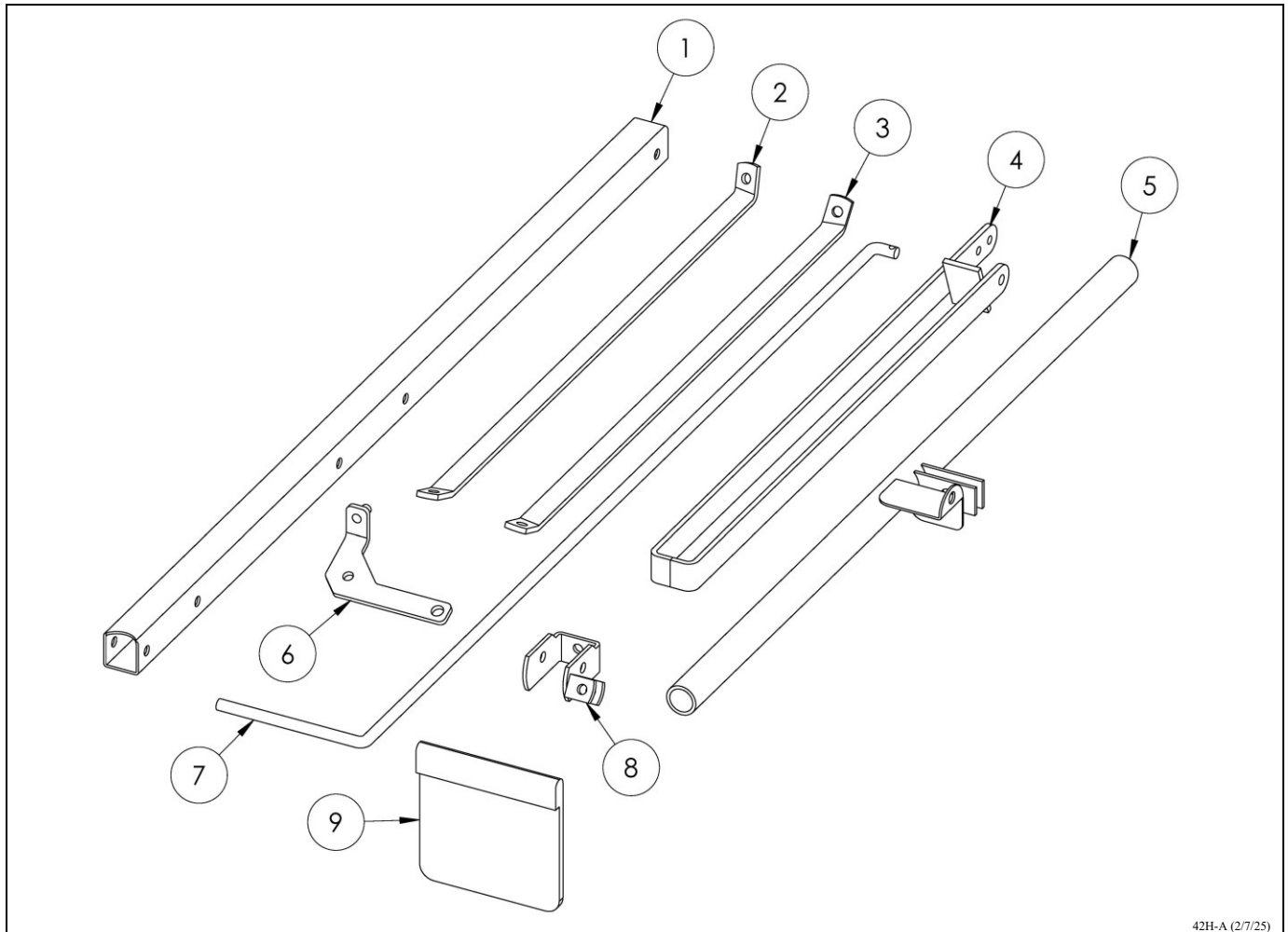

42H-A (2/7/25)

Hardware Bag 42H-H Containing the Following:

Item #	Part #	Description	Qty
1	C01-0312-030	Whiz Flange Nut (5/16)	5
2	C01-0312-040	Nylon Lock Nut (5/16)	1
3	C02-0312-030	Wrought Washer (5/16)	3
4	C02-0375-030	Wrought Washer (3/8)	1
5	C03-0312-021	Whiz Flange Bolt (5/16 x 5/8)	2
6	C03-0312-070	Hex Bolt (5/16 x 1-3/4)	1
7	C03-0312-080	Hex Bolt (5/16 x 2)	2
8	C03-0312-101	Hex Bolt (5/16 x 2-1/2)	1
9	C20-0125-020	Cotter Pin (1/8 x 3/4)	1
10	J01-0375-302	Grip Yellow (3/8 x 3)	1
11	J01-1000-462	Grip Yellow (1 x 4-5/8)	2

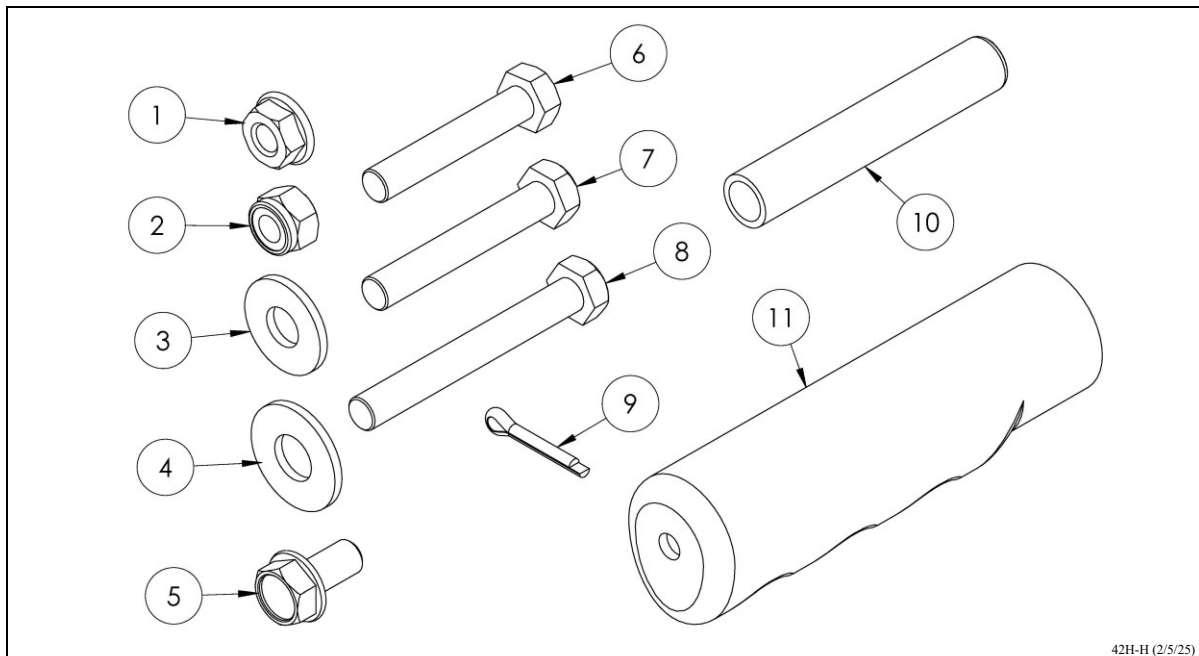

42H-H (2/5/25)

Push Handle Assembly Instructions

Step #1

Remove all parts & hardware from carton & hardware bag.

Note: Lay something down (piece of cardboard or a blanket) to protect hopper from being scratched.

Place hopper on its back so the cam gauge is facing up. As shown.

Remove the 5/16" flange nut from the stud above and to the right of the cam gauge.

Keep nut as it will be reused.

Next attach the Pole Clevis (part #2899-7) to the 5/16" stud & reuse the 5/16" flange nut. Tighten nut.

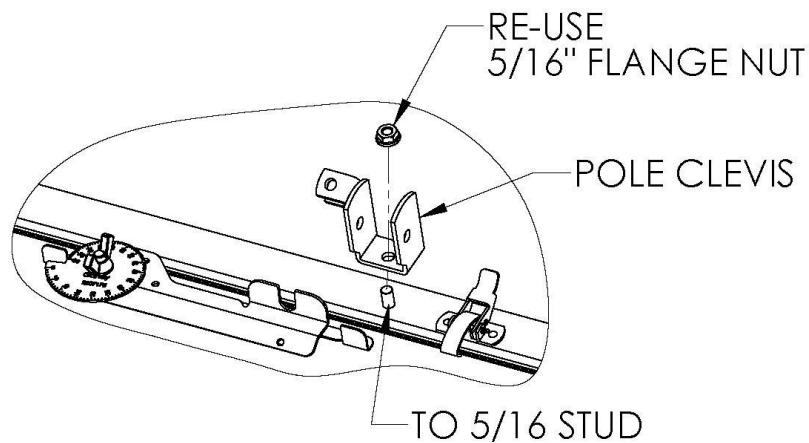
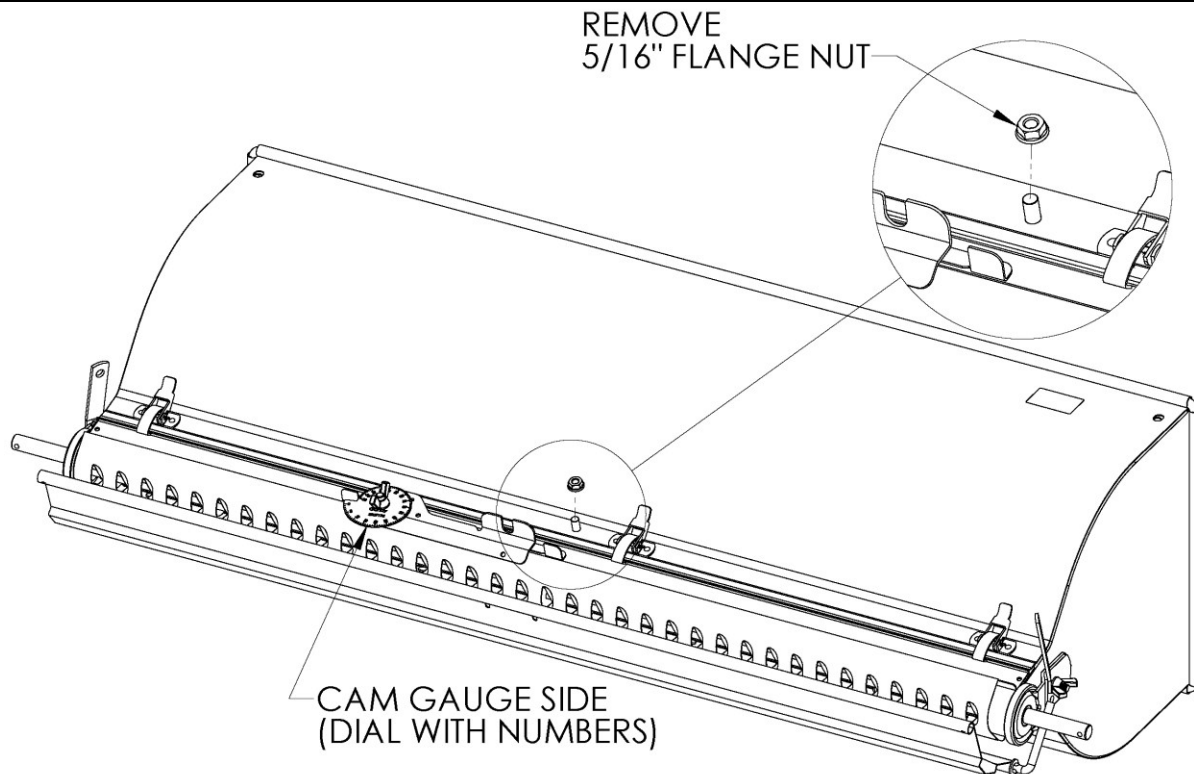

42H-A1 (2/6/25)

Push Handle Assembly Instructions

Step #2

Install the Hitch Pole (Part #2806915) to the pole clevis as show using the hardware shown. Do not tighten nut. Pivot the hitch towards the hopper until it touches the hopper.

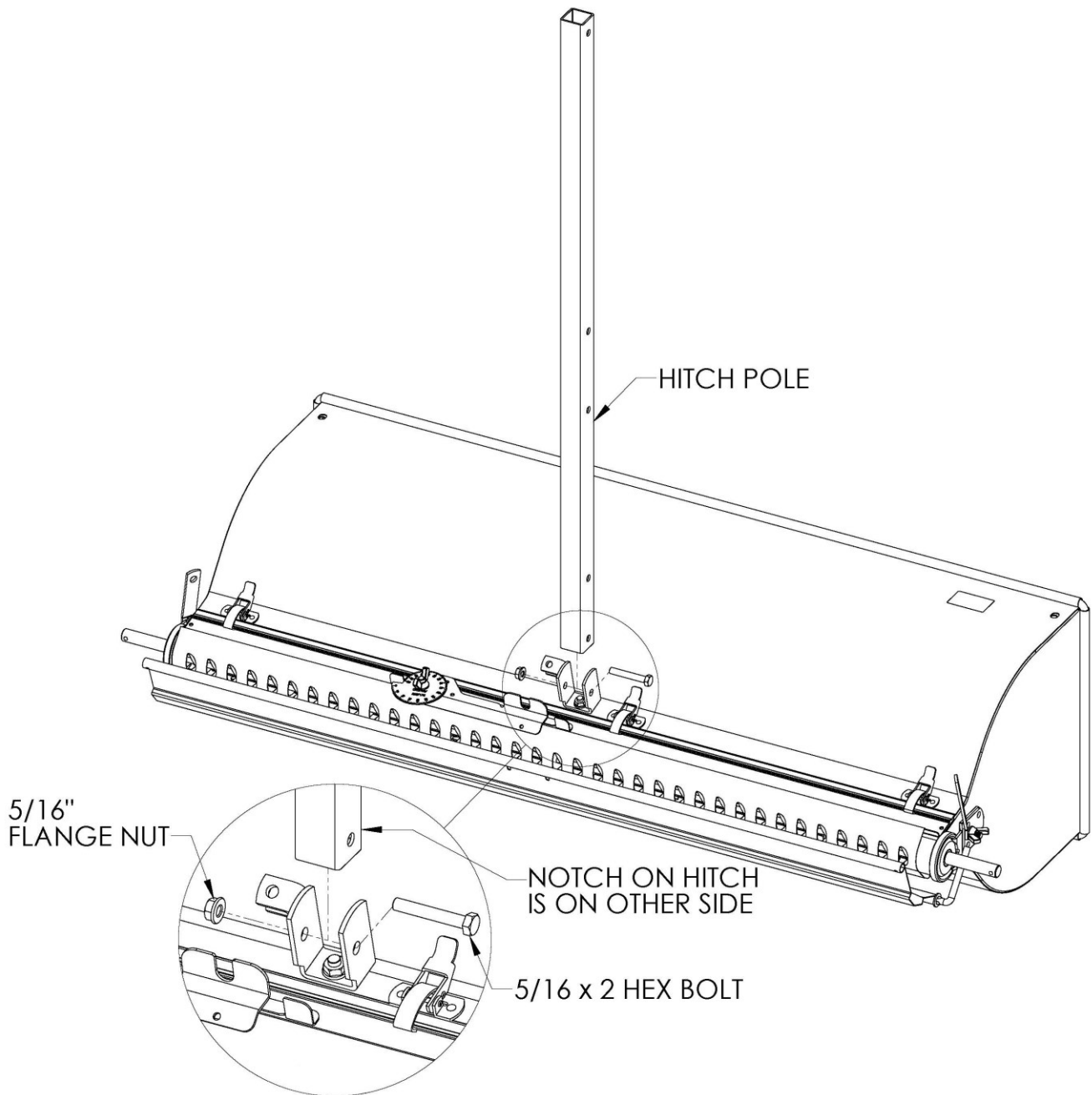

42H-A1 (2/6/25)

Push Handle Assembly Instructions

Step #3

Install the Right Brace (Part #28427125-2) to the hopper using the hardware shown.
Do not tighten leave bolt vary loose.

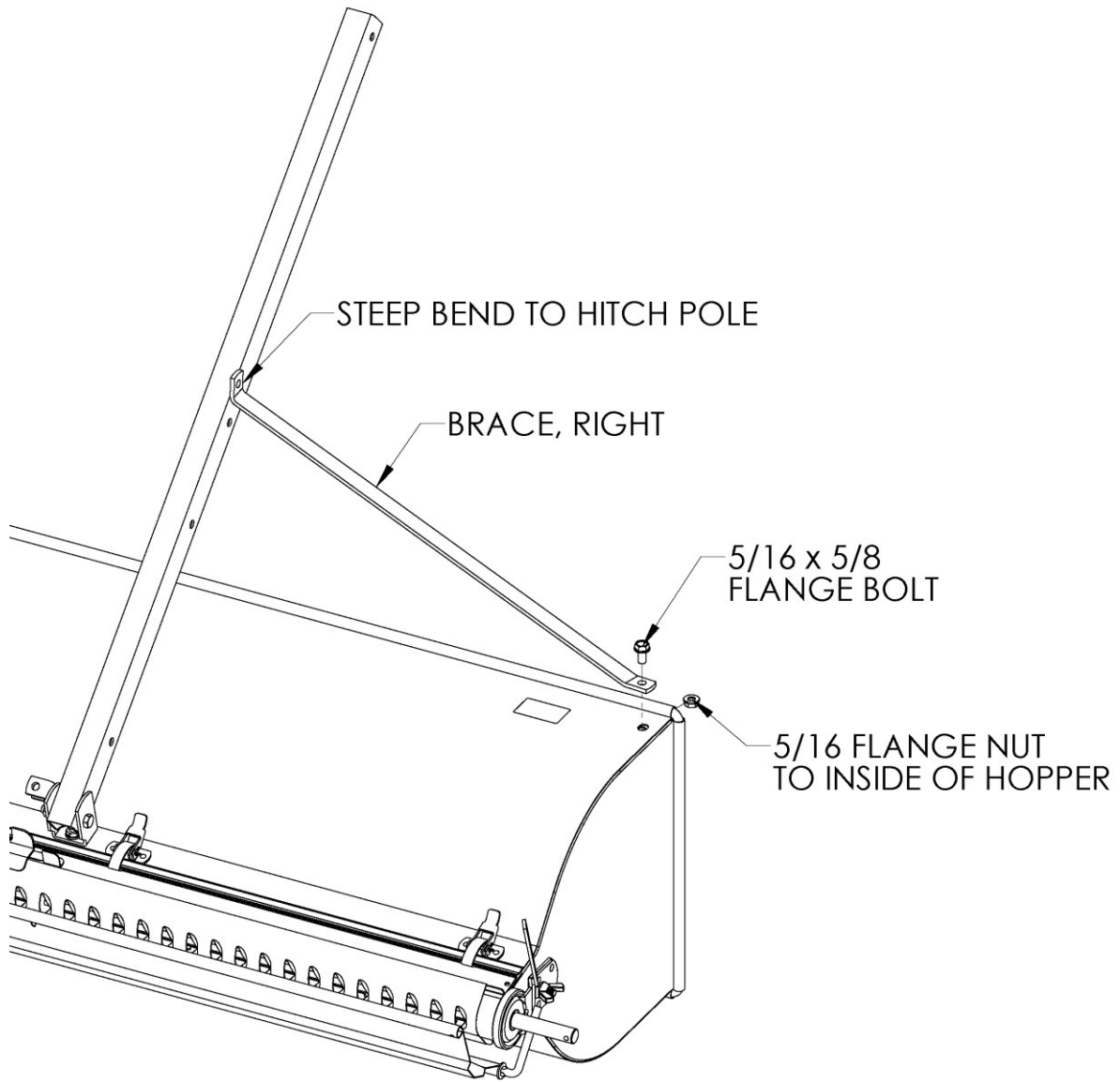

42H-A1 (2/6/25)

Push Handle Assembly Instructions

Step #4

Install the Stand (28427125-3) over the square hitch pole so the long end is as shown.

Using the 5/16 x 2-1/2 hex bolt slide the bolt through the brace, stand, hitch and out the other side.

Install a 5/16 flange nut to hold everything in place. Do not tighten, only screw the nut on a little way.

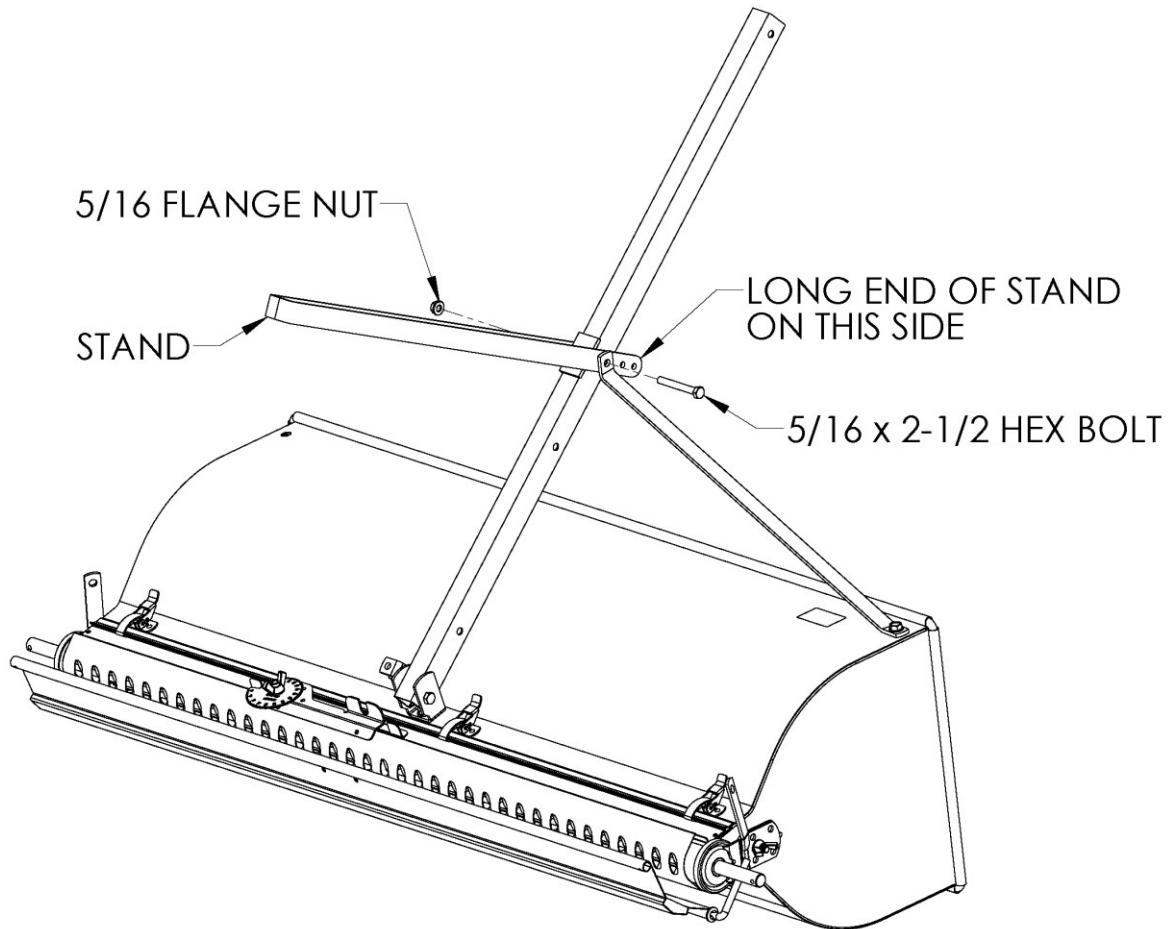

42H-A1 (2/6/25)

Push Handle Assembly Instructions

Step #6

Install the Left Brace (Part #28427125-1) to the hopper using the hardware shown.
Do not tighten leave bolt vary loose.

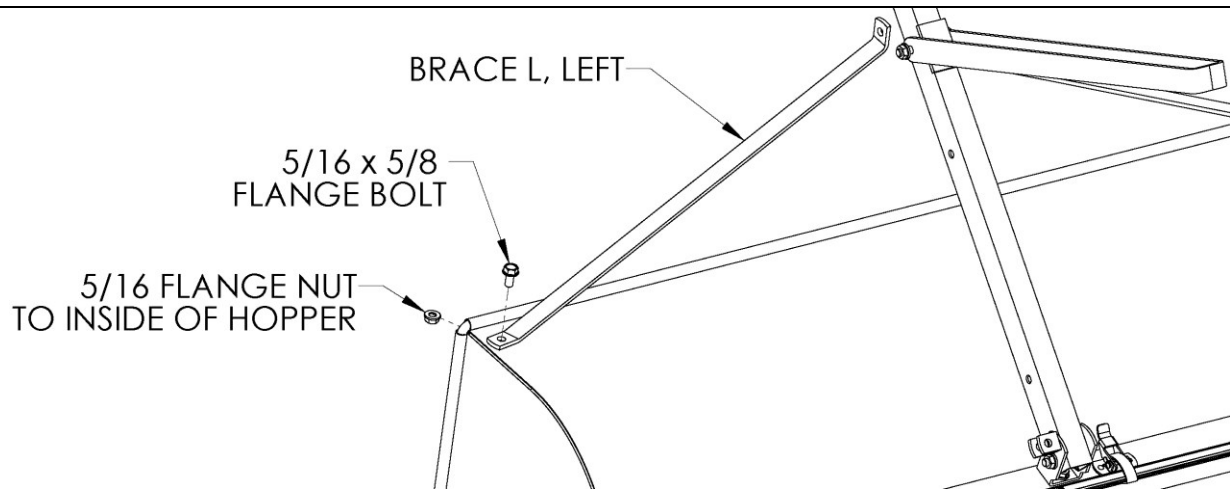

Step #7

Remove the 5/16 flange nut and attach the left brace to the 5/16 bolt that protrudes from the stand.
Note: You may have to slide the bolt out a little to align the left brace.
Then reinstall the 5/16 flange nut and securely tighten.
Then securely tight the 5/16 x 5/8 flange bolts on the braces. Then securely tighten bolt from step #3.

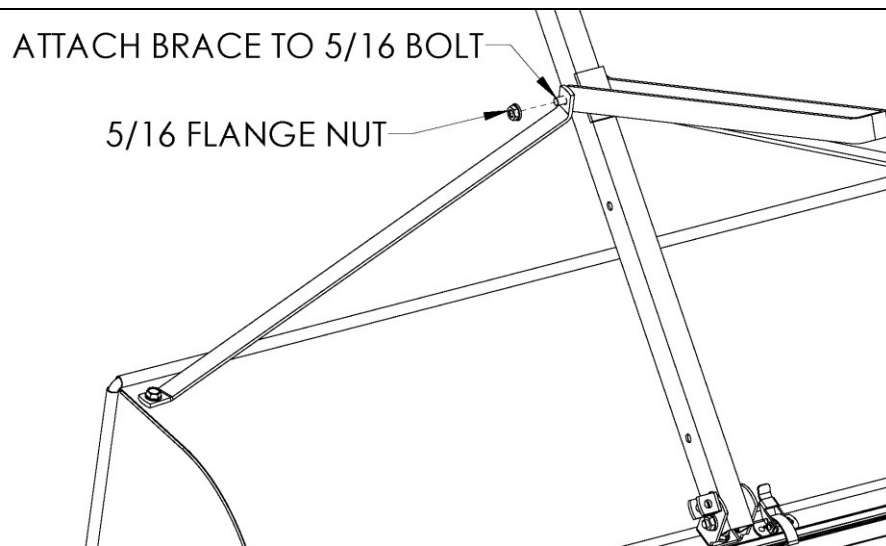

Push Handle Assembly Instructions

Step #8

Install the Shut-Off Pivot Arm (part #2899-4) to the pole clevis that was installed in step #1 as shown. Note the pin on the shut-off arm goes into the notch shown. Do not over tighten the bolt, pivot arm needs to turn freely.

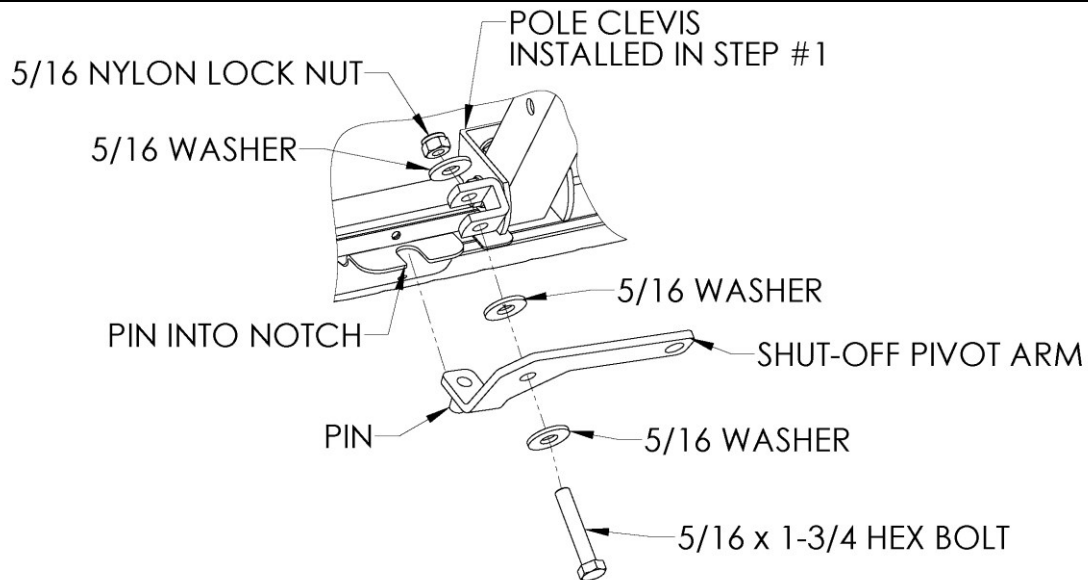

42H-A2 (2/6/25)

Step #9

Install the T-Handle (Part #28427225-4) to the end of the hitch pole as shown. Note only the center tab goes inside the square tube. Slide the 5/16 x 2" bolt through all parts and secure using a 5/16 flange nut. Tighten securely.

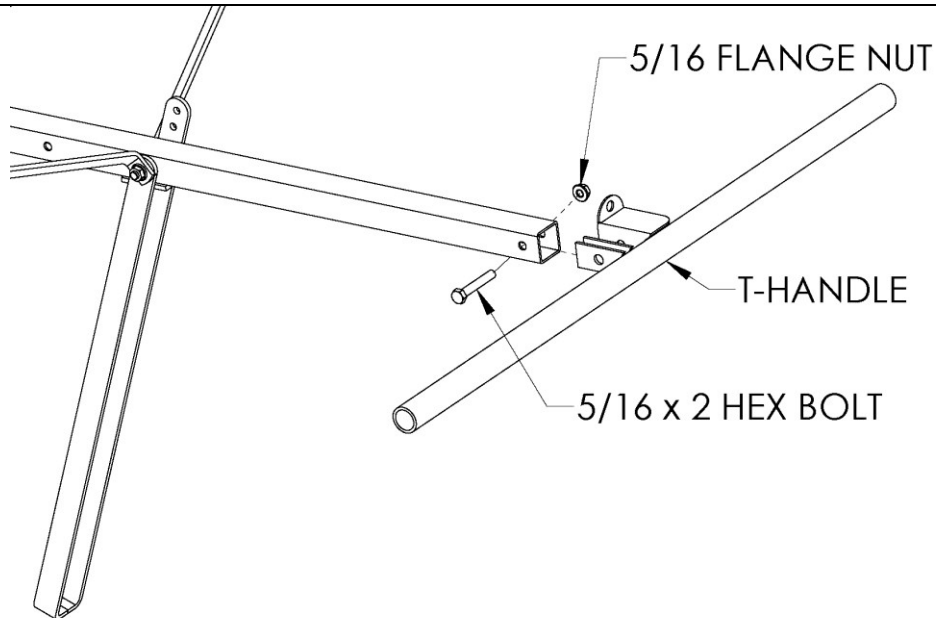

42H-A2 (2/6/25)

Push Handle Assembly Instructions

Step #10

Install the short end of the Shut-Off Lever (Part #2899-4) into the T-handle hole as shown and then rotate lever 90° to insert through hole.

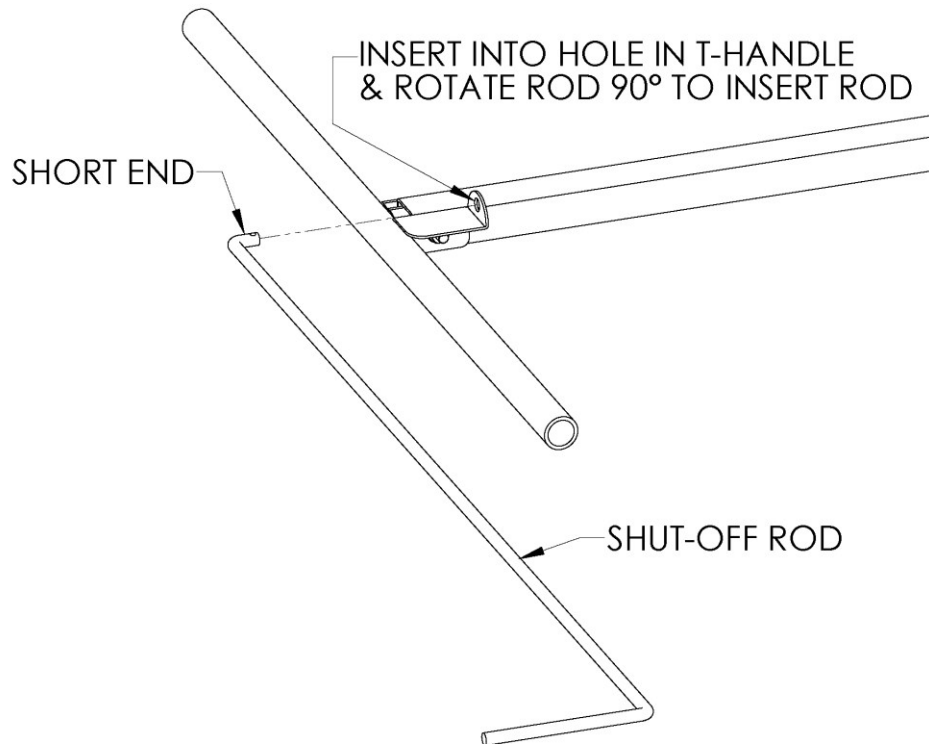

42H-A2 (2/6/25)

Step #11

With shut-off lever inserted slide lever towards hopper and under the right brace in all the way.

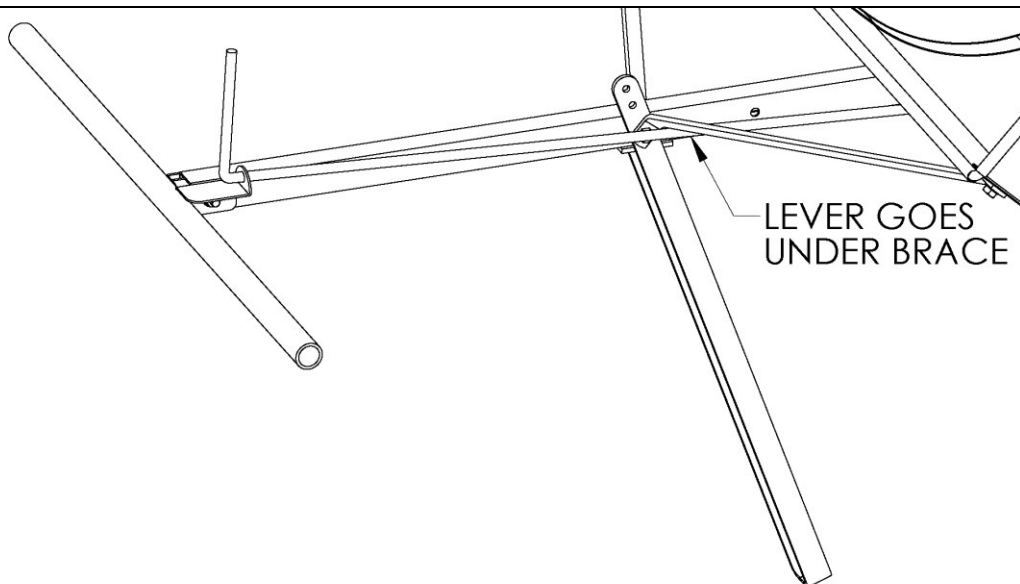

42H-A2 (2/6/25)

Push Handle Assembly Instructions

Step #12

Insert the short end of the shut-off lever into the hole in the end of the shut-off pivot arm.
Slide the 3/8 washer over the short end of the shut-off lever and install the cotter pin through hole.
Bend cotter pin to secure shut-off lever to pivot arm.

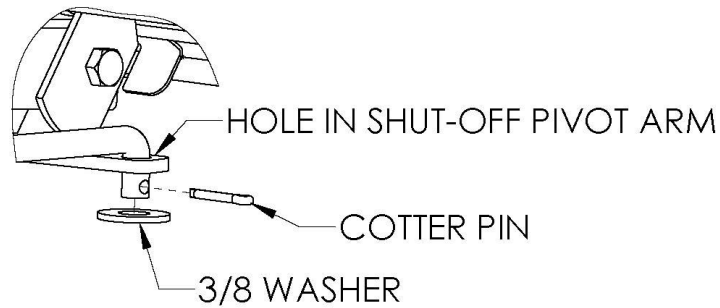

42H-A2 (2/6/25)

Step #12

Install the small grip on to the end of the shut-off lever.

Install the large grips on the ends of the t-handle.

Note:

A little water, soapy water, or window cleaner and rubber mallet (to tap on the grip) will help it slide on.

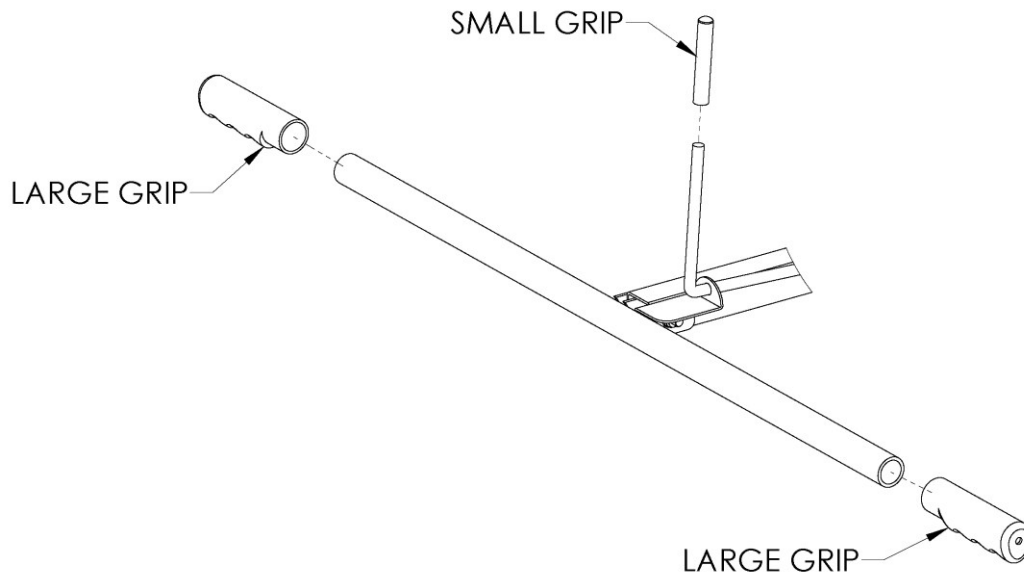

42H-A2 (2/6/25)

Go to Wheel Assembly Instructions to Finish Assembling.

Tow Hitch Package 42A-A Parts Break Down:
You would only have received this package if you ordered a 42T16 Spreader.

Item #	Part #	Description	Qty
1	2806915	Hitch Pole	1
2	2806916	Hitch Pin	1
3	28427117-1	Brace Left 42"	1
4	28427117-2	Brace Right 42"	1
5	2899-5	Shut-Off Lever (42" Spreader)	1
6	2899-7	Pole Clevis	1
7	42T-H	Hardware Bag (See Nex Page)	1
8	C03-0312-021	Whiz Flange Bolt (5/16 x 5/8) (in Place on Item #2)	2

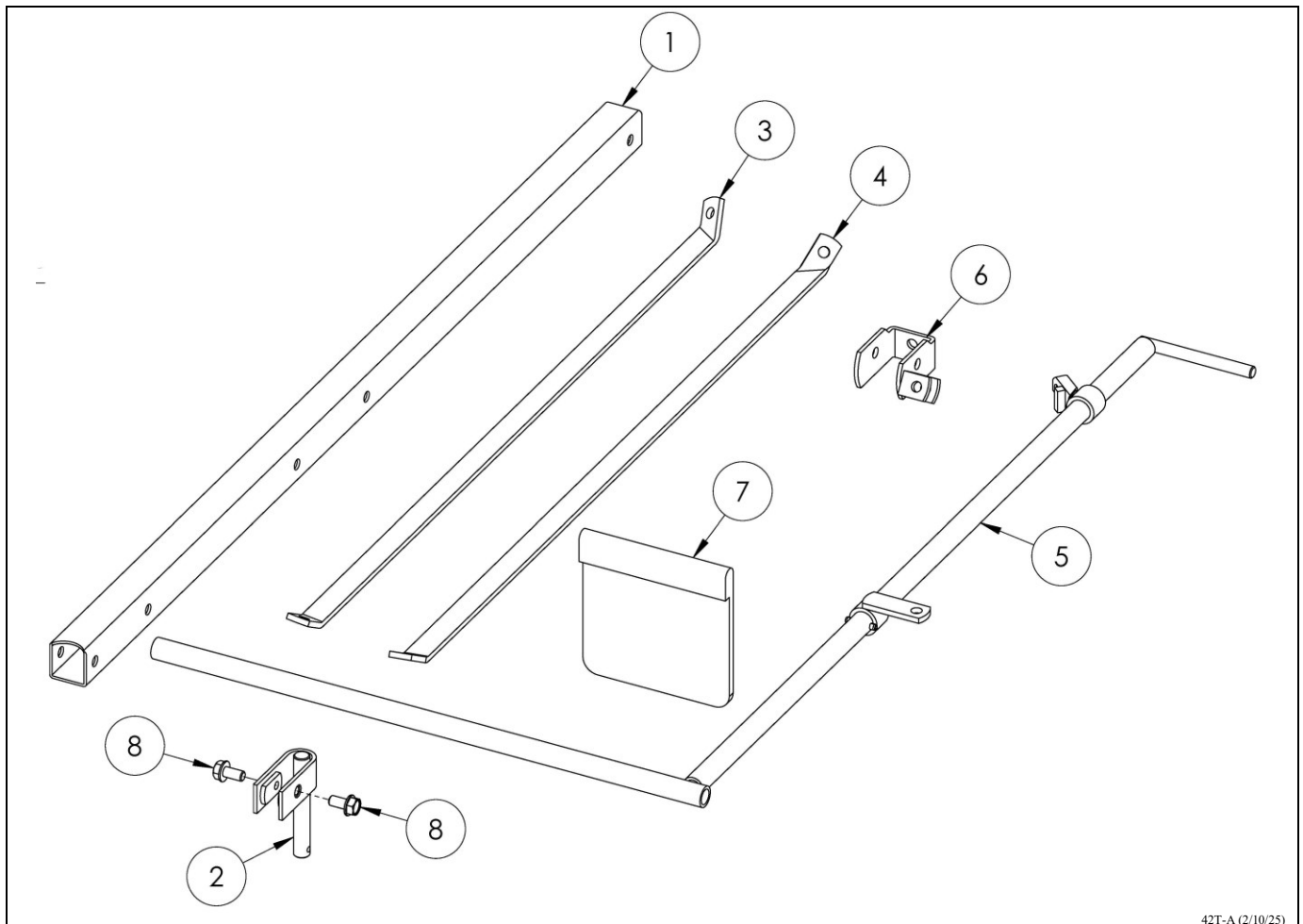

42T-A (2/10/25)

Hardware Bag 42T-H Containing the Following:

Item #	Part #	Description	Qty
1	C01-0312-030	Whiz Flange Nut (5/16)	5
2	C01-0312-040	Whiz Flange Bolt (5/16 x 5/8)	2
3	C03-0312-050	Hex Bolt (5/16 x 1-1/4)	1
4	C03-0312-050	Hex Bolt (5/16 x 2)	1
5	C03-0312-091	Hex Bolt (5/16 x 2-1/4)	1
6	C21-0177-020	Hairpin Cotter (.177 x 3-3/4)	1
7	J01-0625-450	Grip, Black (5/8 x 4-1/2)	1

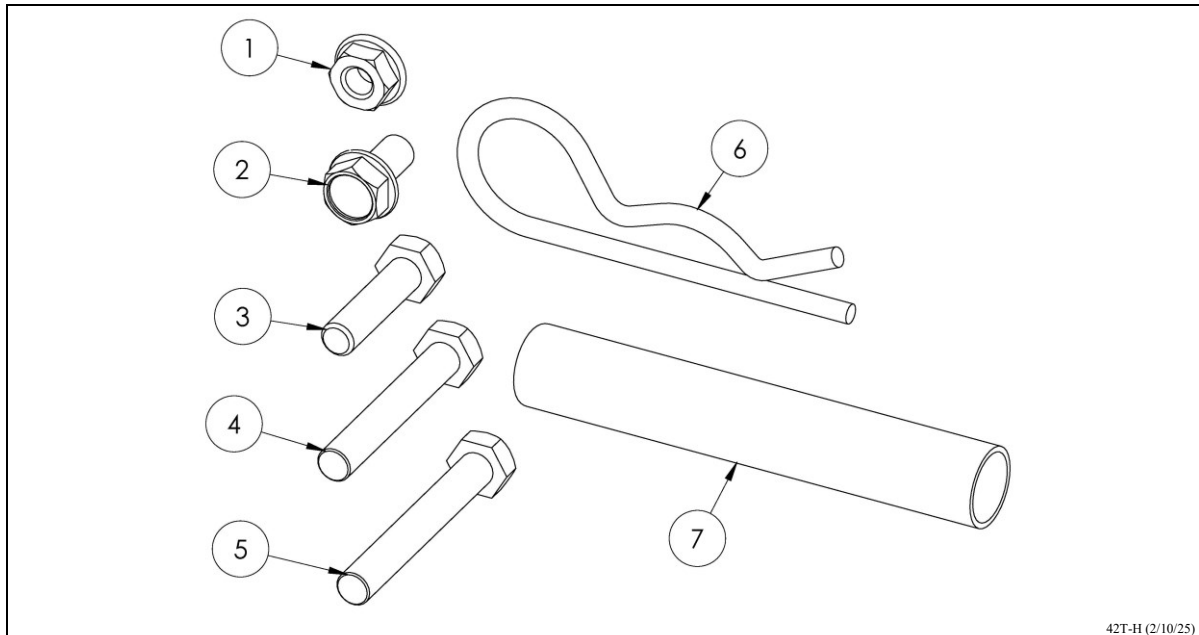

42T-H (2/10/25)

Tow Hitch Assembly Instructions

Step #1

Remove all parts & hardware from carton & hardware bag.

Note: Lay something down (piece of cardboard or a blanket) to protect hopper from being scratched.

Place hopper on its back so the cam gauge is facing up. As shown.

Remove the 5/16" flange nut from the stud above and to the right of the cam gauge.

Keep nut as it will be reused.

Next attach the Pole Clevis (part #2899-7) to the 5/16" stud & reuse the 5/16" flange nut. Tighten nut.

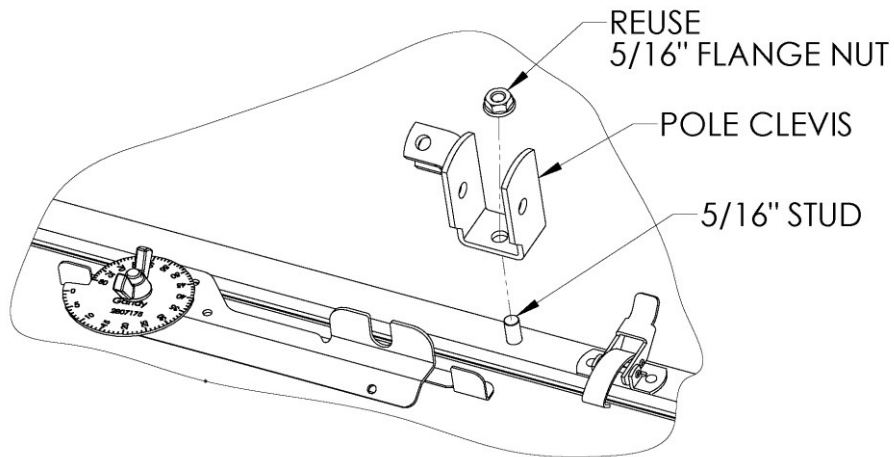
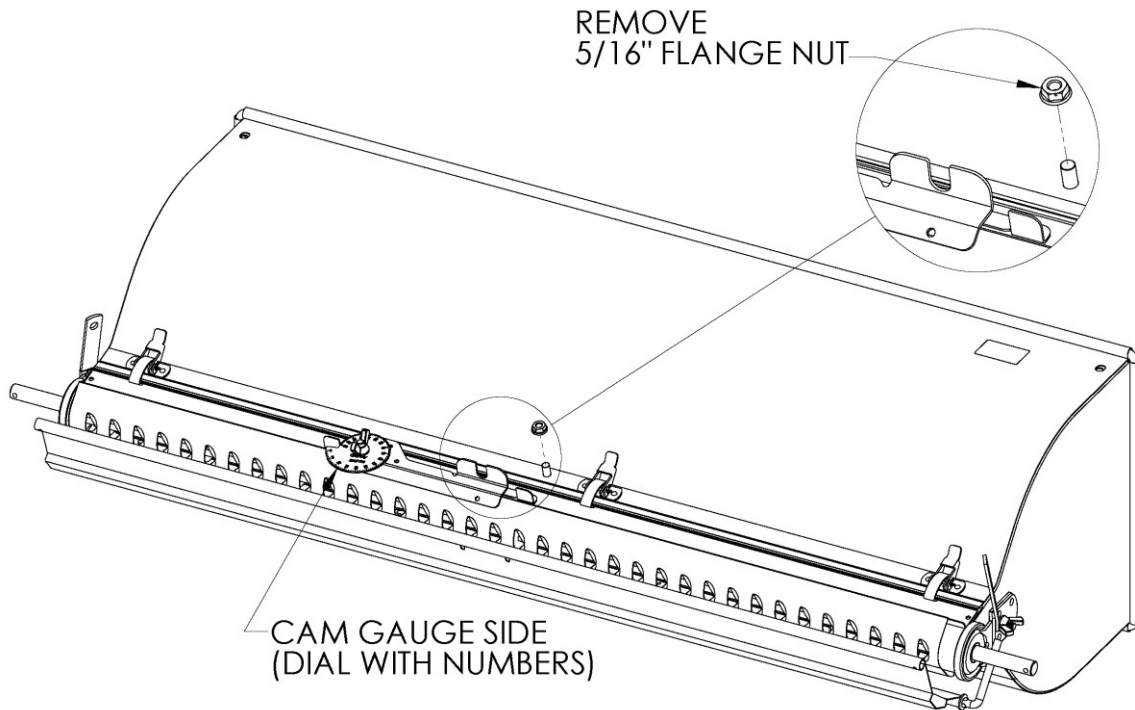

42T-A-1 (2/10/25)

Tow Hitch Assembly Instructions

Step #2

Install the Hitch Pole (Part #2806915) to the pole clevis as shown using the hardware shown. Do not tighten nut. Pivot the hitch towards the hopper until it touches the hopper.

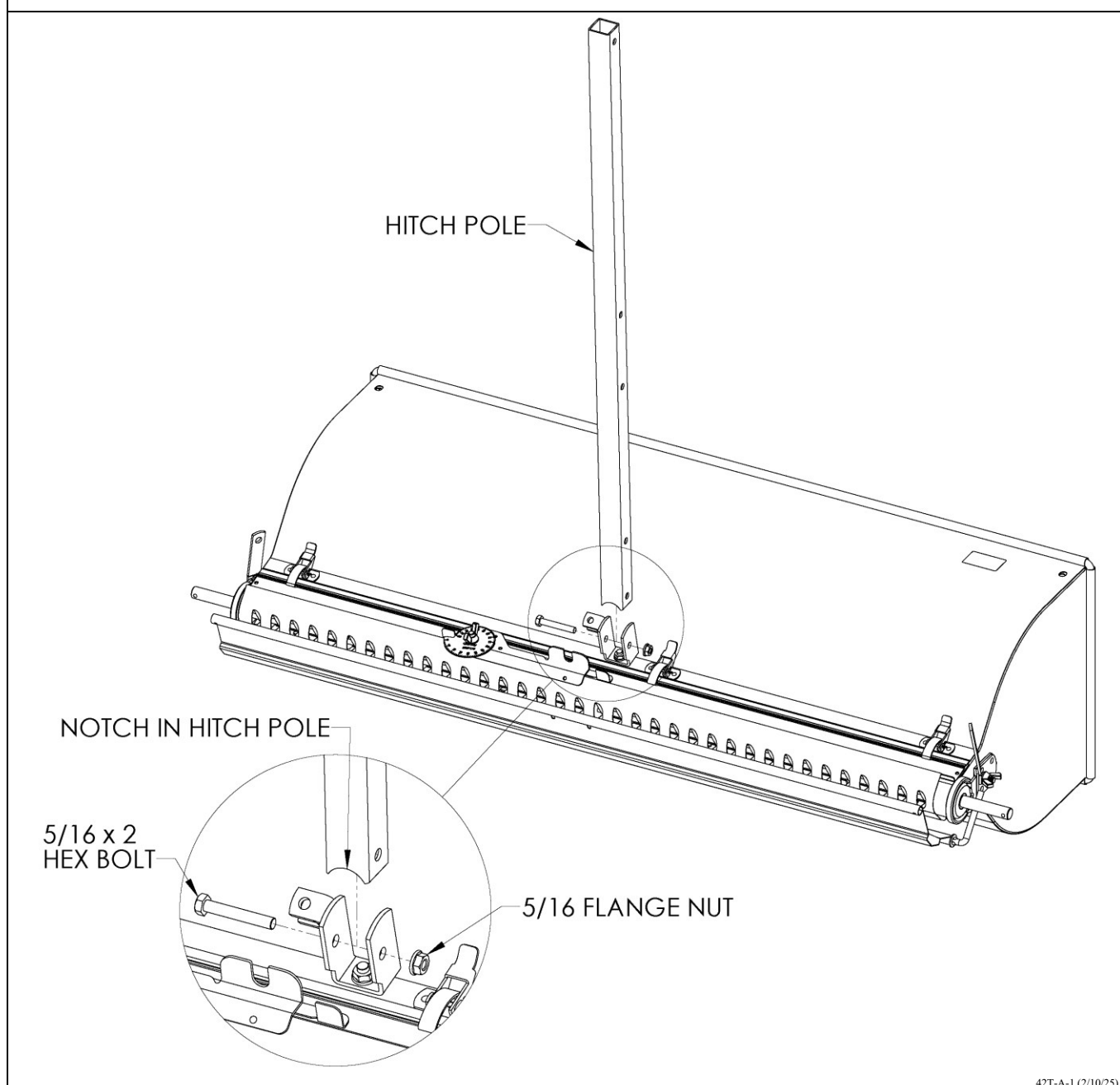

Tow Hitch Assembly Instructions

Step #3

Install the Left Brace (Part #28427125-1) to the hopper using the hardware shown.

Do not tighten leave bolt vary loose.

Then pivot the hitch pole up and using the hardware shown attach the brace the hitch pole.

Install a 5/16 flange nut to hold everything in place. Do not tighten. Screw nut on only finger tight.

This will hold the brace and hitch poles in place.

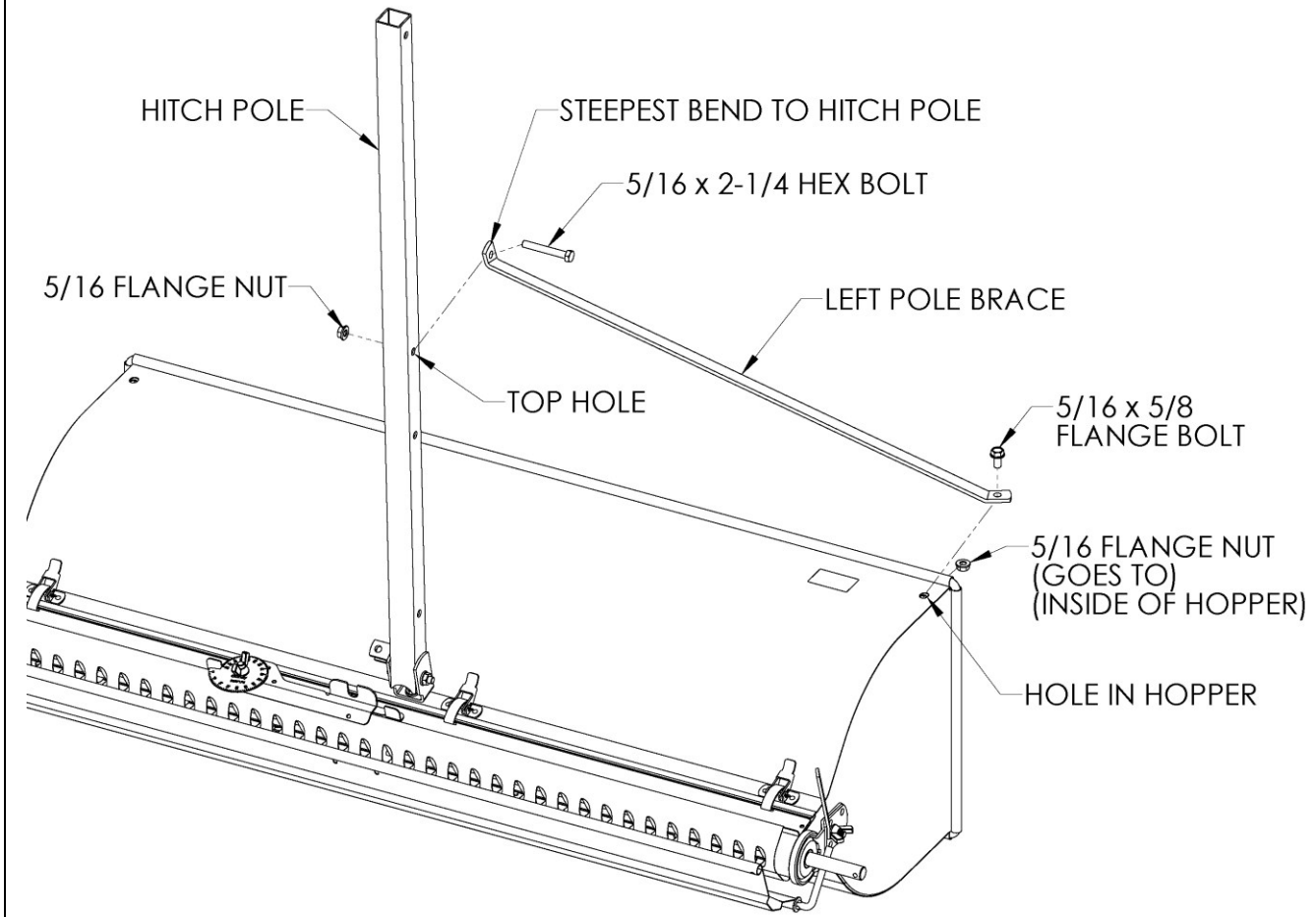

42T-A-1 (2/10/25)

Tow Hitch Assembly Instructions

Step #4

Install the Shut-Off Lever (2899-5) so the square tube shown goes into the U-Bracket as shown & the round pin goes into u-notch as show.

Then insert the 5/16 x 1-3/4 hex bolt through the u-bracket and shut-off lever tube and secure in place using the 5/16 flange nut. Do not tighten.

Next remove the 5/16 flange nut holding the brace to the hitch pole. With nut removed attach the Tab on the shut-off lever to the bolt holding the brace to the hitch pole and reinstall 5/16 flange nut.

Do not tighten. Screw nut on only finger tight. This will hold everything in place until the next the step.

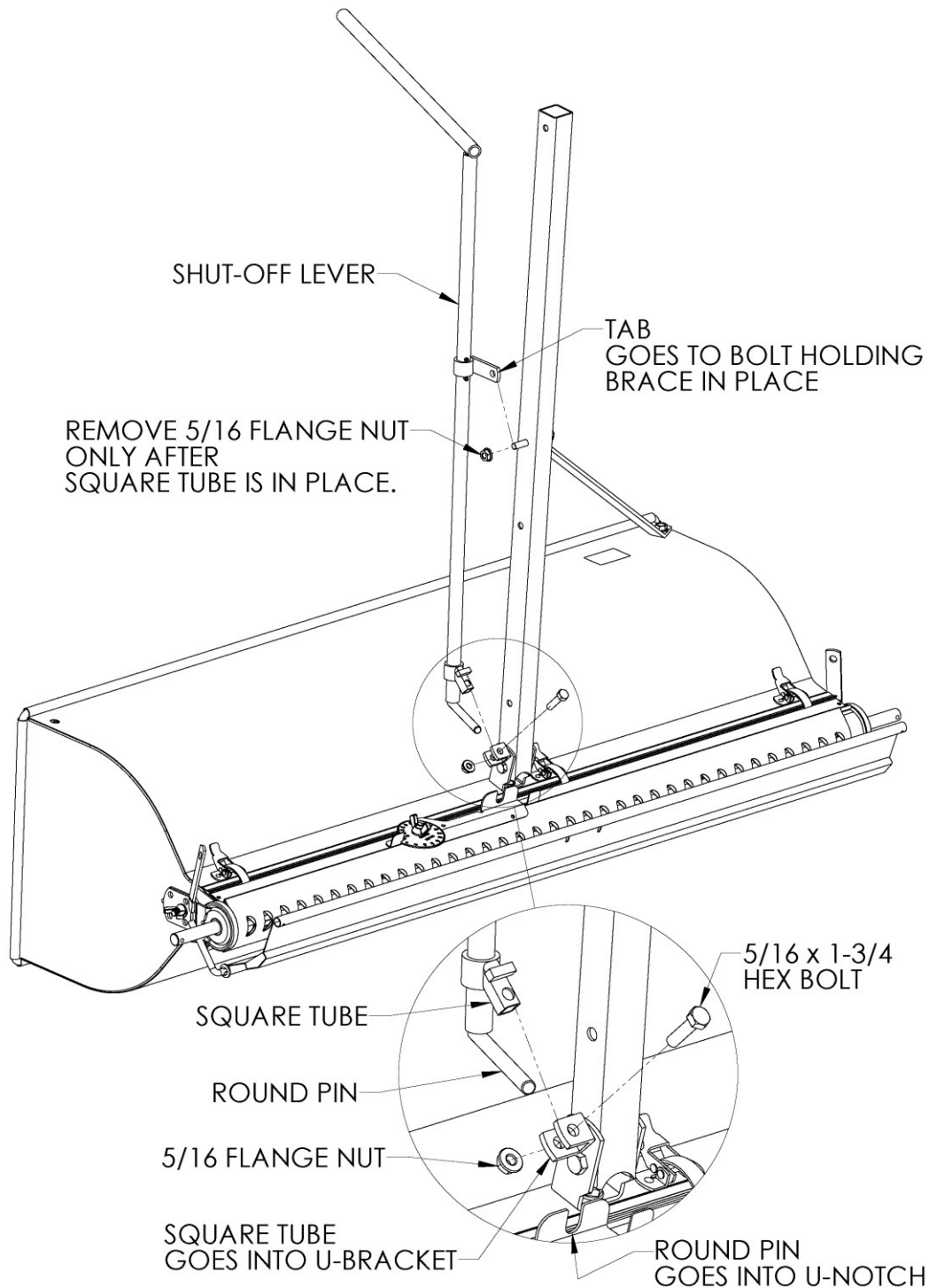

42T-A-1 (2/10/25)

Tow Hitch Assembly Instructions

Step #6

Install the Left Brace (Part #28427117-1) to the hopper using the hardware shown.

Do not tighten leave bolt vary loose.

Next remove the 5/16 flange nut on the bolt holding the right brace and shut-off lever to hitch pole.

Connect left brace to bolt shown and reuse the 5/16 flange nut. Securely tight this bolt.

Then securely the bolts on the left and right brace, the bolt from step #4.

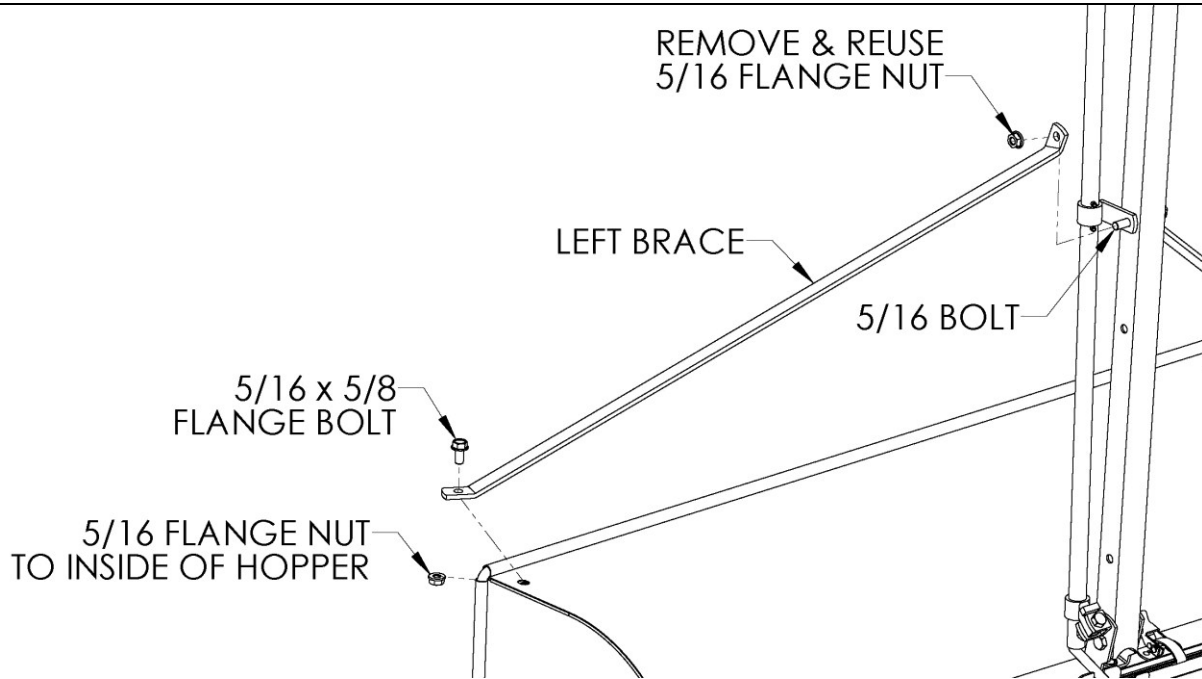

Tow Hitch Assembly Instructions

Step #7

Remove the two 5/16 flange bolts from the Hitch Pin (part #2806916).
Insert the Hitch Pin into the end of the Hitch Pole as shown.
Install the two 5/8 flange bolts to the hitch pole and hitch pin and securely tighten.
Next install the Hairpin Cotter to the hitch pin.

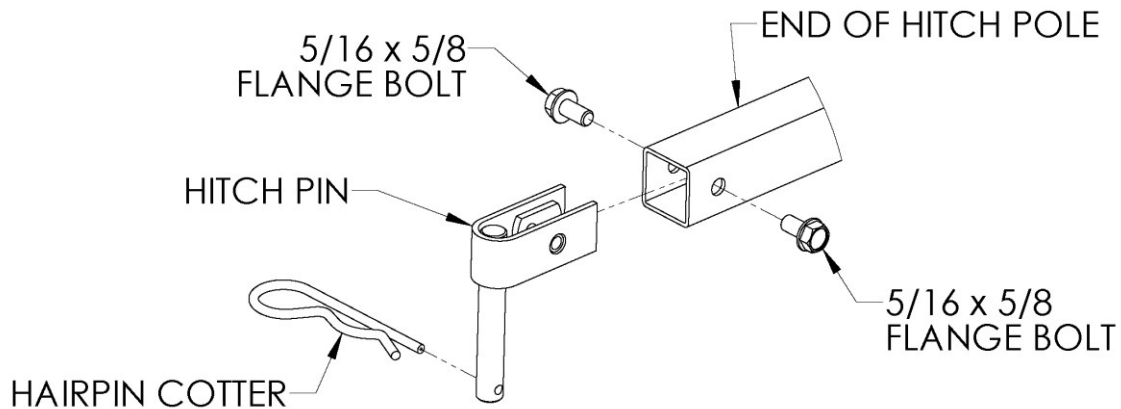

42T-A-1 (2/10/25)

Step #8

Install the grip on to the end of the shut-off lever.

Note:

A little water, soapy water, or window cleaner and rubber mallet (to tap on the grip) will help it slide on.

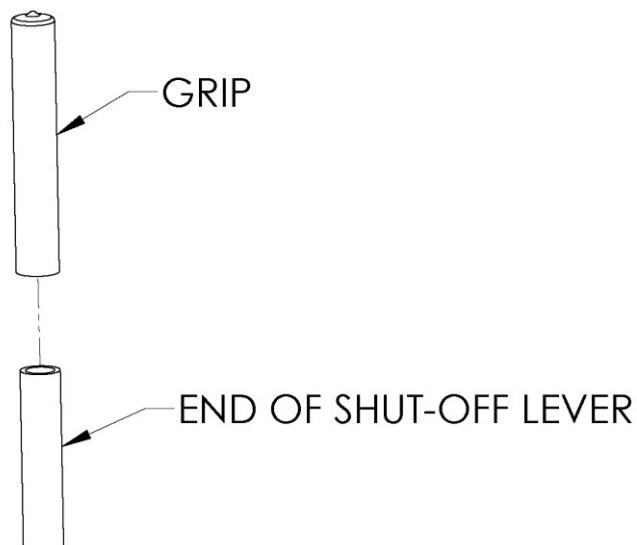

42T-A-1 (2/10/25)

Go to Wheel Assembly Instructions to Finish Assembling.

16" Tire Package 2816896 Parts Break Down:

One tire package come with either the 4216T-S (Tow Model) or 4216H-S (Push Model) Spreader.

One Carton Containing the Following:

- | | | |
|---------|-------------------|--|
| 2 | R02-0016-000..... | 16-inch Pneumatic Tire & Rim |
| 1 | 2816896-A..... | Hardware Bag Containing The following: |
| | Use: 2 | Wheel Adaptor (28427155-6) |
| | 2 | Spring Pin (3/16 x 1) (C23-0187-140) |
| | 2 | Clevis Pin (3/8 x 1-3/4) (C22-0375-100) |
| | 2 | Hairpin Cotter (.08 x 1-9/16) (C21-0072-020) |

Instlation Instructions:

- 1) First it is recommended to place some Anit-Seize or grease on the hopper shaft before assembling.
Slide Wheel Adaptor (Part #2827155-6) over shaft on end of 42" spreader.
Align the small hole with the hole on the end of the 42" shaft.
Tap the 3/16 x 1 Spring Pin through the wheel adaptor and shaft and make sure the spring pin dose not stick out past the adaptor or the tire will not slide freely over the adaptor.
- 2) Slide the Tire (Part #R02-0016-000) over the wheel adaptor just installed.
- 3) Turn the wheel on the adaptor to align the slot with the large hole on the adaptor.
Insert the Clevis Pin (Part #C22-0375-100) through the slot and hole in the wheel adaptor.
Secure the clevis pin in place using the Hairpin Cotter (Part #C21-072-020).
Repeat for other side.

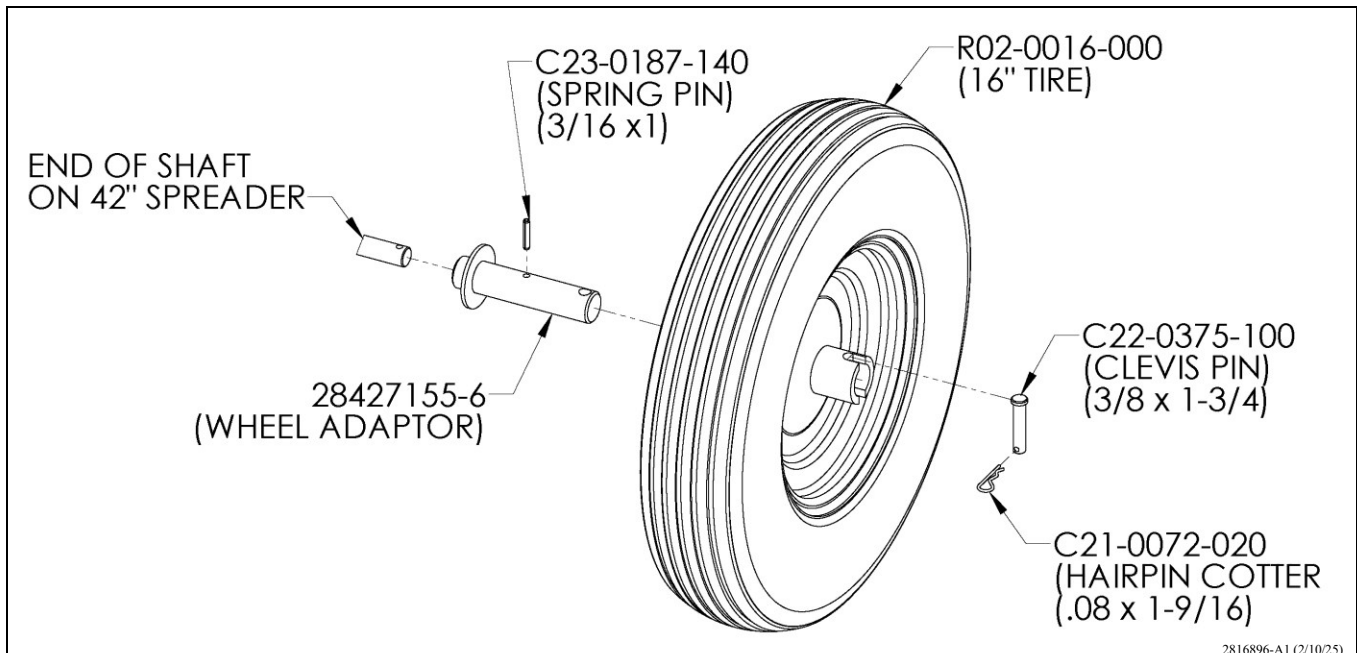

Maintenance & Cleaning for Gandy 42" Salt Inator®

General Maintenance:

Check all bolts for tightness periodically.

Always empty hopper when finished.

Never leave Salt for extended periods of time in the spreader as it can corrode and/or rust the parts.

Cleaning:

Always follow all safety guide lines listed on the product label of material used in spreader when cleaning.

SALT: It is recommended to do a more thorough cleaning.

(For detailed drawings see Parts & Assembly section at start of this booklet supplied with spreader)

1. With spreader empty turn spreader over so the bottom faces up.
2. Remove both tires.
3. Remove the spread plate by removing the wing nuts and washers holding the bearing retainers in place.
4. With the spread plate and bearing retainers removed, un-snap and un-hook the latches holding the stainless bottom in place. **Note:** There are 6 latches (3 each side).
With the latches un-hooked, grab the bottom on one end and pull straight up to remove the bottom.
5. Remove the bearings, rotor bars and end washers (on ends of rotor bar) from the spreader.
6. Wipe & clean all parts including spreader hopper. Clean all material out of the center and end bearings.
Note: See Bottom Disassembly instruction on next page.
7. After cleaning the bearings, place a few drops of light oil on the inside of each bearing.
Note: The bearings are porous and will absorb small amounts of oil.
Note: The center and end bearings do not turn. The shaft turns inside the bearing.
Some materials have fine powder in the mixture, so it may be necessary to oil the bearings more often to prevent powder from working into the bearings.

All parts need to be completely dry before reassembling.

8. Install end washers back on long ends of rotor bars.
Reassemble rotor bars and bearings back on spreader.
9. Reinstall and center the stainless bottom on the spreader making sure the cam gauge is on the handle/hitch side and the shut-off lever is in the U-notch.
Hook all the latches back onto the bottom and snap into place.
10. Reinstall tires.
11. Turn spreader upright on it tires and reconnect spread plate chain.
12. Open and close shut-off lever. If shut-off lever operates hard the bottom can be adjusted to operate easier. (Similarly to Step #6 in the bottom disassembly instructions)
From the side opposite the cam gauge loosen the 3/6" flange nuts. Un-snap the latches on this side only and tap the rear hanger to your right about 1/16" inch. Retighten 3/16" nuts, re-snap latches and try shut-off lever again. Repeat if needed until shut-off lever operates smoothly.

Bottom Disassembly Instructions:

Occasionally it will be necessary to disassemble the stainless bottom for cleaning.

Some materials will build up in between the slide and the bottom especially when atmospheric humidity is high.

1. Remove the 5/16" wing nut, washer and cam gauge from bottom assembly.

Diagram A

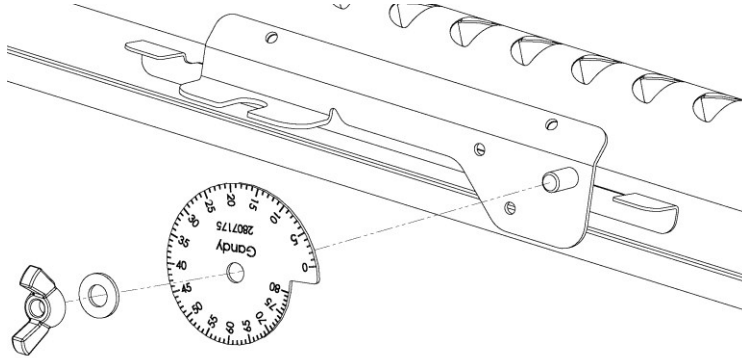

OPP-36-24-A1

2. Measure the distance from the edge of the bottom to the edge of the rear hanger and write that down.
See Diagram B. You will use this dimension to reassemble the bottom.

Diagram B

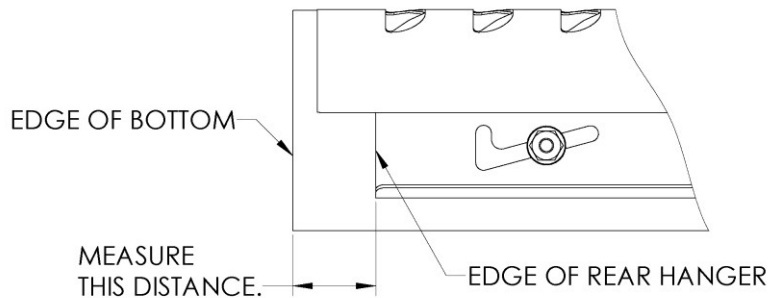

OPP-36-24-A1

3. Remove the 3/16" flange nuts and nylon washers from the rear hanger.

Note: The 36" bottom has 4 nuts and washers. The 24" bottom has 2.

Diagram C

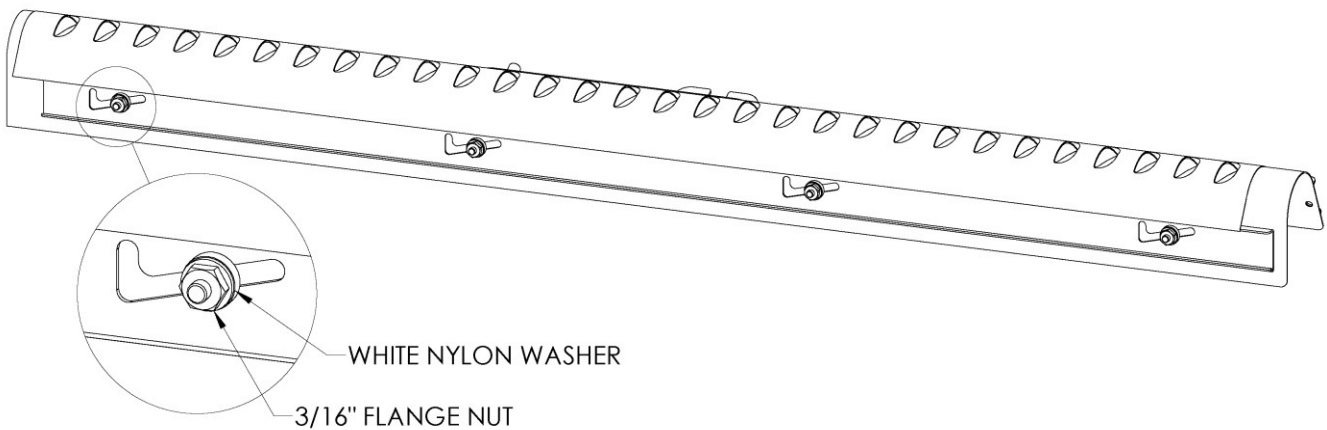

OPP-36-24-A1

4. With the nuts and washers removed you will see the angled slots on the rear hanger.

With a small hammer gently tap on the end of the rear hanger as shown to loosen it from the studs. See Diagram D.

With the hanger loose, slide it in the direction shown until the threaded studs align with the straight up and down area of the slot. See Diagram E.

Pivot the rear hanger away from the bottom and all the way off the studs.

This will allow the hanger to un-hook from the slide and be removed. See Diagram F.

Lift up and pivot the slide away from the bottom.

This will allow the side to unhook from the front hanger. See Diagram G.

Note: Be careful when handling the bottom & slide so you do not drop, bend, or dent it.

Diagram D

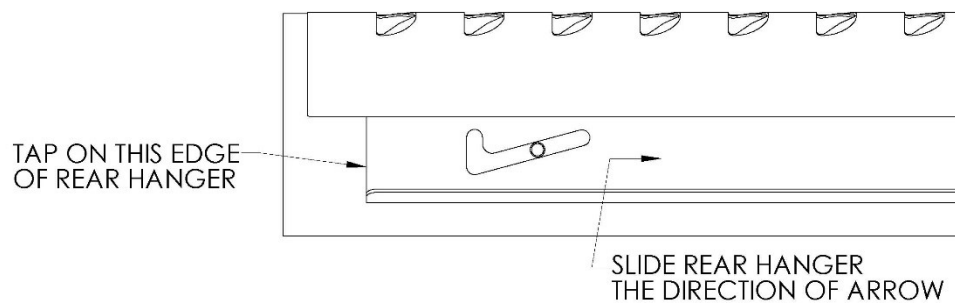

Diagram E

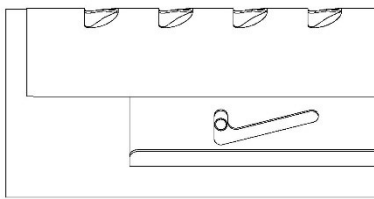

Diagram F

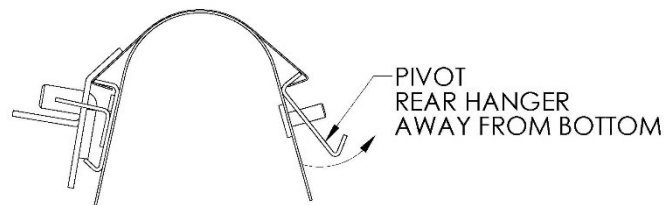
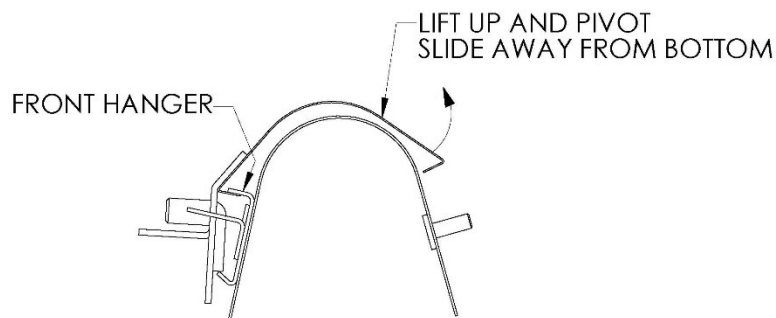

Diagram G



OPP-36-24-A1

5. **Note:** Be careful when handling the bottom & slide so you do not drop, bend, or dent it.
 With the bottom & slide disassembled wipe or wash these parts clean.
 If any rust or corrosion has formed on these parts it should be removed.
 (Fine steel wool or a fine scotch-bright pad & WD40 or similar products will work.)
 Make sure all parts are dry and all oil removed before reassembling.
 Do not oil or grease the bottom & slide. This will cause material to collect or stick in between the bottom & slide and cause it to slide harder and/or bind up.

6. Bottom reassembly.

Hook slide to the front hanger as shown in Diagram H and pivot onto bottom.

Hook rear hanger under lip of slide. Align the studs with straight up and down area of the slots on rear hanger and pivot into the bottom as shown in Diagram J.

With a small hammer gently tap on the end of the rear hanger as shown until the rear hanger matches the dimension you took from Step #4, Diagram D. See Diagram K.

Reinstall the nylon washers and 3/16" flange nuts to all studs. Be careful when tightening flange nut as to not over tighten and twist off.

Note: You should be able to move the slide by hand. If you cannot move the slide by hand loosen the 3/16" flange nuts and slightly tap the rear hanger the opposite direction as shown in Diagram K, tighten the 3/16" nuts and try to slide by hand again. Repeat this process if needed.

Reinstall the cam gauge, washer & wing nut.

Reassemble bottom on spreader.

Diagram H

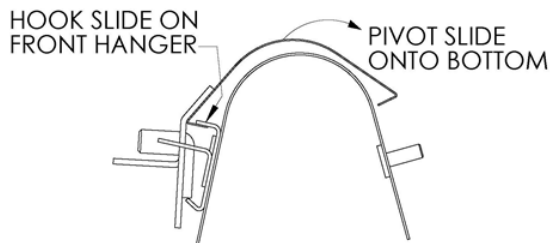

Diagram J

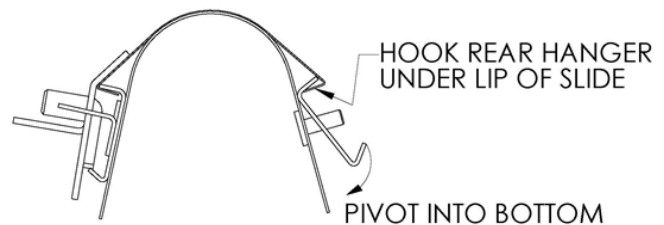
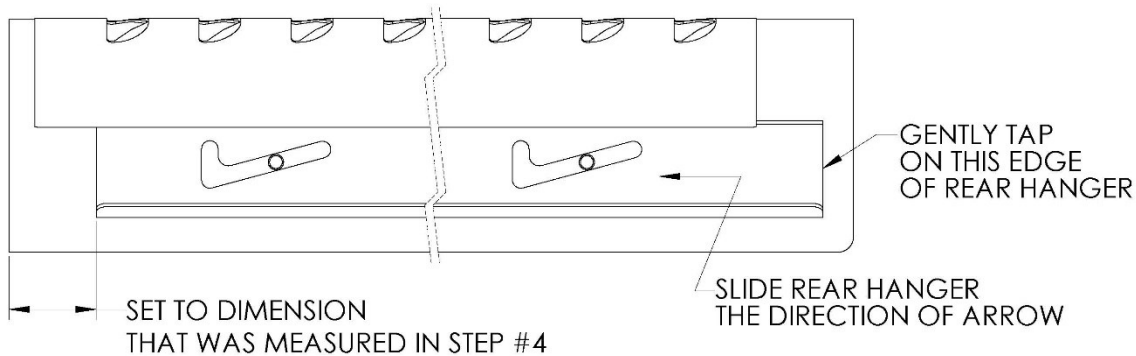

Diagram K



OPP-36-24-A1