



# Parts & Assembly Manual

815 Rice Lake Street, Owatonna, MN 55060

Phone: 800-443-2476 / 507-451 5430

www.gandy.net / Email: sales@gandy.net

## Salt Inator®

42PTH-S

42-inch Salt Spreader

For Use with #1 Free Flowing Rock Salt

With Spread Plate & Jigglers

12-volt Electric Motor Drive (2 Motors)

For Use With 3-Point Hitch Ordered Separately

### Cam Gauge Settings for Salt:

For first starting set the cam gauge at #65 per picture below.

If this does not apply enough salt adjust to a higher number and try again.

**Note:** Depending on the size of the salt you may have to adjust to setting #80.

#### Setting Cam Gauge:

Move cam gauge away from the stop (close bottom openings) before attempting adjustment.

Loosen wing nut and turn cam gauge to desired number, using the top surface of the stop as the setting indicator and then tighten wing nut. See picture of cam gauge set at "65".

For example, if the spreader is to be used with the bottom completely open, the cam gauge would be turned until the graduating mark directly opposite the number 80 is in line with the top edge of the stop.

Likewise, if the spreader were to be half open, the graduation mark opposite the number 40 would be in line with the top edge of the stop.

**Note:** Numbers on the cam gauge DO NOT represent any application rate, they are reference numbers only for setting repeatability.



### Handle Top Shut-Off Assembly:

Top Shutoff Handle (part #284210-4) is shipped tr-raped to the tool bar with hardware in place.

Remove handle and attach to the shut-off lever installed on the hopper using the hardware show and securely tighten hardware.

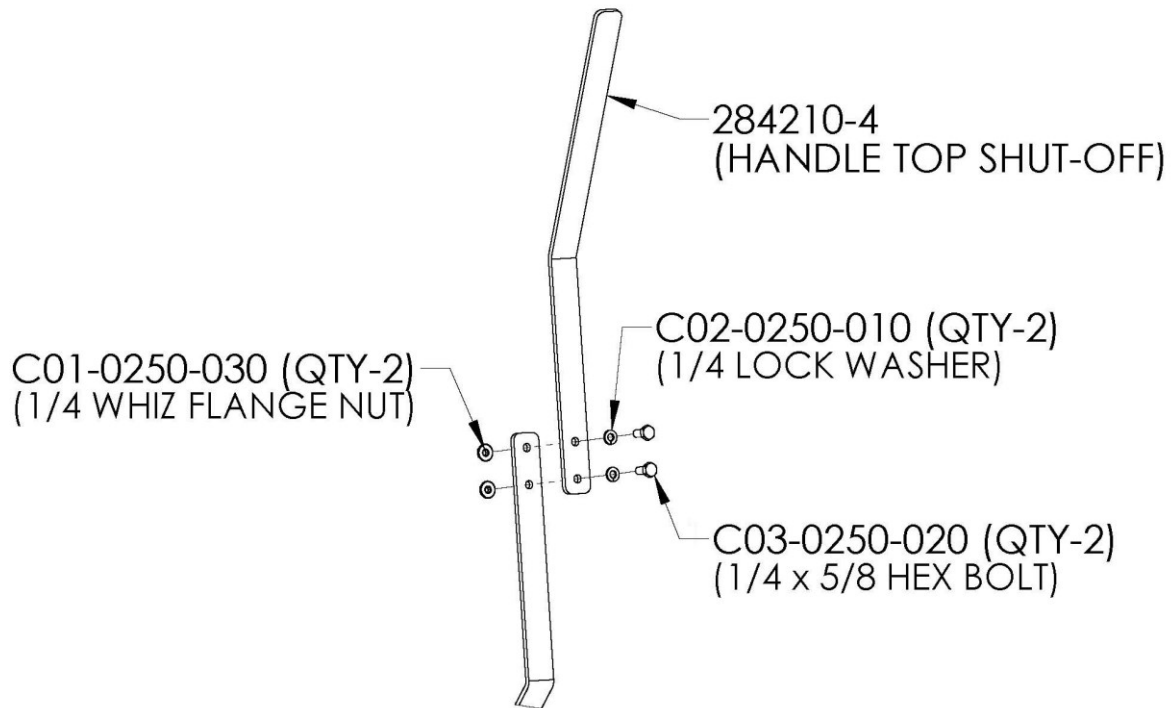

2842PTH (1/28/25)

## **Wiring / Mounting Instructions for Console:**

- 1) After mounting find a convergent location to mount the console.
- 2) Connect Power & Ground Wire (ring terminals) directly to a 12-volt power source.  
Direct to a battery is best. White (+) & Black (-). See next page for connections.
- 3) Connect supplied wires back to the left & right 12-volt motors. See next page for connections.
- 4) Console operation.  
The center switch is the master power switch.  
When this switch is turned on the amber light will light up to indicate main power is turned on.  
Only when the center switch is on will the Left & Right switch.  
  
When the Left switch is on the green light above the switch will turn on to indicate motor is on.  
When the Right switch is on the green light above the switch will turn on to indicate motor is on.  
  
Operation:  
You can control the left or right flow independently.  
Or by turning the center switch off to shut both Left & Right at the same time.

## Wiring Connections:

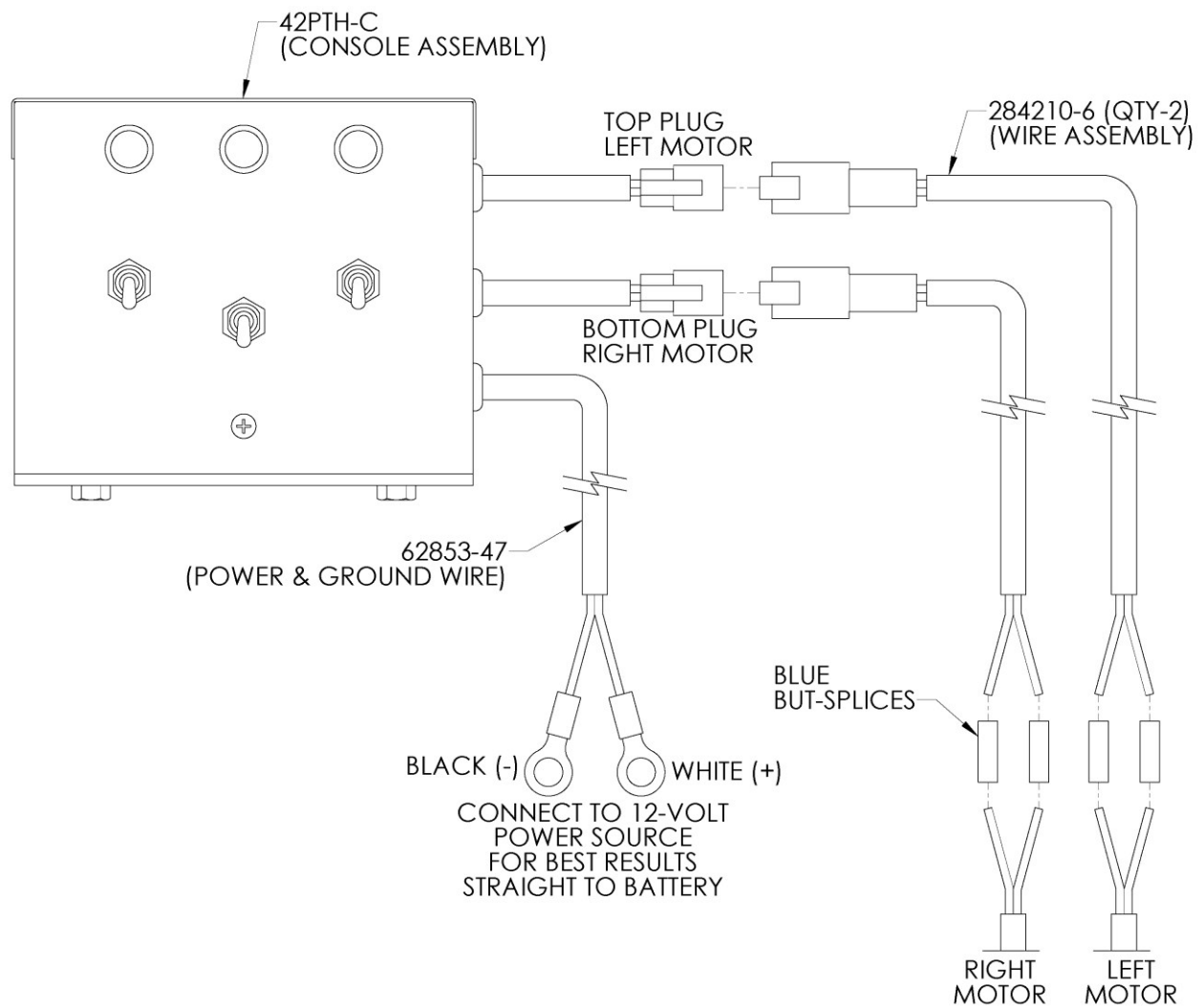

2842PTH (1/28/25)

## Shipped Assembled in Crate:

### The following Top Shut-Off Handle Wrapped and Ty-Raped to Tool Bar:

1 .....	284210-4.....	Handle Top Shut-off (shipped unassembled in Hopper)
	Use:	2 Hex Bolt (1/4 x 5/8) (C03-0250-020) (In Place)
		2 Lock Washer (1/4) (C02-0250-010) (In Place)
		2 Whiz Flange Nut (1/4) (C01-0250-030) (In Place)
1 .....	S02-0001-136 .....	Shipping Crate for 2842PTH
1 .....	2842W-LG .....	Hopper, 42-inch (w/ Mounting Holes) Painted Grey
	Use:	6 Latches (280692)
		12 Rivet (4/16 R-3805) (C17-0250-050)
		2 Decal, Salt Inator (N02-0001-131)
		2 Decal, Gandy Diamond (4 x 7-1/2) (N02-0001-093)
		1 Decal, Conversion Chart (N02-0028-005)
		1 Decal, Small USA (N02-0001-130)
		2 Decal, Caution Moving Parts (N02-0014-010)
1 .....	2807953 .....	Center Bearing
	Use:	1 Whiz Flange Nut (5/16) (C01-0312-030)
		1 Hex Bolt Self-Tapping (5/16 x 1) (C03-0312-042)
1 .....	2808942-7 .....	Bottom Assembly Variable Rate (For 42-Inch Hopper)
	Use:	4 Nylon Grip Washer (1/4) (C02-0250-011)
		4 Whiz Flange Nut (3/16) (C01-0187-030)
		1 Slide Hanger (28426912)
		1 SAE Washer (5/16) (C02-0312-020)
		1 Wing Nut (5/16) (C01-0312-020)
		1 Cam Gauge (2807175)
2 .....	090633-C1 .....	End Bearing
2 .....	28427155 .....	Rotor Bar, Tri-Rod (For 42-inch Hopper)
2 .....	2807156 .....	End Washer
1 .....	2807154-1 .....	Retainer, Bearing Left (w/ Rod)
	Use:	1 Wrought Washer (5/16) (C02-0312-030)
		1 Hex Nut (5/16) (C01-0312-010)
1 .....	2807154-2 .....	Retainer, Bearing Right (w/Rod)
	Use:	1 Wrought Washer (5/16) (C02-0312-030)
		1 Hex Nut (5/16) (C01-0312-010)
1 .....	2808942-1 .....	Spread Plate (For 42-inch Hopper)
	Use:	2 Wrought Washer (5/16) (C02-0312-030)
		1 Sash Chain #50 (14-Links) (F02-0050-014)
		2 Hairpin Cotter (1/8 x 1-15/16) (C22-0125-020)

- 1..... 284210-1.....Bracket Left Shut-Off
- 1..... 287210-2.....Bracket Center Shut-off
- Use: 4 Hex Bolt (1/4 x 5/8) (C03-0250-020)
- 4 Lock Washer (1/4) (C02-0250-010)
- 4 Whiz Flange Nut (1/4) (C01-0250-030)
- 1..... 284210-3.....Bracket Right Shut-Off
- Use: 1 Hex Bolt Bolt (5/16 x 3/4) (C03-0312-031)
- 1 Lock Washer (5/16) 9C02-0312-010)
- 1 Whiz Flange Nut (5/16) (C01-0312-030)
- 1..... 284210-5.....Shut Off-Lever
- Use: 1 Hex Bolt (3/8 x 1) (C03-0375-041)
- 3 Wrought Washer (3/8) (C02-0375-030)
- 1 Nylon Lock Nut (3/8) (C01-0375-041)
- 
- 1..... 09067249-45 .....Tool Bar (45-inch Long)
- 2..... 2891-5.....Sled Leg
- Use: 4 Hex Bolt (3/8 x 3-1/2) (C03-0375-142)
- 4 Wrought Washer (3/8) (C02-0375-030)
- 4 Lock Washer (3/8) (C02-0375-010)
- 4 Hex Nut (3/8) (C01-0375-010)
- 1..... 09080811-1 .....Hopper Mounting Bracket, Left
- Use: 2 Hex Bolt (5/16 x 1) (C03-0312-041)
- 2 Wrought Washer (5/16) (C02-0312-030)
- 2 Lock Washer (5/16) (C02-05/16-010)
- 1..... 2891-6.....Hopper Mounting Bracket, Right
- Use: 2 Hex Bolt (5/16 x 1) (C03-0312-041)
- 3 Wrought Washer (5/16) (C02-0312-030)
- 3 Lock Washer (5/16) (C02-05/16-010)
- 1 Carriage Bolt (5/16 x 3/4) (C04-0312-030)
- 1 Hex Nut (5/16) (C01-0312-010)
- 
- 2..... 2842PTH-EM.....Electric Motor Assembly w/Mount, 12 Volt, 1/32 HP, 6 AMP
- Each Assembly Uses the Following Parts:
- Use: 1 Elec 12-V Motor, 1/32 hp, 6 AMP (09082842-4)
- 1 Electric Motor Mount (09077589-3)
- 1 Supper Flange Nut (1/4-28) (C01-0250-031)
- 1 Drive Sprocket 8-Tooth (G01-0008-010)
- 3 Pan HD Mach Screw (1/4-28 x 1/2) (C07-0250-070)
- 3 Shake Proof Washer (1/4) (C02-0250-040)
- 1 Decal EM Caution (N02-0009-052)
- 2 Whiz Flange Nut (1/4) (C01-0250-030)
- 1 S-Hook (#63) (M11-0062-000)
- 1 Ty Rap w/ Eye (1/8 x 5) (L04-0002-000)
- 
- 2..... F02-0041-044 .....Roller Chain #41 (44-Link Complete)
- 2..... 5808416.....Sprocket, 32-Tooth
- Use: 2 Cotter Pin (3/16 x 1-1/4) (C20-0187-030)
- 2..... 09077589-22 .....Chain Guard, Electric Motor

- 1.....42PTH-C.....Console Assembly: (All Parts Assembled Unless Otherwise Specified)**
- 1 ..... 5508338-23 ..... Enclosed Console, Front
  - 2 ..... 5508338-24 ..... Enclosed Console, Back
    - Use: 4 Pn Hd Sheet Screw (#10-16 x 5/16) (C07-0187-040)
    - 2 Hex Bolt (1/4 x 3/4) (C03-0250-030)
    - 2 Whiz Flange Nut (1/4) (C01-0250-030)
  - 1 ..... C07-0164-080 ..... Phillips Pan Head Mach Screw (#6-32 x 5/8)
  - 2 ..... C01-0164-040 ..... Kep Nut (#8-32)
  - 3 ..... M05-2858-000 ..... Rubber Grommet (3/8 I.D.)
  - 1 ..... J03-0250-010 ..... Hole Plug (1/4)
  - 3 ..... J03-0375-010 ..... Hole Plug (3/8)
  - 1 ..... J03-0625-000 ..... Hole Plug (5/8)
  - 6" ..... L02-0014-020 ..... Jumper Wire Blue (14Ga x 6") (Qty-2 Pcs.)
  - 10 ..... L03-0002-000 ..... Blue Fork Terminals (16-14ga)
  - 1 ..... L05-0008-000 ..... Amber Light
  - 2 ..... L05-0008-020 ..... Green Light
  - 3 ..... L05-0001-050 ..... Switch, Toggle, On\Off (#90-001)
  - 2 ..... 284210-7 ..... Wire 12" Power Out (14ga)
  - 1 ..... 62853-47 ..... Power & Ground Wire Assembly
  - 2 ..... 284210-6 ..... Wire Power to Electric Motors (10-Foot x 14 Ga.)
  - 2 ..... L03-0007-000 ..... Blue But-Splice (16-14Ga) (in Plastic Bag) (For connecting to motors)

## 42" Hopper Assembly Schematic

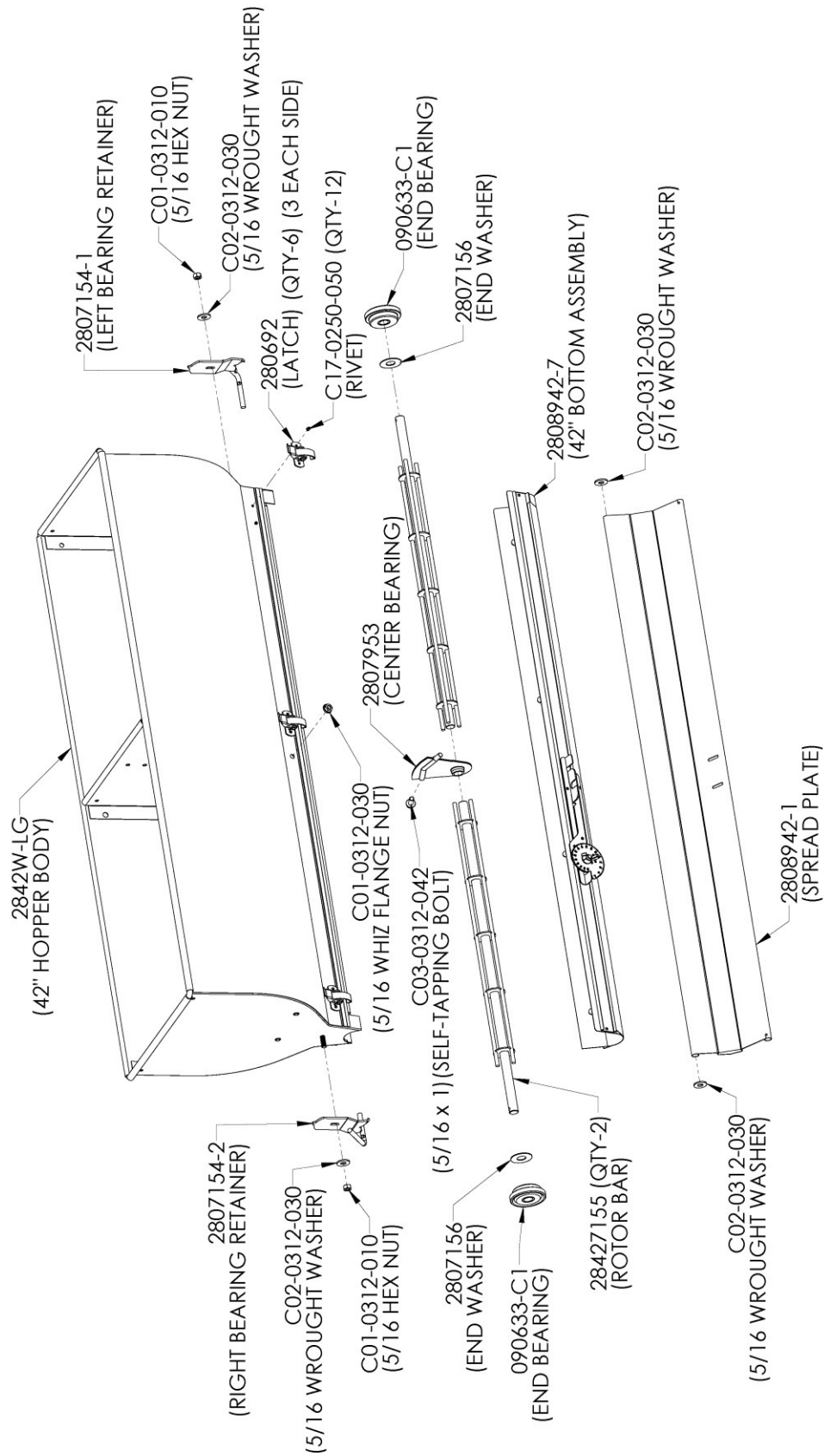

2842PTH (1/28/25)



## Shut-Off Handle Assembly

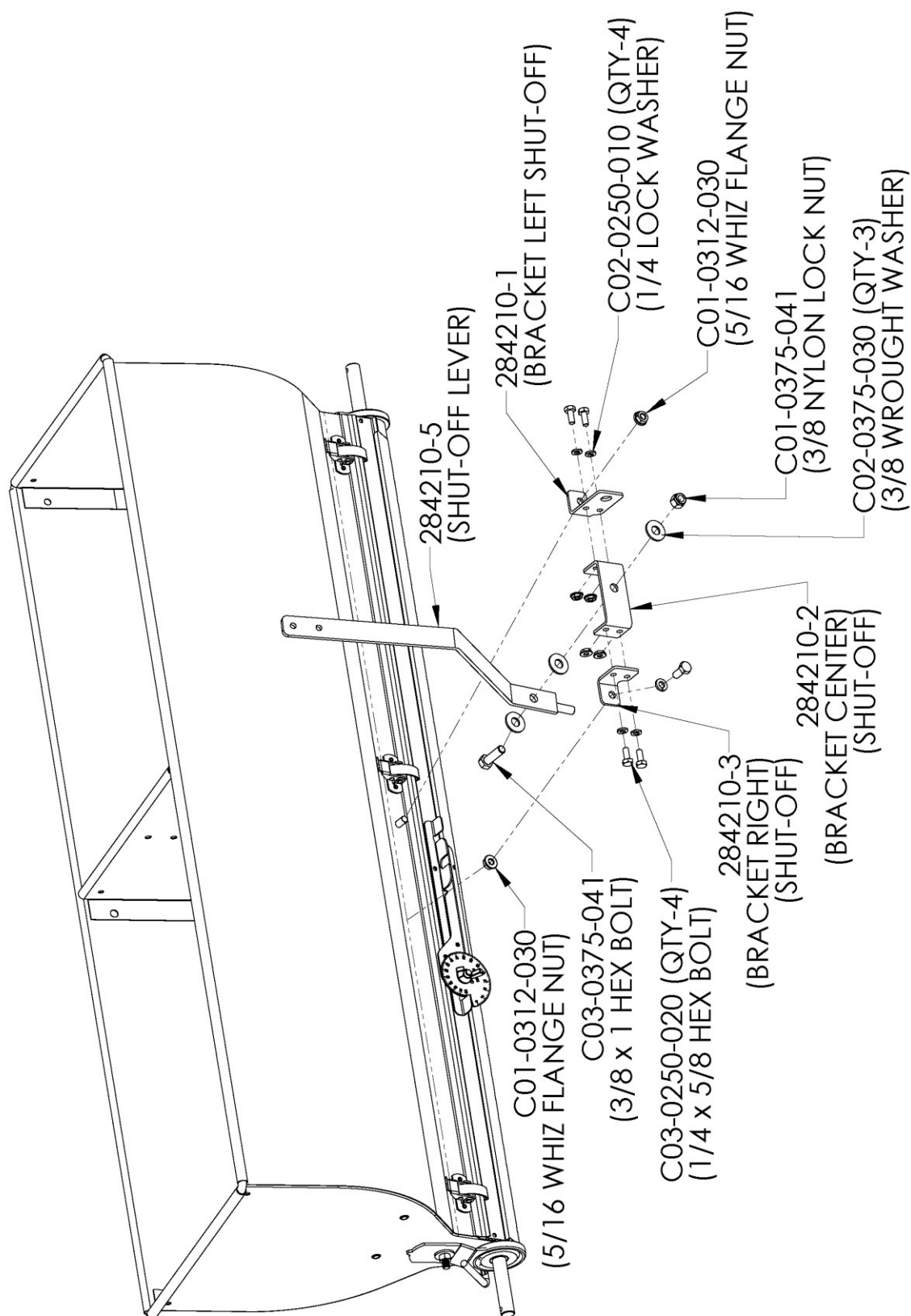

2842PTH (1/28/25)

## Left Side Mount

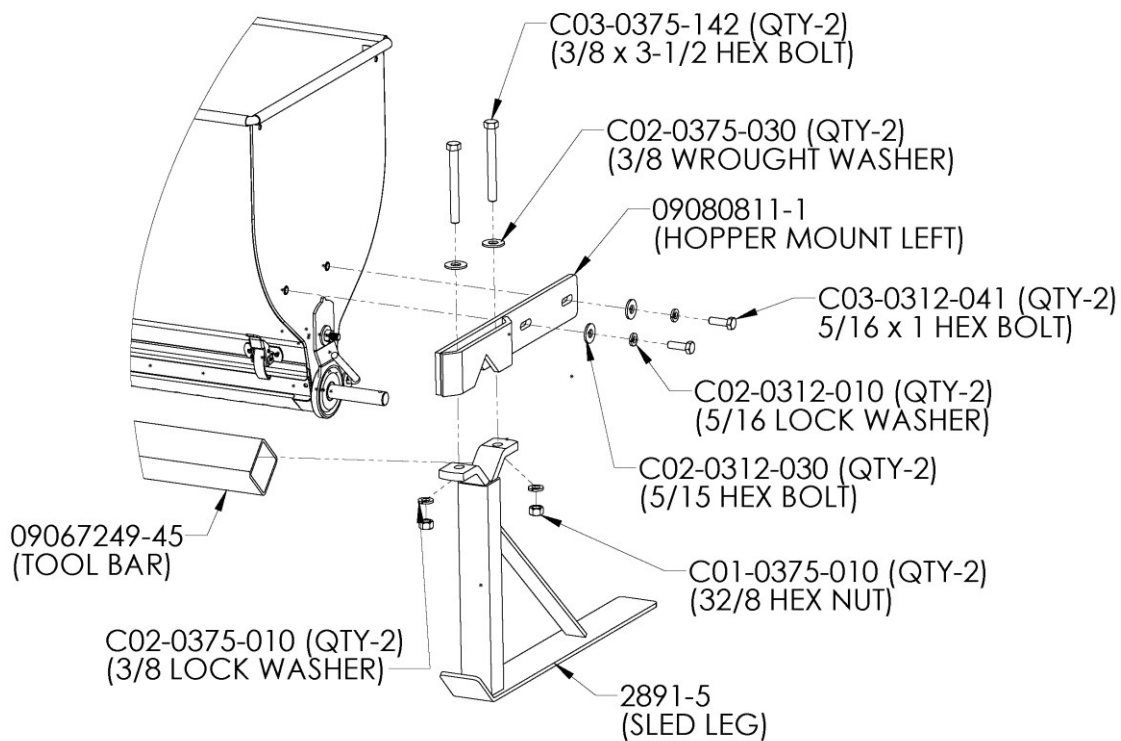

2842PTH (1/28/25)

## Right Side Mount

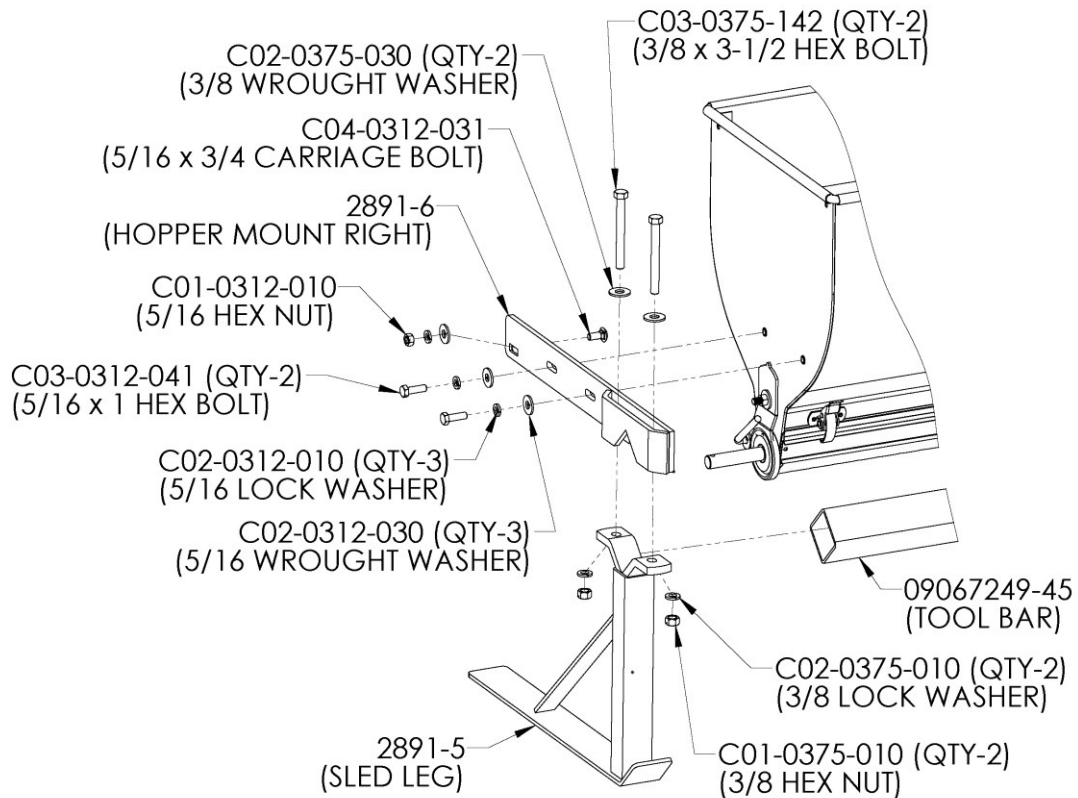

2842PTH (1/28/25)

## Left Electric Motor

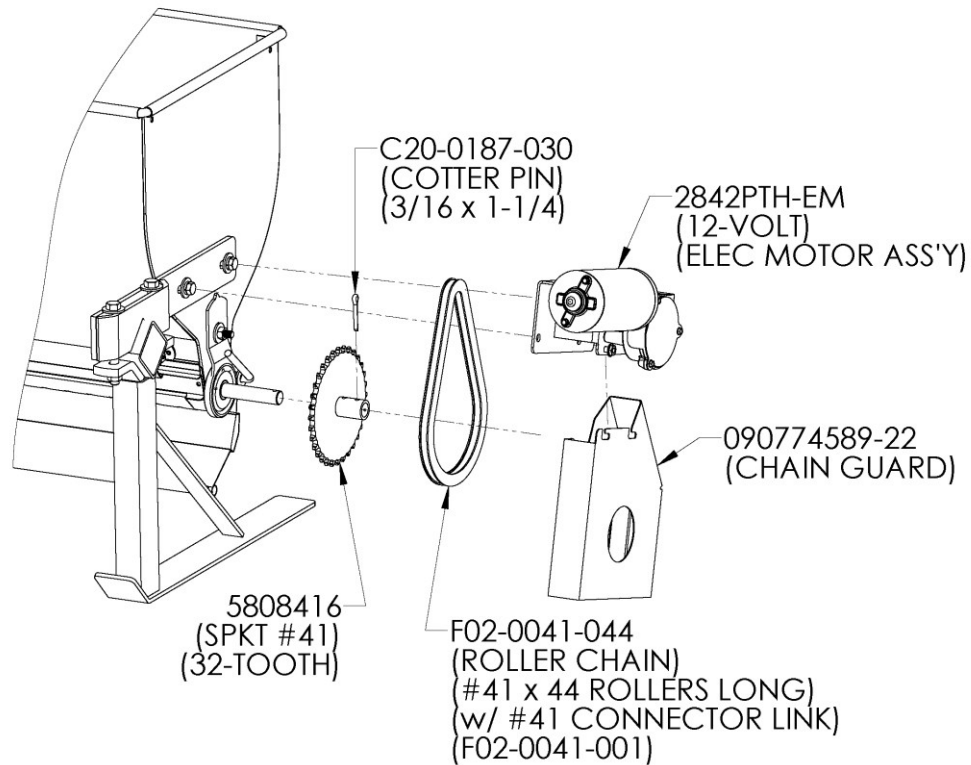

2842PTH (1/28/25)

## Right Electric Motor

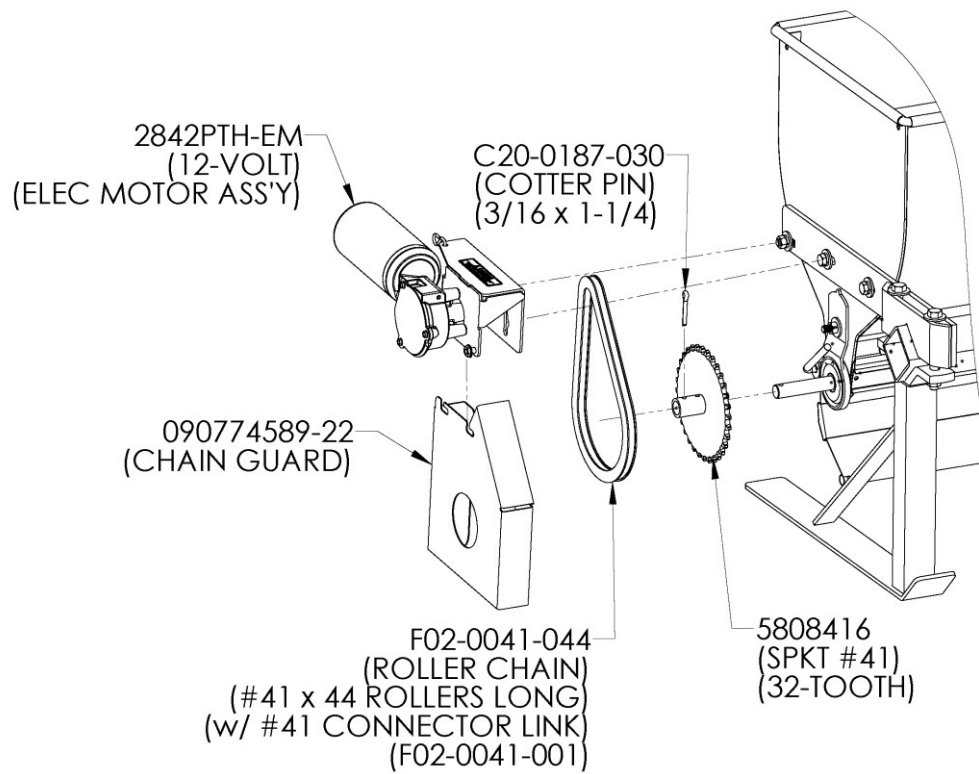

2842PTH (1/28/25)

## 2842PTH-Em 12-Volt Electric Motor Assembly

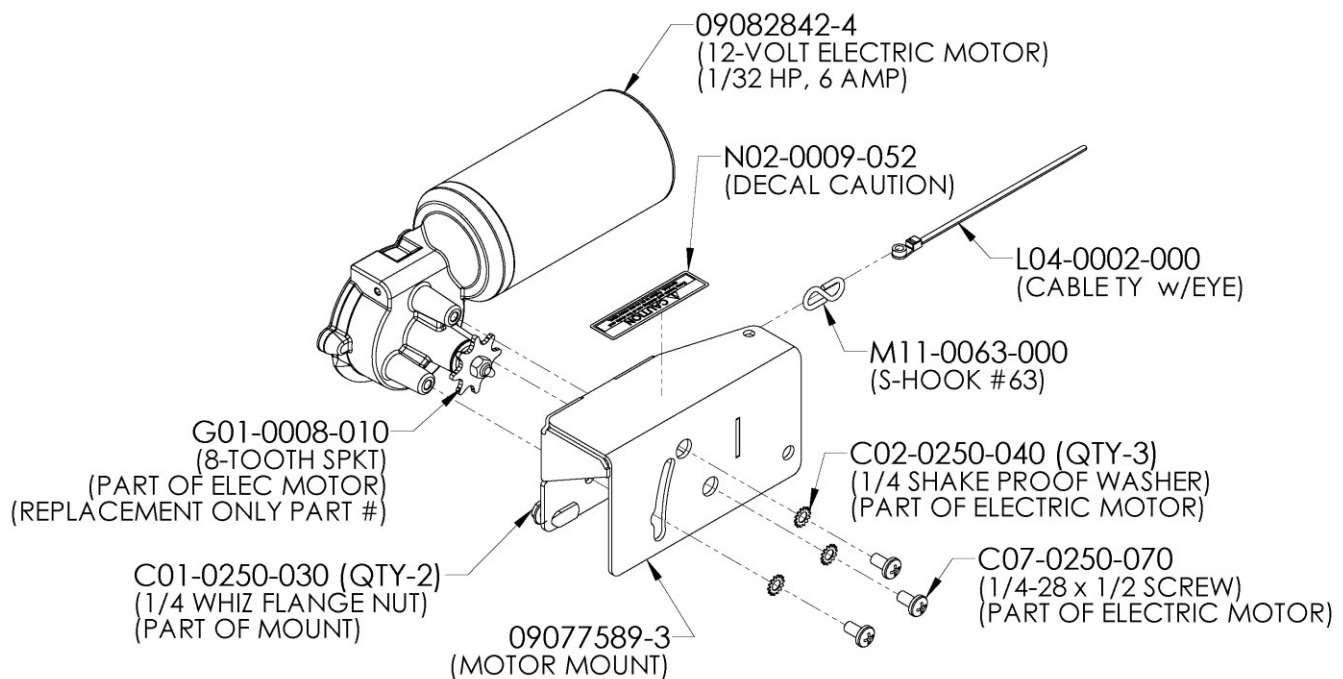

2842PTH-EM (12/28/25)

## Sash Chain Assembly

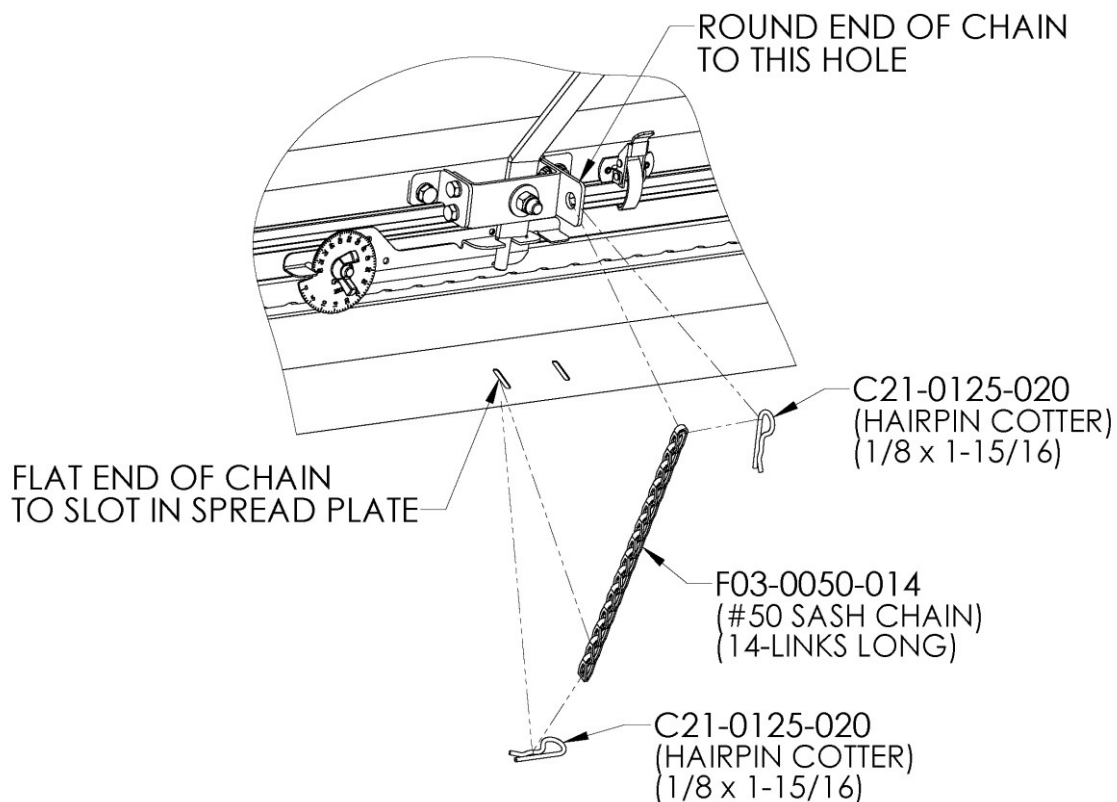

2824pth (12/28/25)

## Jigglers

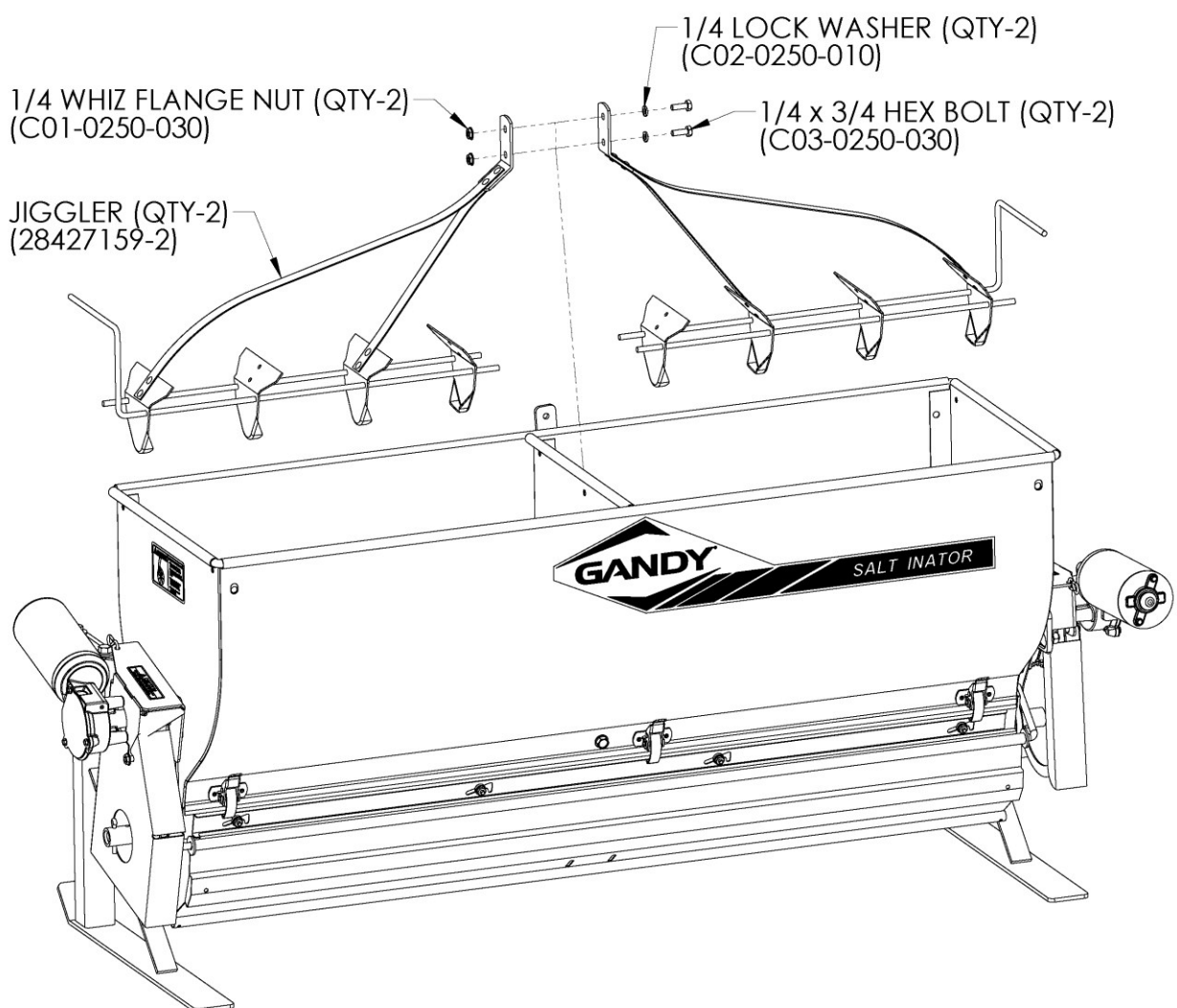

42PTH (2/2/25)

## Decal Location

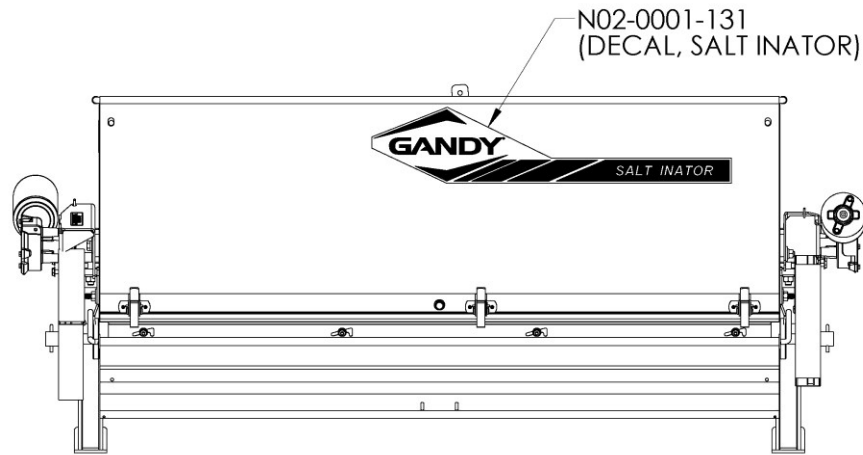

42PTH-S (12/1/25)

## Decal Location

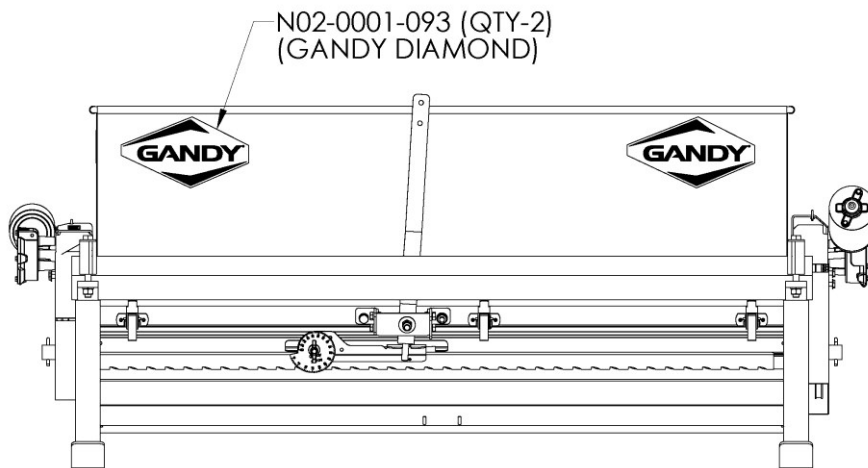

42PTH-S (12/1/25)

## Decal Location

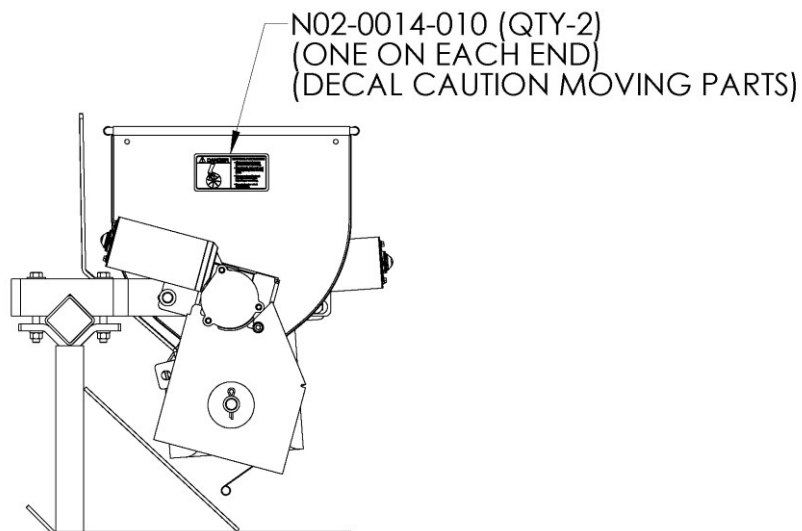

42PTH-S (12/1/25)

## (42PTH-C) Console Assembly

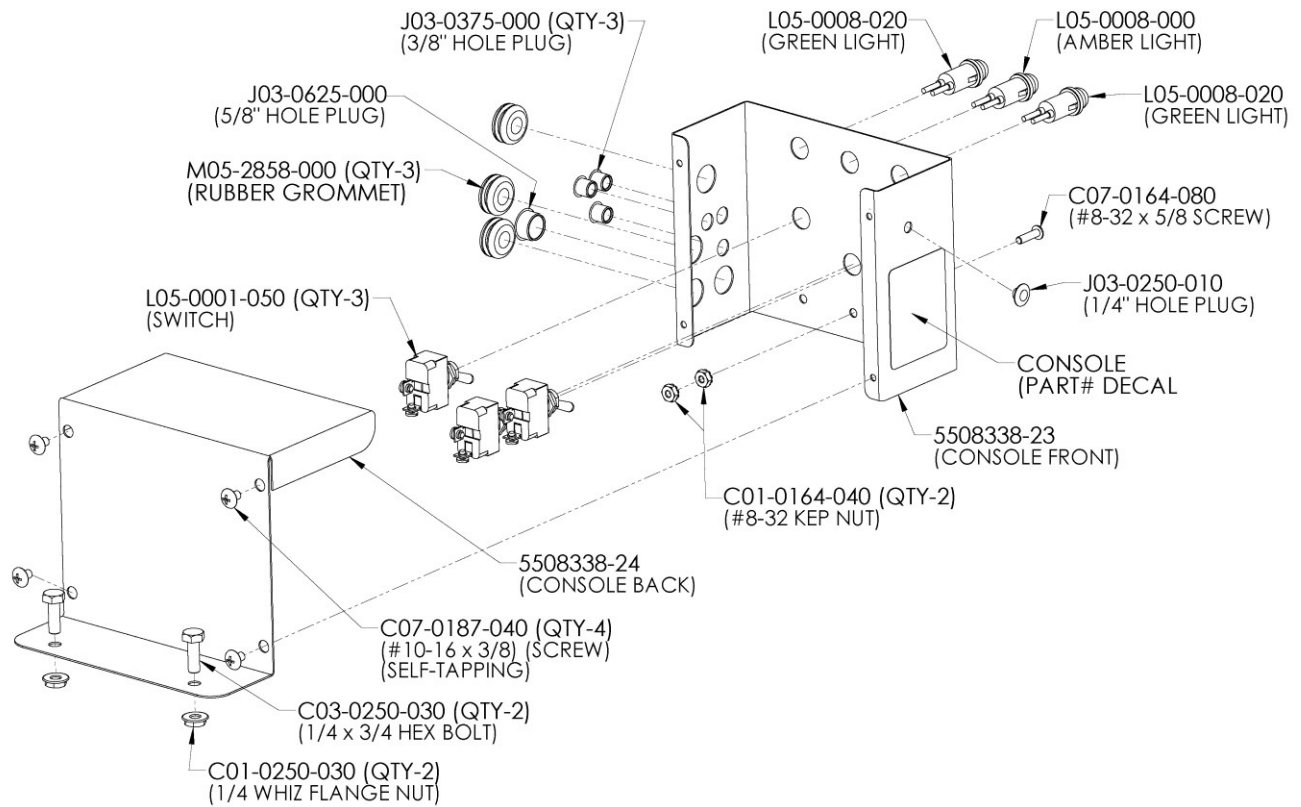

42PTH-C (1/30/25)

## Console Wiring Diagram

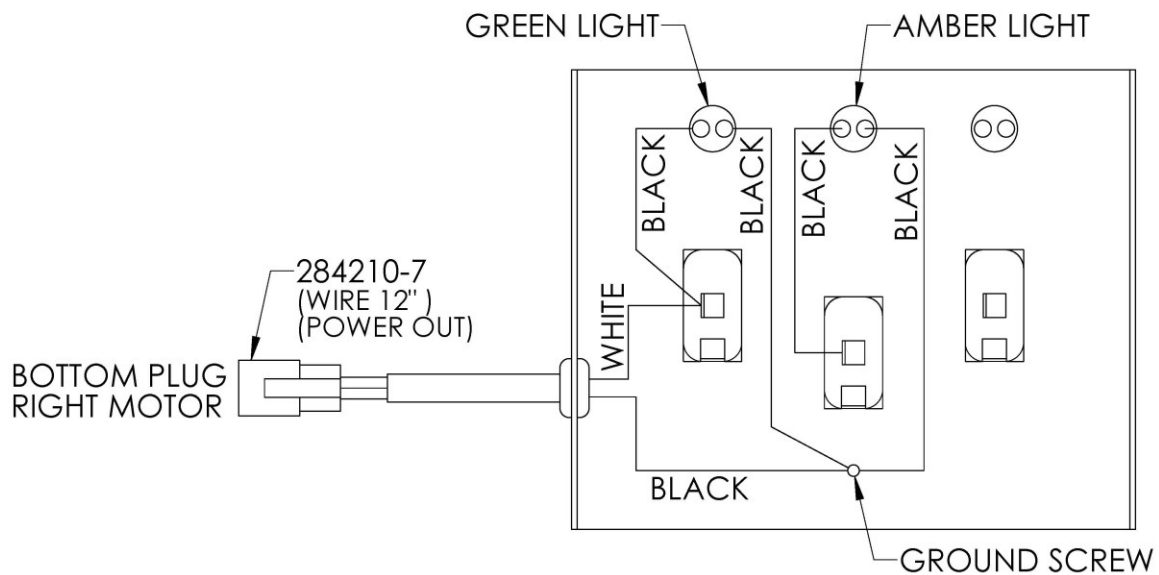
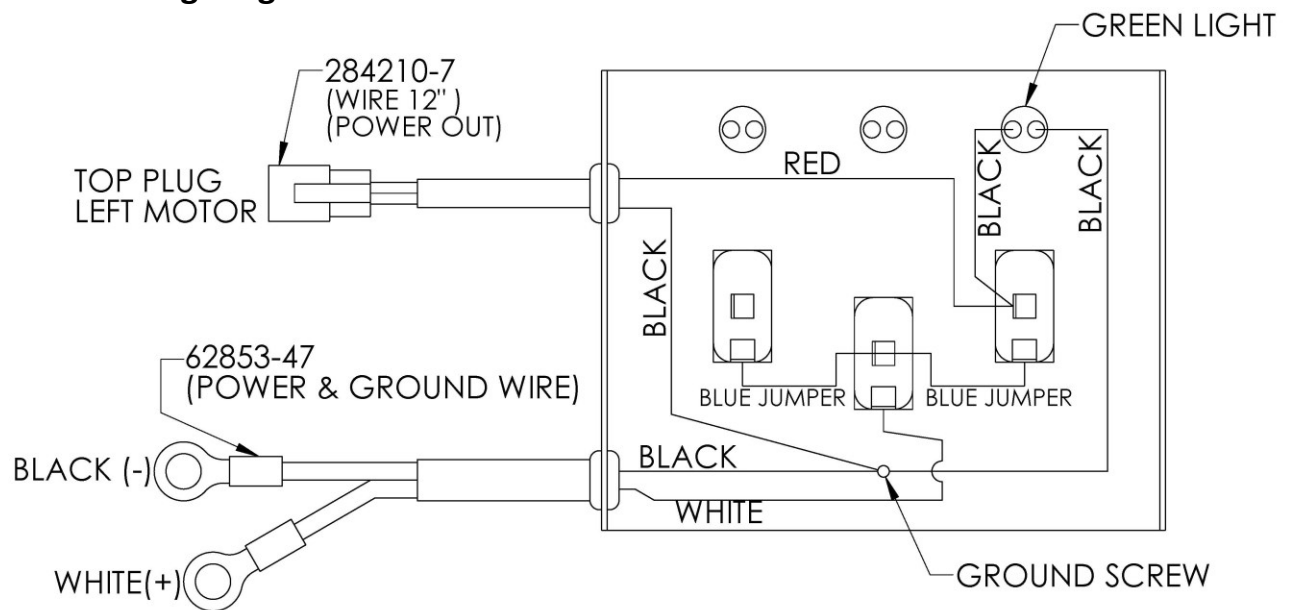

42PTH-C (1/30/25)



# Maintenance & Cleaning for Gandy 42" Salt Anator®

## General Maintenance:

Check all bolts for tightness periodically.

Always empty hopper when finished.

Never leave Salt for extended periods of time in the spreader as it can corrode and/or rust the parts.

## Cleaning:

Always follow all safety guide lines listed on the product label of material used in spreader when cleaning.

**SALT:** It is recommended to do a more thorough cleaning.

(For detailed drawings see Parts & Assembly section at start of this booklet supplied with spreader)

1. With spreader empty turn spreader over so the bottom faces up.
2. Remove both tires.
3. Remove the spread plate by removing the wing nuts and washers holding the bearing retainers in place.
4. With the spread plate and bearing retainers removed, un-snap and un-hook the latches holding the stainless bottom in place. **Note:** There are 6 latches (3 each side).  
With the latches un-hooked, grab the bottom on one end and pull straight up to remove the bottom.
5. Remove the bearings, rotor bars and end washers (on ends of rotor bar) from the spreader.
6. Wipe & clean all parts including spreader hopper. Clean all material out of the center and end bearings.  
**Note:** See Bottom Disassembly instruction on next page.
7. After cleaning the bearings, place a few drops of light oil on the inside of each bearing.  
**Note:** The bearings are porous and will absorb small amounts of oil.  
**Note:** The center and end bearings do not turn. The shaft turns inside the bearing.  
Some materials have fine powder in the mixture, so it may be necessary to oil the bearings more often to prevent powder from working into the bearings.

**All parts need to be completely dry before reassembling.**

8. Install end washers back on long ends of rotor bars.  
Reassemble rotor bars and bearings back on spreader.
9. Reinstall and center the stainless bottom on the spreader making sure the cam gauge is on the handle/hitch side and the shut-off lever is in the U-notch.  
Hook all the latches back onto the bottom and snap into place.
10. Reinstall tires.
11. Turn spreader upright on it tires and reconnect spread plate chain.
12. Open and close shut-off lever. If shut-off lever operates hard the bottom can be adjusted to operate easier. (Similarly to Step #6 in the bottom disassembly instructions)  
From the side opposite the cam gauge loosen the 3/6" flange nuts. Un-snap the latches on this side only and tap the rear hanger to your right about 1/16" inch. Retighten 3/16" nuts, re-snap latches and try shut-off lever again. Repeat if needed until shut-off lever operates smoothly.

### Bottom Disassembly Instructions:

Occasionally it will be necessary to disassemble the stainless bottom for cleaning.

Some materials will build up in between the slide and the bottom especially when atmospheric humidity is high.

1. Remove the 5/16" wing nut, washer and cam gauge from bottom assembly.

Diagram A

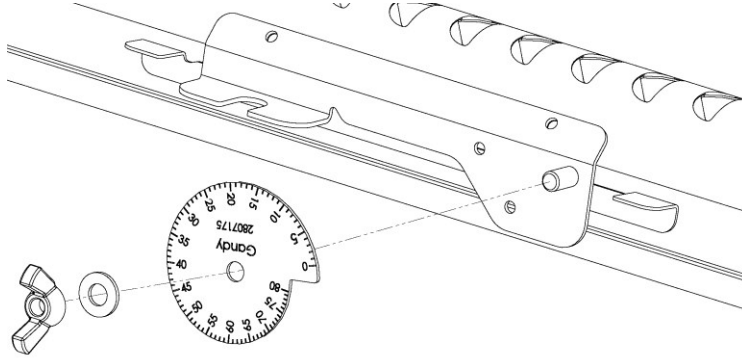

OPP-36-24-A1

2. Measure the distance from the edge of the bottom to the edge of the rear hanger and write that down.  
See Diagram B. You will use this dimension to reassemble the bottom.

Diagram B

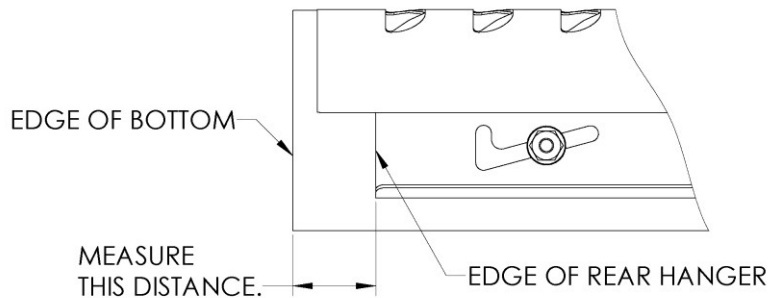

OPP-36-24-A1

3. Remove the 3/16" flange nuts and nylon washers from the rear hanger.

**Note:** The 42" bottom has 4 nuts and washers.

Diagram C

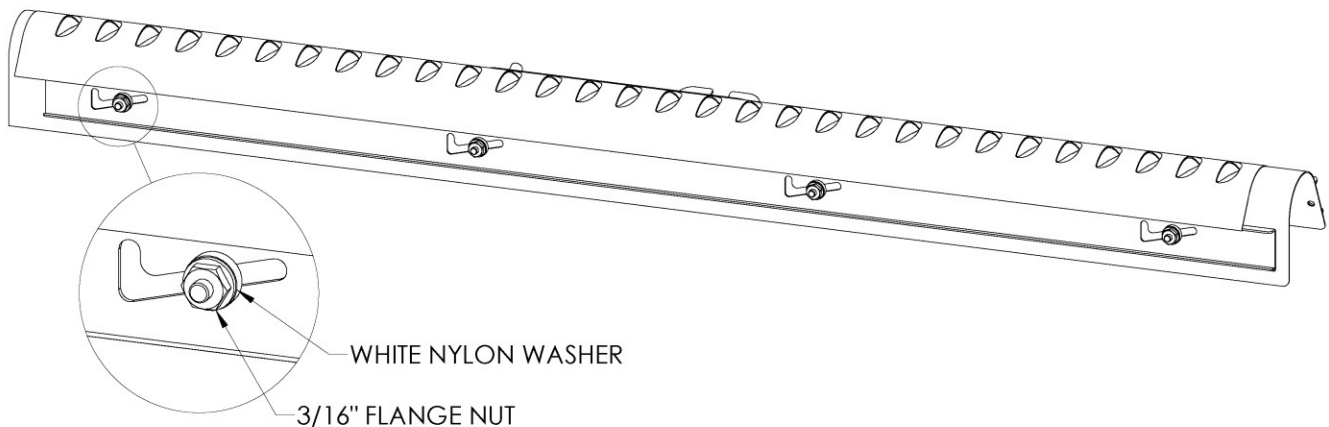

OPP-36-24-A1

4. With the nuts and washers removed you will see the angled slots on the rear hanger.
- With a small hammer gently tap on the end of the rear hanger as shown to loosen it from the studs. See Diagram D.
- With the hanger loose, slide it in the direction shown until the threaded studs align with the straight up and down area of the slot. See Diagram E.
- Pivot the rear hanger away from the bottom and all the way off the studs. This will allow the hanger to un-hook from the slide and be removed. See Diagram F.
- Lift up and pivot the slide away from the bottom. This will allow the side to unhook from the front hanger. See Diagram G.
- Note:** Be careful when handling the bottom & slide so you do not drop, bend, or dent it.

Diagram D

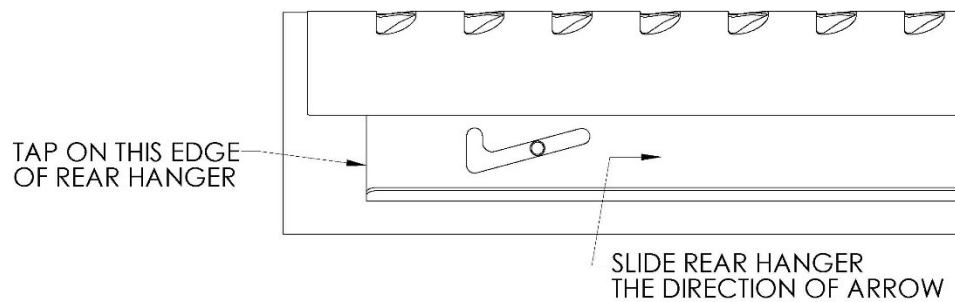

Diagram E

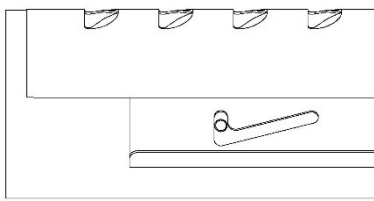

Diagram F

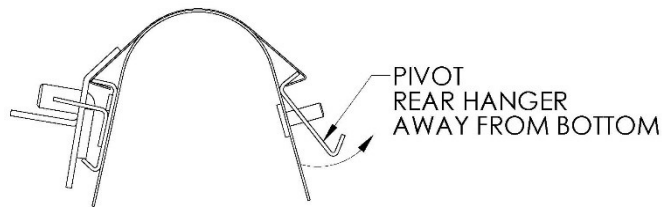
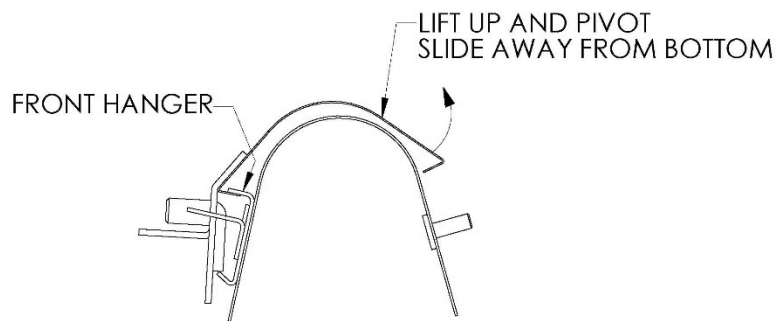

Diagram G



OPP-36-24-A1

5. **Note:** Be careful when handling the bottom & slide so you do not drop, bend, or dent it.  
With the bottom & slide disassembled wipe or wash these parts clean.  
If any rust or corrosion has formed on these parts it should be removed.  
(Fine steel wool or a fine scotch-bright pad & WD40 or similar products will work.)  
Make sure all parts are dry and all oil removed before reassembling.  
Do not oil or grease the bottom & slide. This will cause material to collect or stick in between the bottom & slide and cause it to slide harder and/or bind up.

6. Bottom reassembly.

Hook slide to the front hanger as shown in Diagram H and pivot onto bottom.

Hook rear hanger under lip of slide. Align the studs with straight up and down area of the slots on rear hanger and pivot into the bottom as shown in Diagram J.

With a small hammer gently tap on the end of the rear hanger as shown until the rear hanger matches the dimension you took from Step #4, Diagram D. See Diagram K.

Reinstall the nylon washers and 3/16" flange nuts to all studs. Be careful when tightening flange nut as to not over tighten and twist off.

**Note:** You should be able to move the slide by hand. If you cannot move the slide by hand loosen the 3/16" flange nuts and slightly tap the rear hanger the opposite direction as shown in Diagram K, tighten the 3/16" nuts and try to slide by hand again. Repeat this process if needed.

Reinstall the cam gauge, washer & wing nut.

Reassemble bottom on spreader.

Diagram H

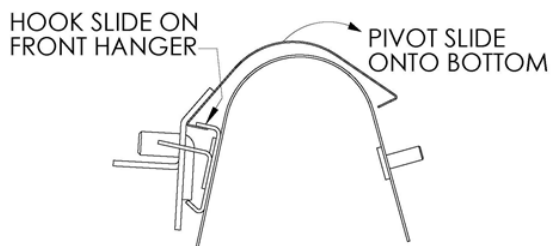

Diagram J

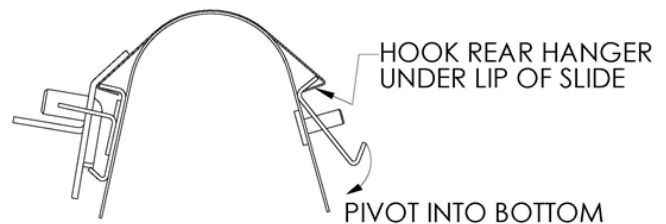
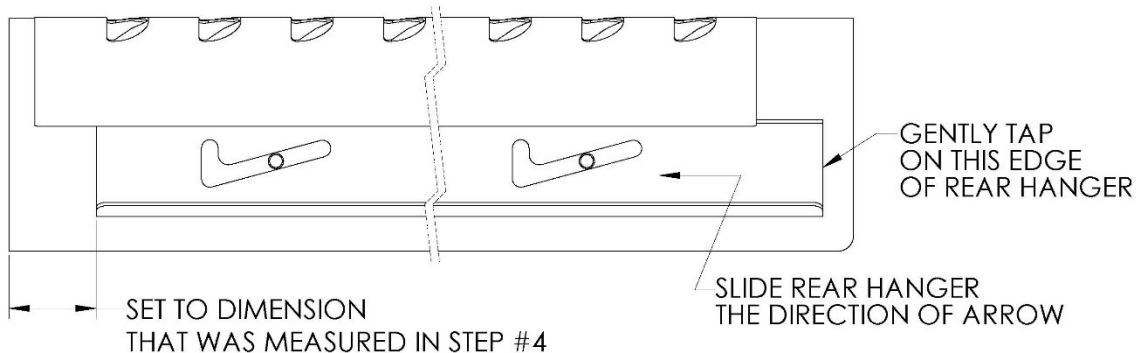

Diagram K



OPP-36-24-A1