



# Illustrated Parts & Packing List

528 Gandrud Road, Owatonna, MN 55060

For a complete distributor & dealer list go to [www.gandy.net](http://www.gandy.net)

## 4927

### Hydraulic Lift Package For Sweep Master

(All Hardware In Hardware Bag Unless Otherwise Specified)

#### Carton Containing The Following Parts:

- 2 ..... K02-0250-048 ..... Hydraulic Hoses (1/4 x 4 Ft. w/ 1/4-18 Tapered Pipe Thread)
- 1 ..... K15-1506-000 ..... Hydraulic Cylinder (6-Inch Stroke 1-1/2 Bore)
- 2 ..... R02-0011-011 ..... Tire & Wheel Assembly, 13-Inch
- 1 ..... 490894-2 ..... Frame, Wheels
- 1 ..... 497-1 ..... Pivot Arm
- 1 ..... 497-2 ..... Lift Arm, Left
- 1 ..... 497-3 ..... Lift Arm, Right
- 1 ..... 497-4 ..... Sweep Master Hitch Weldment
- 1 ..... 497-5 ..... Hydraulic Cylinder Yoke
- 1 ..... 497-6 ..... Rear Tee Angle
- 2 ..... 497-7 ..... Wheel Hub, 4-Bolt With 5/8 I.D. Bearings & Hub Nuts in Place
- 1 ..... 4927-H ..... Hardware Bag
- 1 ..... Parts & Packing List

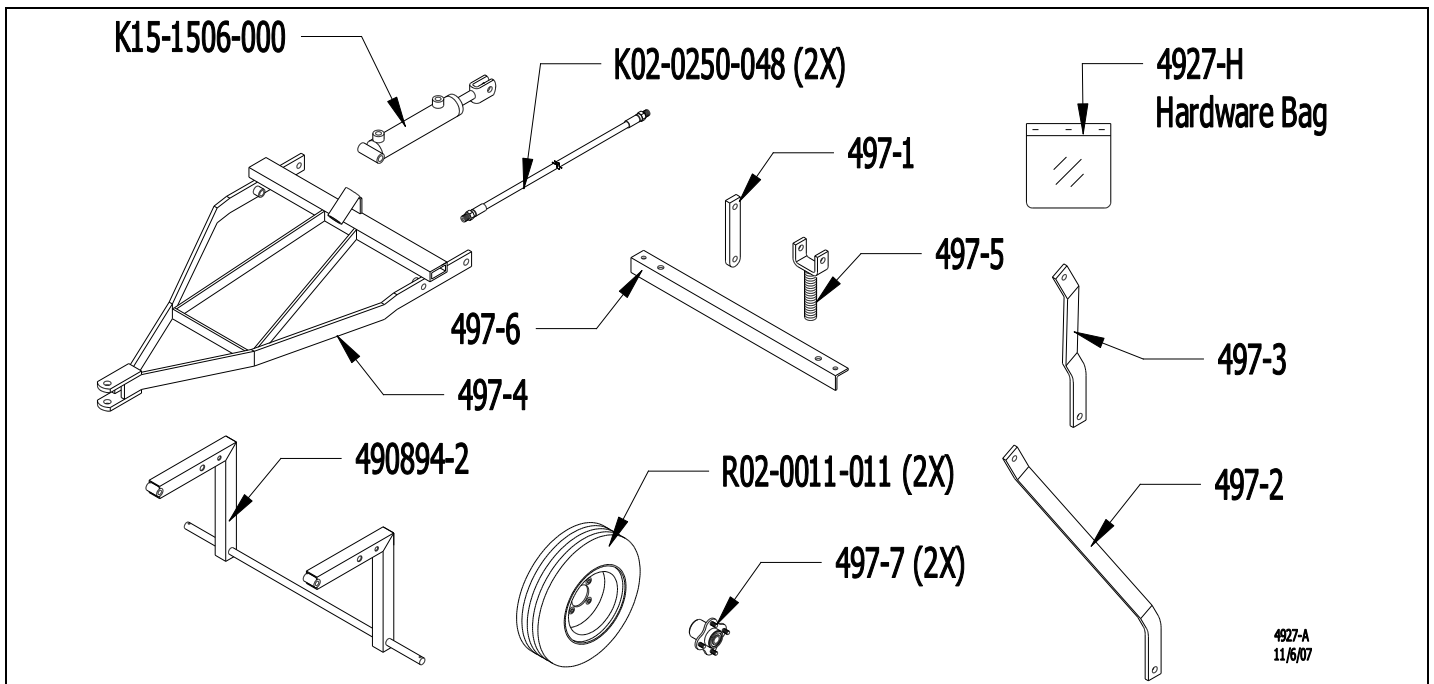









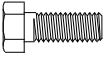

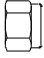
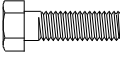
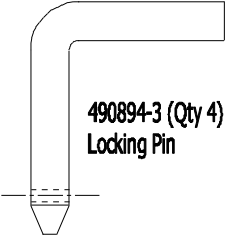
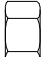
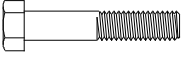

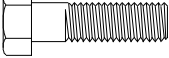
- 1..... K15-1506-000 .....Hydraulic Cylinder (6-Inch Stroke 1-1/2 Bore)  
 Use: 1 Hex Bolt (1/2 x 2-1/2)(C03-0500-101)  
 2 SAE Washer (1/2)(C02-0500-020)  
 1 Lock Nut, Center Point (1/2)(C01-0500-040)
- 2..... K02-0250-048 .....Hydraulic Hoses (1/4 x 4 Ft. w/ 1/4-18 Tapered Pipe Thread)
- 1..... 497-5.....Hydraulic Cylinder Yoke  
 Use: 2 Jam Nut (1-Inch)(C01-1000-060)  
 1 Hex Bolt (1/2 x 3-1/2)(C03-0500-141)  
 1 Lock Nut, Center Point (1/2)(C01-0500-040)
- 1..... 497-1.....Pivot Arm  
 Use: 1 Hex Bolt (1/2 x 1-3/4)(C03-0500-071)  
 1 Lock Nut, Center Point (1/2)(C01-0500-040)
- 1..... 497-2.....Lift Arm, Left  
 Use: 1 Bushing (9/16 O.D. x 7/16 Long)(2606515-6)  
 1 Hex Bolt (3/8 x 2-1/2)(C03-0375-101)  
 3 Wrought Washer (3/8)(C02-0375-030)  
 1 Lock Nut, Nylon (3/8)(C01-0375-041)
- 1..... 497-3.....Lift Arm, Right  
 Use: 1 Bushing (9/16 O.D. x 7/16 Long)(2606515-6)  
 1 Hex Bolt (3/8 x 2-1/2)(C03-0375-101)  
 3 Wrought Washer (3/8)(C02-0375-030)  
 1 Lock Nut, Nylon (3/8)(C01-0375-041)
- 1..... 497-6.....Rear Tee Angle  
 Use: 2 Hex Bolt (3/8 x 1)(C03-0375-041)  
 2 Lock Washer (3/8)(C02-0375-010)  
 2 Hex Nut (3/8)(C01-0375-010)  
 2 Hex Bolt (1/2 x 1-3/4)(C03-0500-071)  
 2 Hex Nut (1/2)(C01-0500-010)
- 1..... 497-4.....Sweep Master Hitch Weldment  
 Use: 2 Hex Bolt (3/8 x 1-1/4)(C03-0375-051)  
 2 Wrought Washer (3/8)(C02-0375-030)  
 2 Lock Nut, Nylon (3/8)(C01-0375-041)  
 2 Bushing (9/16 O.D. x 7/16 Long)(2606515-6)  
 2 Locking Pin (490894-3)  
 2 Hairpin Cotter (1/8 x 2-9/16)(C21-0125-030)
- 1..... 490894-2.....Frame, Wheels  
 Use: 2 Hex Bolt (3/8 x 2-1/2)(C03-0375-101)  
 4 Wrought Washer (3/8)(C02-0375-030)  
 2 Lock Nut, Nylon (3/8)(C01-0375-041)  
 2 Locking Pin (490894-3)  
 2 Hairpin Cotter (1/8 x 2-9/16)(C21-0125-030)
- 2..... R02-0011-011.....Tire & Wheel Assembly, 13-Inch
- 2..... 497-7.....Wheel Hub, 4-Bolt With 5/8 I.D. Bearings  
 4 Bearing (For 5/8 Shaft)(D05-0625-000) **(In Place In Hub)**  
 8 Hub Nut (5/16-24 UNF)(C01-0312-080) **(In Place On Hub)**  
 2 Bushing (7/8 O.D. x 1-Inch Long)(490894-4)  
 2 SAE Washer (5/8)(C02-0625-020)  
 2 Cotter Pin (3/16 x 1-1/4)(C20-0187-030)

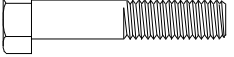
**1.....4927-H.....Hardware Bag Containing:**

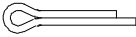
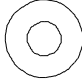
- 2 ..... C01-0375-010.....Hex Nut (3/8)
- 6 ..... C01-0375-041.....Lock Nut, Nylon (3/8)
- 2 ..... C01-0500-010.....Hex Nut (1/2)
- 3 ..... C01-0500-040.....Lock Nut, Center Point (1/2)
- 2 ..... C01-1000-060.....Jam Nut (1-Inch)
- 2 ..... C02-0375-010.....Lock Washer (3/8)
- 12 ..... C02-0375-030.....Wrought Washer (3/8)
- 2 ..... C02-0500-020.....SAE Washer (1/2)
- 2 ..... C02-0625-020.....SAE Washer (5/8)
- 2 ..... C03-0375-041.....Hex Bolt (3/8 x 1)
- 2 ..... C03-0375-051.....Hex Bolt (3/8 x 1-1/4)
- 4 ..... C03-0375-101.....Hex Bolt (3/8 x 2-1/2)
- 3 ..... C03-0500-071.....Hex Bolt (1/2 x 1-3/4)
- 1 ..... C03-0500-101.....Hex Bolt (1/2 x 2-1/2)
- 1 ..... C03-0500-141.....Hex Bolt (1/2 x 3-1/2)
- 2 ..... C20-0187-030.....Cotter Pin (3/16 x 1-1/4)
- 4 ..... C21-0125-030.....Hairpin Cotter (1/8 x 2-9/16)
- 4 ..... 2606515-6.....Bushing (9/16 O.D. x 7/16 Long)
- 4 ..... 490894-3.....Locking Pin
- 2 ..... 490894-4.....Bushing (7/8 O.D. x 1-Inch Long)

**Hardware Bag Contents:**

 <p><b>C01-0375-010 (Qty 2)</b> Hex Nut (3/8)</p>	 <p><b>C03-0375-041 (Qty 2)</b> Hex Bolt 3/8 x 1</p>	 <p><b>2606515-6 (Qty 4)</b> Bushing (9/16 O.D. x 7/16 Long)</p>
 <p><b>C01-0375-041 (Qty 6)</b> Lock Nut, Nylon (3/8)</p>	 <p><b>C03-0375-051 (Qty 2)</b> Hex Bolt 3/8 x 1-1/4</p>	 <p><b>490894-3 (Qty 4)</b> Locking Pin</p>
 <p><b>C01-0500-010 (Qty 2)</b> Hex Nut (1/2)</p>	 <p><b>C03-0375-101 (Qty 4)</b> Hex Bolt 3/8 x 2-1/2</p>	
 <p><b>C01-0500-040 (Qty 3)</b> Lock Nut, Center Point (1/2)</p>	 <p><b>C03-0500-071 (Qty 3)</b> Hex Bolt 1/2 x 1-3/4</p>	 <p><b>490894-4 (Qty 2)</b> Bushing (7/8 x O.D. x 1-Inch Long)</p>
 <p><b>C01-1000-060 (Qty 2)</b> Jam Nut (1-Inch)</p>	 <p><b>C03-0500-101 (Qty 1)</b> Hex Bolt 1/2 x 2-1/2</p>	
 <p><b>C02-0375-010 (Qty 2)</b> Lock Washer (3/8)</p>	 <p><b>C20-0187-030 (Qty 2)</b> COTTER PIN 3/16 X 1-1/4</p>	
 <p><b>C02-0375-030 (Qty 12)</b> Wrought Washer (3/8)</p>	 <p><b>C21-0125-030 (Qty 4)</b> Hairpin Cotter 1/8 x 2-9/16</p>	
 <p><b>C02-0500-020 (Qty 2)</b> SAE Washer (1/2)</p>		
 <p><b>C02-0625-020 (Qty 2)</b> SAE Washer (5/8)</p>		

4927-H  
11/6/07

## Installation Instructions – Electric Lift Option

(See Diagrams on Following Pages)

**Note:** Pivot tabs in the center of Sweep Master deck **must be facing** hitch (497-4) when installed.

1. Attach hitch weldment (497-4) to Sweep Master parallel angles in second set of holes using two (3/8 x 1-1/4) hex bolts, two bushings (2606515-6), two 3/8 washers and 3/8 locknuts. Tighten. **Allow to pivot.**  
**See note above and on drawing on next page.**
2. Attach hydraulic cylinder yoke (497-5) to hitch frame (497-4) using two (1"-8) jam nuts.
3. Attach rear tee angle (497-6) to opposite side of hitch to parallel angles on Sweep Master using two (3/8 x 1) hex bolts, 3/8 lock washers and 3/8 hex nuts. Tighten. Use two (1/2 x 1-3/4) hex bolts through tee angle down from topside. Note 1/2 bolt head will be on top of angle. Leave 1/2 bolts loose. Tighten in step #4.
4. Attach frame wheel (490894-2) to Sweep Master parallel angles (same side as rear tee angle) using two (3/8 x 2-1/2) hex bolts, four 3/8 washers and two 3/8 locknut. **Note:** One 3/8 washer goes between the frame wheel and the Sweep Master parallels on both sides as shown. Tighten. **Allow to pivot.**  
Adjust 1/2 bolts from step #3 so when the frame wheel is in the down position and resting on the bolts, holes in frame wheels and parallels align as shown.
5. Attach lift arms (497-2 and 497-3) to inside of wheel frame, rear hole, using bushings (2606515-6), (3/8 x 2-1/2) hex bolts, wrought washers, and lock nuts as shown. **Tighten. Allow to pivot.**
6. Attach pivot arm (497-1) radius down to center cross member on Sweep Master using the (1/2 x 1-3/4) hex bolt and 1/2 lock nut. **Tighten. Allow to pivot.**
7. Attach hydraulic cylinder (K15-1506-000) to hydraulic cylinder yoke using the (1/2 x 3-1/2) hex bolt and 1/2 lock nut. **Tighten. Allow to pivot.**
8. Secure lift arms and hydraulic cylinder to pivot arm placing the (1/2 x 2-1/2) hex bolt through washer, Lift Arm, Hydraulic Cylinder Tab, Pivot Arm, Hydraulic Cylinder Tab, Lift Arm, washer and lock nut.  
**Tighten. Allow to pivot.**
9. Install wheel hub (497-7) to axle on wheel frame using bushing (490894-4), 5/8 washer and secure with cotter pin as shown. Attach tire (R02-0011-011) to wheel hub using hub nuts provided.  
Tighten securely. Repeat for other side. Grease wheel hubs before use.
10. Adjust nuts on hydraulic cylinder yoke (497-5) so that when unit is raised hitch and wheel frame go fully down for transport.
11. Connect hydraulic hoses to hydraulic cylinder and route back to hitch.  
Seal threads when installing to prevent leaking. Secure hoses to hitch when in use to prevent damage to hoses.
12. Locking pins (490894-3) and Hairpin cotters (C21-0125-030) are for locking unit in the raised position for transporting if pulling with a vehicle without hydraulic controls.

## Step #1

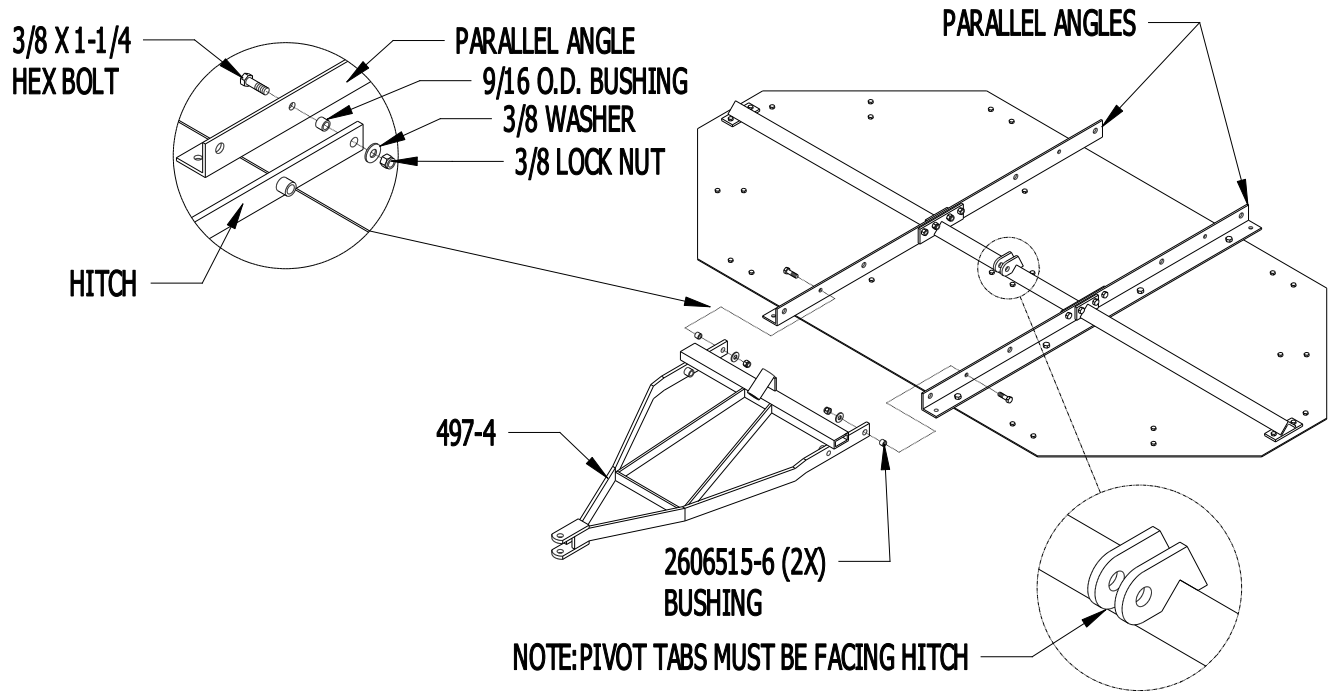

## Step #2

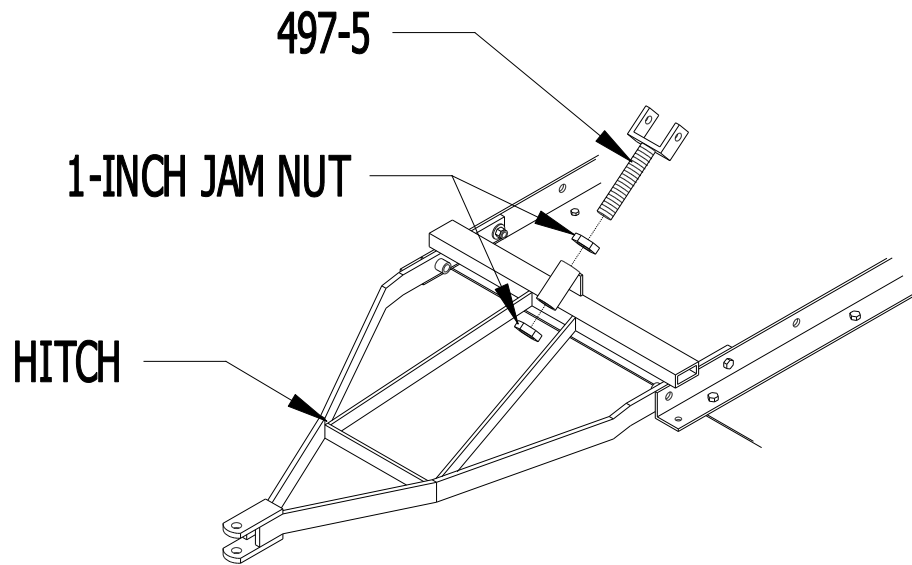

**Step #3**

**3/8 X 1 HEX BOLT  
LOCK WASHER & NUT**

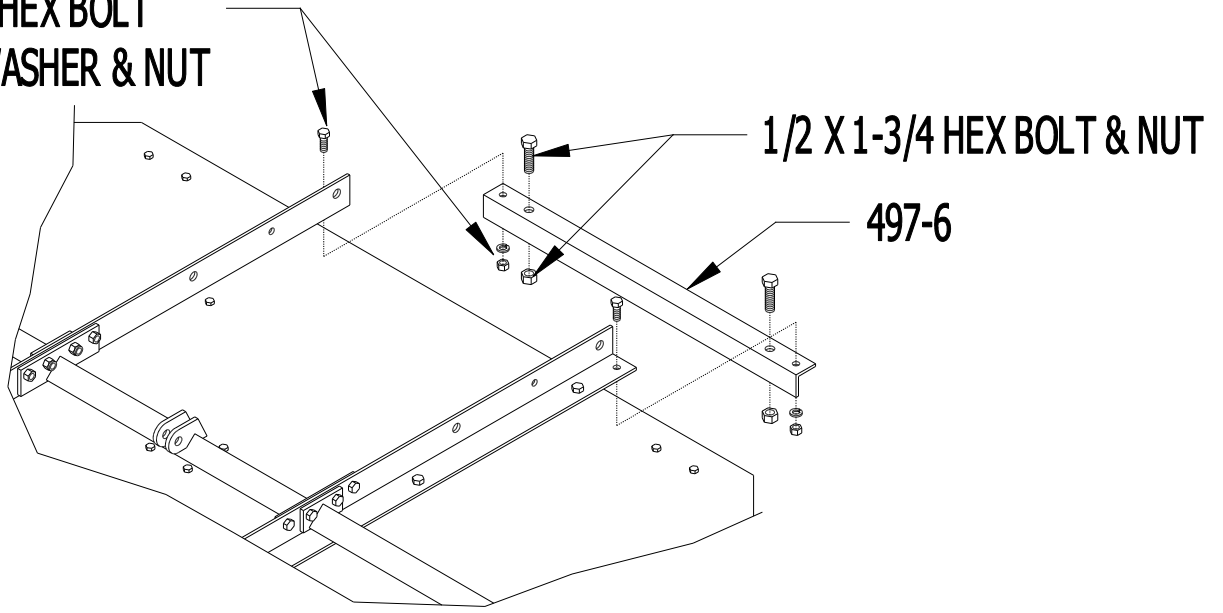

**Step #4**

**3/8 X 2-1/2 HEX BOLT**

**3/8 WASHERS**

**3/8 LOCK NUT**

**ALIGN THESE HOLE**

**ADJUST 1/2-INCH BOLTS FROM STEP #3  
TO ALIGN HOLES AS SHOWN  
LOCK IN PLACE WITH NUT**

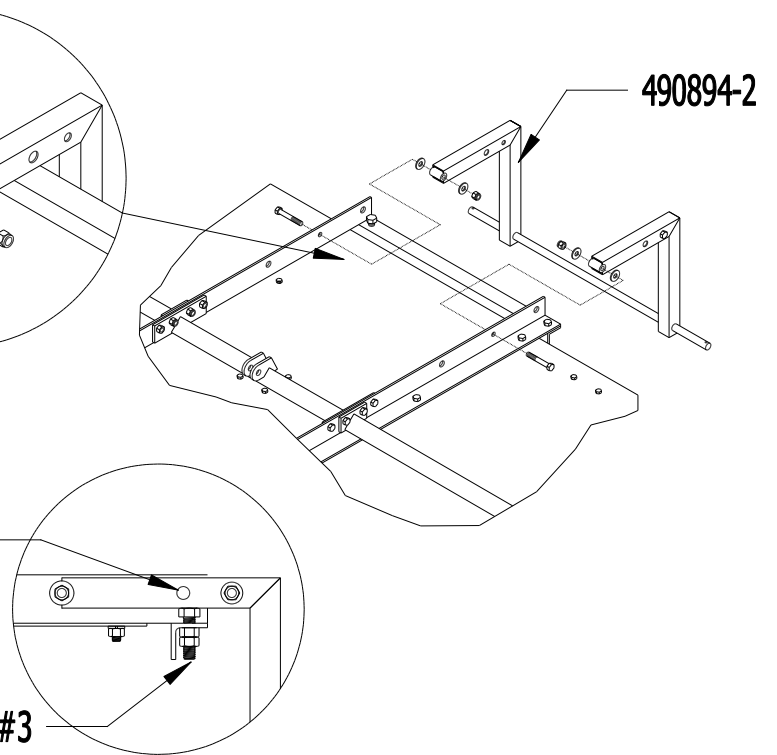

**Step #5**

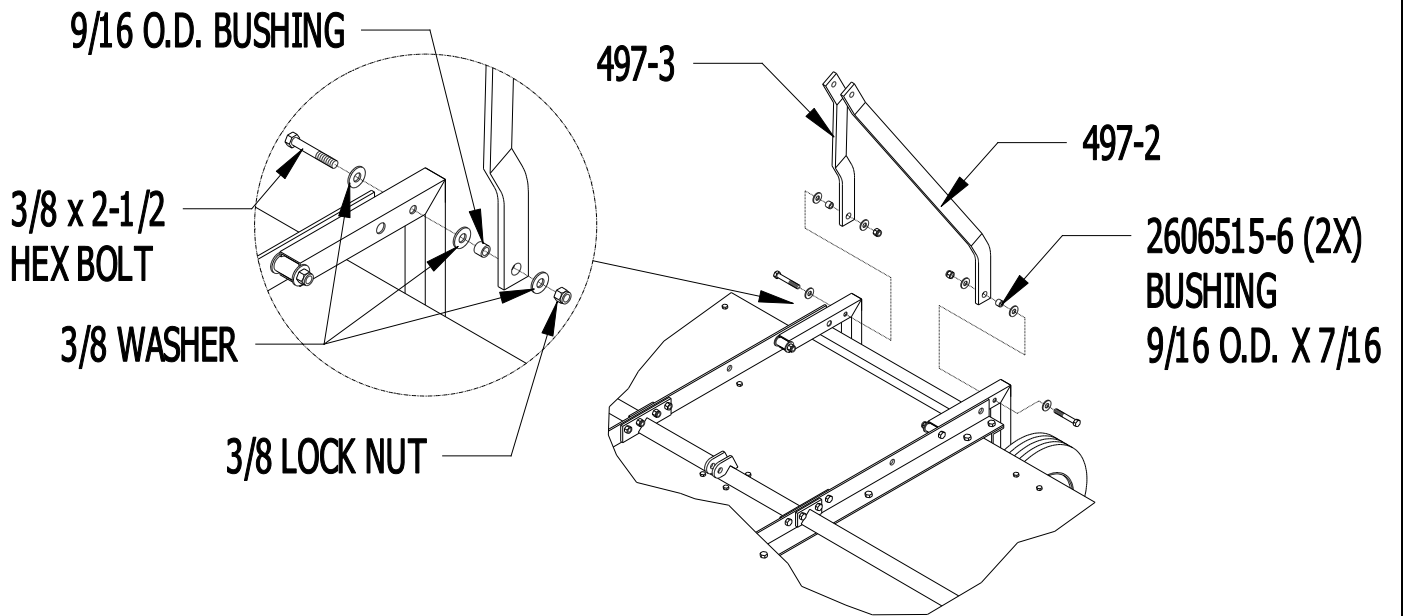

**Step #6**

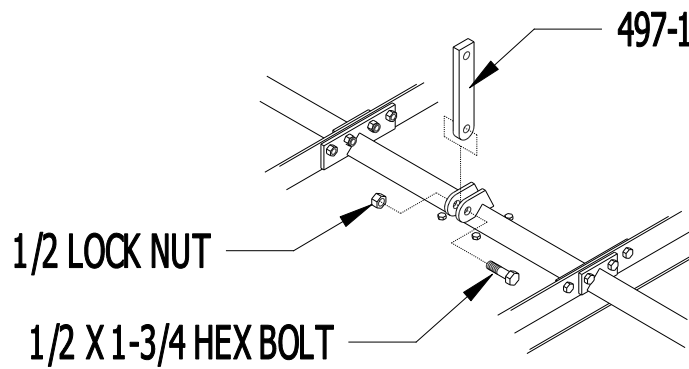

**Step #7**

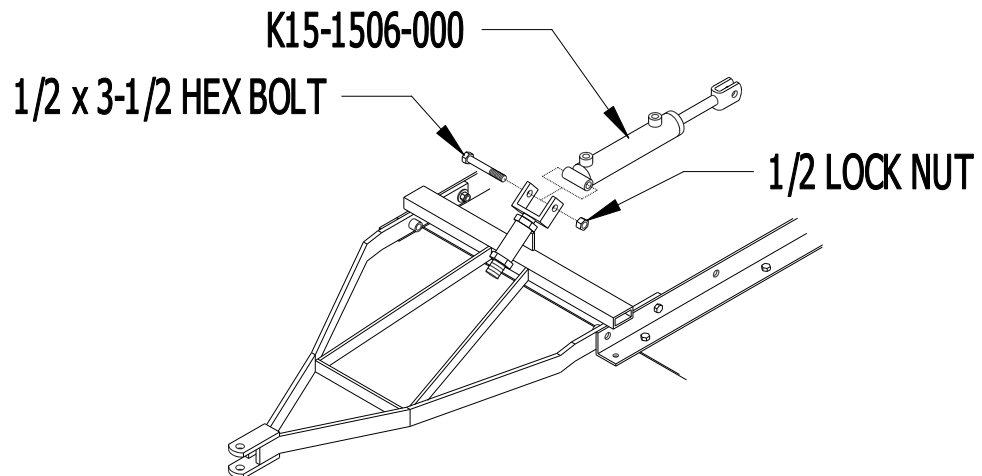

### Step #8

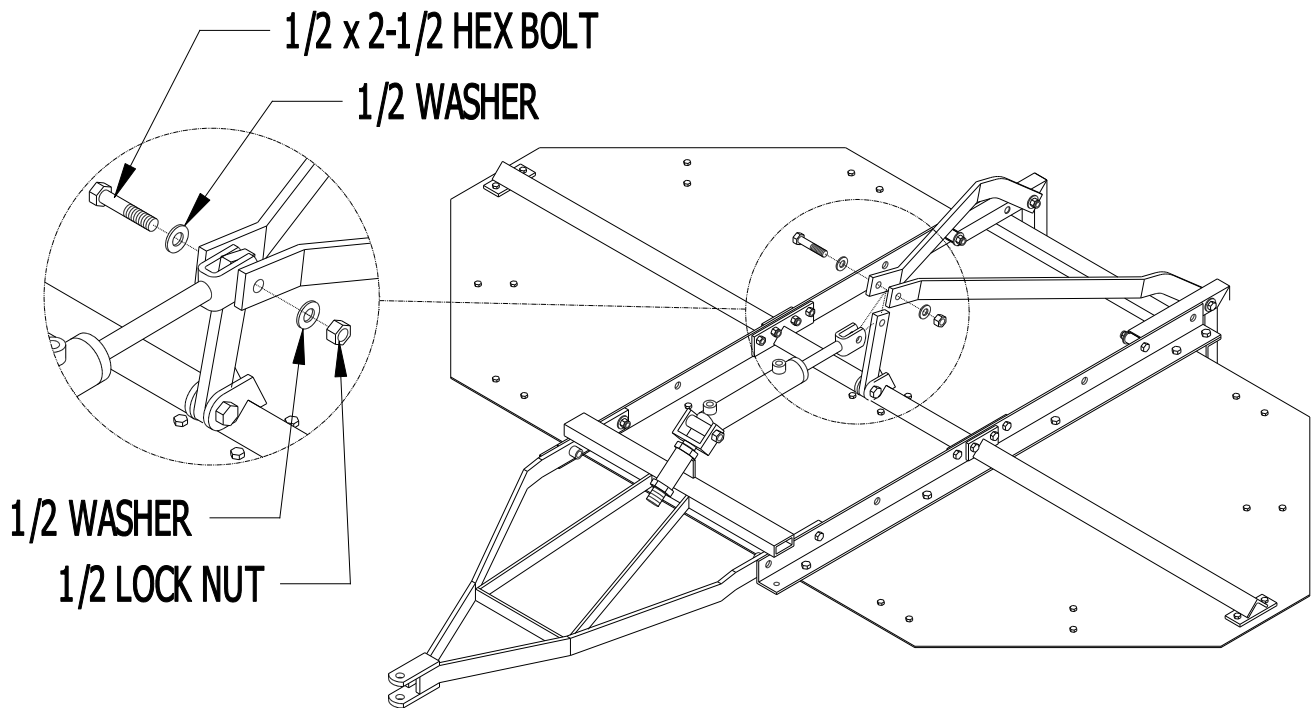

### Step #9

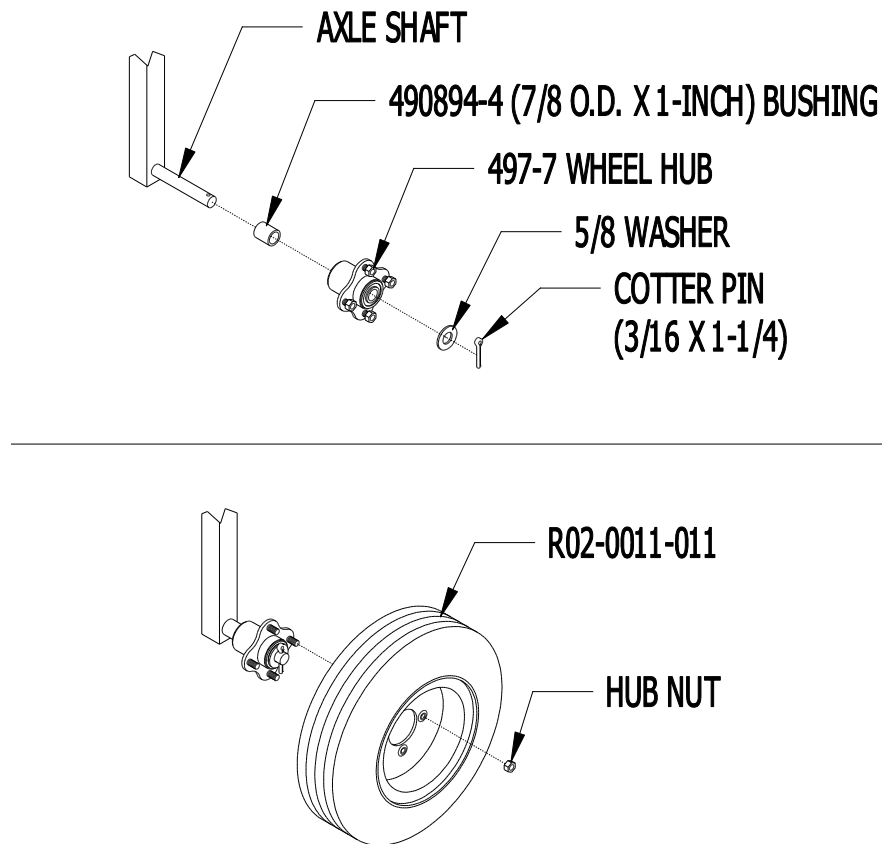



### Step #10

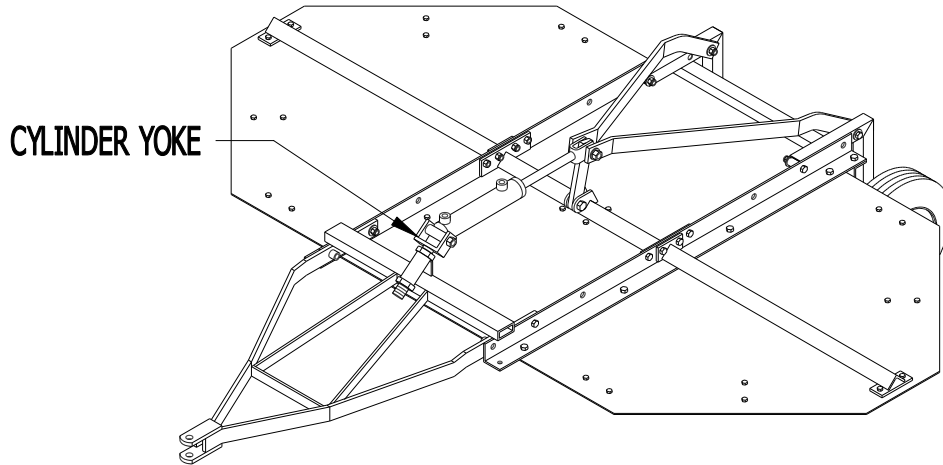

### Step #11

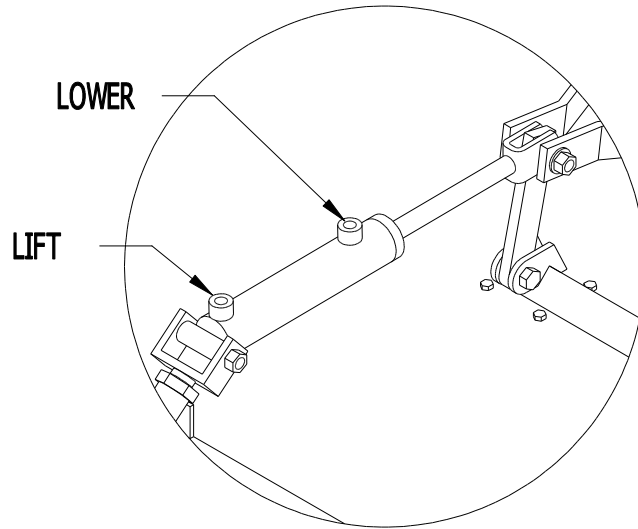

### Step #12

INSERT LOCKING PINS THROUGH THESE HOLES (2 EACH SIDE) TO LOCK IN RAISED POSITION FOR TRANSPORT

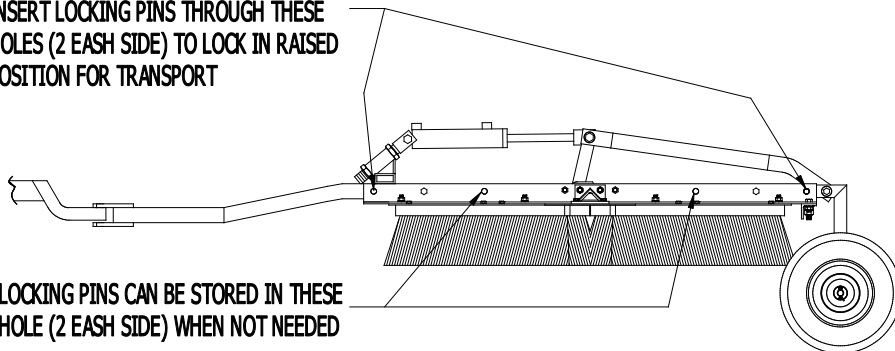

# Complete Parts Break Down

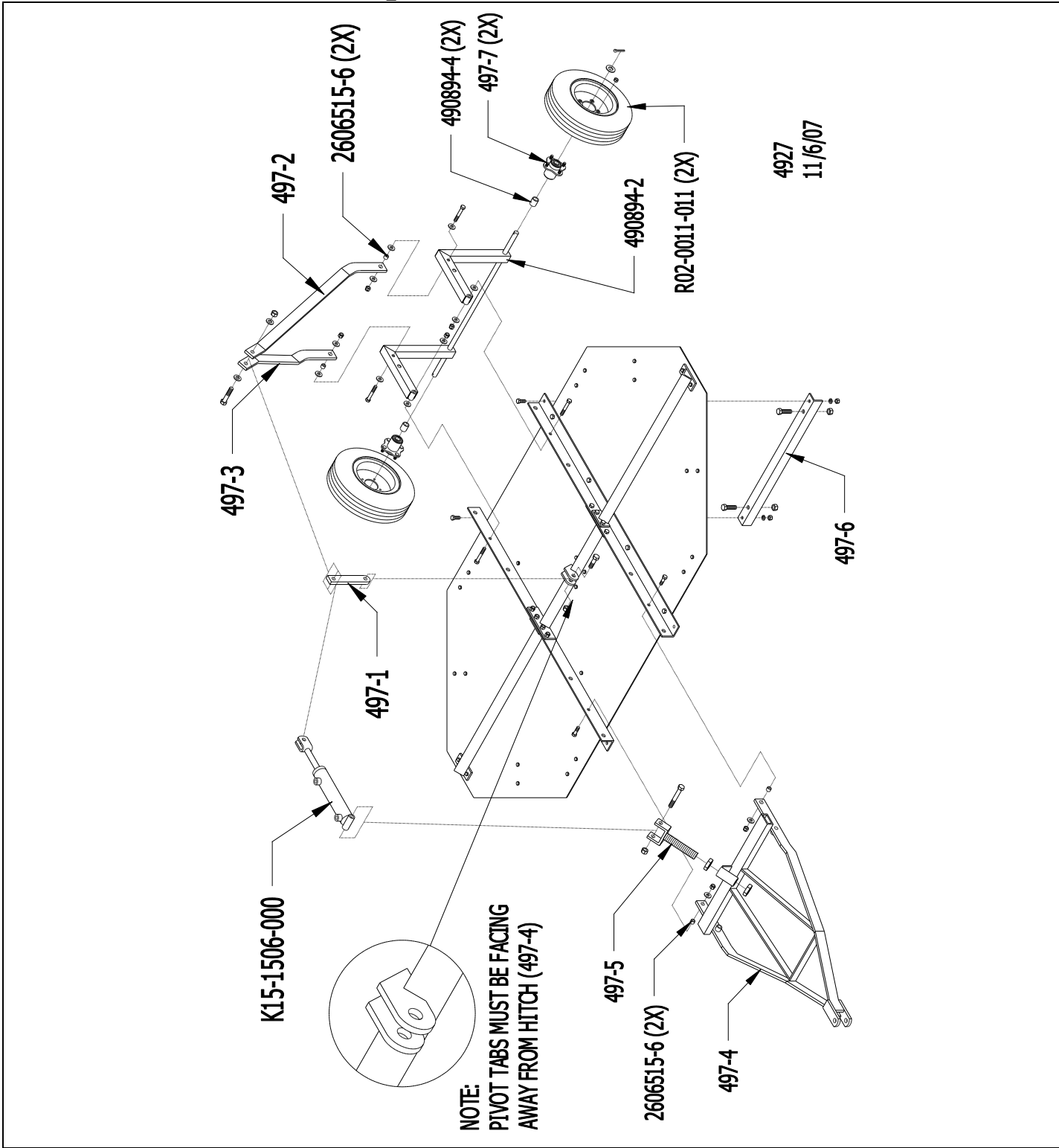

Drawings: 4927-A, 4927-H, 4927-Assembly, 4927  
 November 6, 2007  
 (4927) mw  
 Printed in the USA