



# Parts List & Instructions

815 Rice Lake Street, Owatonna, MN 55060

Phone: 800-443-2476 / 507-451-5430

www.gandy.net / Email: sales@gandy.net

**6640FS16F**  
**Orbit-Air Applicator**  
**Implement Mounted Hopper**  
**Hydraulic Raven Monitor Controlled**  
**40 Cu. Ft. (1.13m<sup>3</sup>), 32.1 Bushel, 1800-Lb Chemical Capacity,**  
**w/16 (1-1/4") Openings, Red Metering Wheels**  
**For Use w/ 1-1/4 inch I.D. Tubing**  
**Single Shaft (No Clutch)**  
**(All Parts & Hardware in Place Unless Otherwise Specified)**

**Following Parts Are Shipped Inside Hopper:**

- 1 ..... 0197102-1 ..... Manual Holder Bracket
- 2 ..... L04-0005-000 ..... Cable Tie (5/16 x 15-1/4)
- 1 ..... M10-0005-004 ..... Manual Holder
  
- 1 ..... L07-0063-484 ..... Wheel Speed Sensor
- 1 ..... L07-0063-829 ..... Console
- 1 ..... L07-0115-651 ..... Grain Flow, 10 Ft, 22 Pin
- 1 ..... L07-0115-652 ..... Grain Flow Cable, 12 Ft, 22 Pin
  
- 1 ..... 642-A ..... Parts Carton Containing:
- 1 ..... 6216-D ..... Air Pressure Gauge Carton:
- 1 ..... 662-C ..... Run Hold Switch Carton Containing:

## Maintenance

**Check all bolts for tightness after first two hours of use; check periodically thereafter.**

**Grease all fittings regularly.**

There are **Two** grease fittings on this hopper. These **must** be greased before use and periodically during use.

Locations: See page 14.

One grease fitting on each 1-inch bearing (D05-1000-010) (two) located on the 1-inch drive shaft (62851-22).

Lucubrate chains as needed.

Periodically clean intake screen on hydraulic driven blower.

See Raven Operator's Manual for operating and wiring instructions.

- 1..... S02-0001-034.....Shipping Crate (23/31 CF Hopper)  
 Use: 4 Hex Bolt (3/8 x 2-3/4) (C03-0375-111)  
 8 Wrought Washer (3/8) (C02-0375-030)  
 4 Whiz Flange Nut (3/8) (C01-0375-030)
- 1..... 62240-1B.....Hopper, 23/31 CF (Painted Black)  
 Use: 2 Sight Window (610851/26)  
 4 Rail (610851/27)  
 12 Pop Rivet (3/16 x 3/8) (C19-0187-030)  
 1 Decal, Important, Metering Wheel (N02-0062-040)  
 2 Decal, Caution (N02-0014-010)  
 1 Decal, Caution Black on Yellow (N02-0062-050)  
 1 Decal, Caution Plug (N02-0062-051)
- 1..... 62243-1.....Roof 40 CF  
 Use: 2 Carriage Bolt (3/8 x 1-1/2) (C04-0375-061)  
 2 Wrought Washer (1/2) (C02-0500-030)  
 2 Whiz Flange Nut (3/8) (C01-0375-030)  
 20 Carriage Bolt (5/16 x 3/4) (C04-0312-031)  
 20 Whiz Flange Nut (5/16) (C01-0312-030)  
 2 Decal, Orbit-Air Small (N02-0001-123)  
 2 Decal, Gandy Diamond (N02-0001-124)
- 2..... 62243-2.....Roof Brace (40 CF)  
 Use: 8 Hex Bolt (5/16 x 3/4 Stainless) (C03-0312-031)  
 16 SAE Washer (5/16 Stainless) (C02-0312-021)  
 8 Nylon Lock Nur (5/16 Stainless) (C01-0312-041)
- 2..... 62240-4.....Bushing Mount (For Out Side Hinge)  
 Use: 2 Carriage Bolt (3/8 x 2) (C04-0375-080)  
 2 Whiz Flange Nut (3/8) (C01-0375-030)
- 2..... 62200-22.....Screen Support Bracket  
 Use: 4 Carriage Bolt (5/16 x 3/4) (C04-0312-031)  
 4 Whiz Flange Nut (5/16) (C01-0312-030)
- 1..... 62240-3.....Cover (For 23/31/40 CF Hopper)  
 Use: 2 Carriage Bolt (3/8 x 1-1/4) (C04-0375-051)  
 2 Wrought Washer (3/8) (C02-0375-030)  
 2 Jam Lock Nut (3/8) (C01-0375-062)
- 1..... M05-0000-004.....Rubber Latch w/ Keeper  
 Use: 4 Pop Rivet (C19-0187-000)
- 2..... 62852-3.....Inner Hinge  
 Use: 2 Hex Bolt (3/8 x 1) (C03-0375-041)  
 4 Jam Nut, Nylon Lock (3/8) (C01-0375-062)  
 8 Wrought Washer (3/8) (C02-0375-030)
- 2..... 62852-4.....Outer Hinge  
 Use: 4 Wrought Washers (3/8) (C02-0375-030)  
 4 Jam Nut, Nylon Lock (3/8) (C01-0375-062)
- 2..... 629069-1.....Mounting Base w/ Holes  
 Use: 16 Hex Bolt (3/8 x 1-1/4) (C03-0375-051)  
 16 Wrought Washer (3/8) (C02-0375-030)  
 16 Lock Washer (3/8) (C02-0375-010)  
 16 Whiz Flange Nut (3/8) (C01-0375-030)

1..... 62851-34..... Shaft, Gear & Driven Sprocket (43-1/4 x 5/8 Round)  
 2..... 63861-7..... Bearing, Plastic (For 5/8 Shaft)  
 4..... 09074690-4..... Flangette, Bearing (For Bearing 63861-7)  
     Use: 3 Carriage Bolt (1/4 x 5/8) (C04-0250-020)  
         4 Whiz Flange Nut (1/4) (C01-0250-030)  
         1 Carriage Bolt (1/4 x 1) (C04-0250-040)  
         1 Wrought Washer (1/4) (C02-0250-030)  
         1 Nylon Lock Nut (1/4) (C01-0250-040)  
 1..... 62851-42..... Chain Sprocket, 21-Tooth (5/8 Bore)  
     Use: 1 Cotter Pin (3/16 x 1-1/4) (C20-0187-030)  
 1..... 62853-9..... Sprocket, 24-Tooth (5/8 Bore x 1-3/8 Hub)  
     Use: 1 Cotter Pin (3/16 x 1-1/4) (C20-0187-030)  
 1..... 62851-22..... Shaft (46 x 1-inch Round)  
     Use: 1 Cotter Pin (3/16 x 1-1/4) (C20-0187-030)  
         1 SAE Washer (1-inch) (C02-1000-020)  
 2..... D05-1000-010 ..... Bearing (For 1-inch Shaft)  
     Use: 4 Hex Bolt (5/16 x 3/4) (C03-0312-030)  
         4 Lock Nut Nylon (5/16) (C01-0312-040)  
 1..... 628720-12..... Sprocket Double, 32T-35T Chain (#40 Chain) (1-inch Bore)  
     Use: 1 Hex Bolt (1/4 x 1-3/4) (C03-0250-070)  
         1 Nylon Lock Nut (1/4) (C01-0250-040)  
  
 1..... 62851-8..... Air Chamber, 16-Outlet (23/31/40 CF)  
     Use: 2 Hex Bolt (3/8 x 1) (C03-0375-041)  
         5 Hex Bolt (3/8 x 1-1/4) (C03-0375-051)  
         5 Wrought Washer (3/8) (C02-0375-030)  
         5 Lock Washer (3/8) (C02-0375-010)  
         7 Whiz Flange Nut (3/8) (C01-0375-030)  
 1..... 641-3..... Air Pressure Switch Assembly  
     Use: 2 Pan Head TC Screw (#8 x 1/2) (C07-0164-070)  
 1..... 5508242-33..... Gasket, Air Switch  
 1..... L10-0016-010..... Potting Box (Air Pressure Switch Cover)  
     Use: 2 Pan Head TC Screw (#8 x 1/2) (C07-0164-070)  
 16..... M05-0829-300..... Gasket, Mixing Chamber  
 16..... M10-0055-060..... Mixing Chamber (For 1-1/4 inch I.D. Tubing)  
     Use: 32 Hex Head Self-Tap Bolt (5/16 x 3/4) (C03-0312-032)  
 2..... M05-2000-000..... Rubber Plug (2-inch For Air Chamber)  
 1..... 62851-32..... Angle Support, For Air Chamber & Blower  
 1..... 628720-18..... Clean-Out Chute (4-inch)  
     Use: 1 Hex Nut (5/16) (C01-0312-010)  
         1 Lock Washer (5/16) (C02-0312-010)  
         1 Wrought Washer (5/16) (C02-0312-030)  
 1..... M05-3000-000..... Rubber Plug, 3-inch (For Hopper Cleanout)  
 1..... 62240-10..... Angle Clamp, Tubes (For 23/31/40CF)  
     Use: 4 Foam Clamp Strip 9-1/2 Long (62851-16)  
 1..... 5608226..... Bar Clamp, Plastic Tubing, (23/31/40 CF)  
     Use: 4 Foam Clamp Strip 9-1/2 Long (62851-16)  
         5 Hex Bolt (5/16 x 2-1/2) (C03-0312-101)  
         5 Lock Nut, Nylon (5/16) (C01-0312-040)

- 2..... 62852-16..... Mounting Bracket, Platform (23/3140 CF)  
 Use: 4 Carriage Bolt (5/16 x 3/4) (C04-0312-031)  
 4 Whiz Flange Nut (5/16) (C01-0312-030)
- 1..... 62851-10..... Platform (23/31/40 CF)  
 Use: 3 Grip Tape (3 x 48-1/2 Long) (62851-15)
- 1..... 62851-37..... Angle Support (23/31/40 CF Platform)  
 Use: 4 Carriage Bolt (5/16 x 3/4) (C04-0312-031)  
 4 Whiz Flange Nut (5/16) (C01-0312-030)
- 1..... 62851-67..... Clear Windshield (For 23/3/401 CF)  
 Use: 6 Hex Bolt (1/4 x 3/4) (C03-0250-030)  
 6 Lock Washer (1/4) (C02-0250-010)  
 6 Wrought Washer (5/16) (C02-0312-030)  
 6 Whiz Flange Nut (1/4) (C01-0250-030)
- 4..... 62851-5..... Screen (23/31/40 CF)

- 1..... 62240-8..... Bracket Long Fan Support (23/31/40 CF)  
 Use: 2 Hex Bolt (3/8 x 1-1/4) (C03-0375-051)  
 2 Wrought Washer (3/8) (C02-0375-030)  
 2 Lock Washer (3/8) (C02-0375-010)  
 2 Whiz Flange Nut (3/8) (C01-0375-030)
- 1..... 62240-9..... Bracket Short Fan Support (23/31/40 CF)  
 Use: 2 Hex Bolt (3/8 x 1-1/4) (C03-0375-051)  
 2 Wrought Washer (3/8) (C02-0375-030)  
 2 Lock Washer (3/8) (C02-0375-010)  
 2 Whiz Flange Nut (3/8) (C01-0375-030)

### Sensors & Wire Extensions

- 1..... L07-0115-456..... Console Valve Adapter Cable
- 1..... L07-0115-557..... Cable, Single Shaft, No Clutch
- 1..... 62851-28..... Mounting Bracket, Sensor  
 (Mounts to Flangette 09074690-4, Side Opposite Hyd Drive)
- 1..... 661-16..... Sensor Shaft
- 1..... 5508442-35..... Magnetic Hub, 5/8 Bore (**Installed on Metering Door Shaft**)  
 Use: 1 Cotter Pin (3/16 x 1) (C20-0187-030)

### Mount Bracket & Parts for Hydraulic Drive Motor

- 1..... 661-12..... Motor Mount (For Hydraulic Motor Drive)  
 Use: 2 Hex Bolt (5/8 x 4) (C03-0625-161)  
 2 SAE Washer (5/8) (C02-0625-020)  
 2 Lock Washer (5/8) (C02-0625-010)  
 2 Hex Nut (5/8) (C01-0625-010)  
 2 Hex Bolt (3/8 x 1-1/4) (C03-0375-051)  
 2 Wrought Washer (3/8) (C02-0375-030)  
 2 Lock Washer (3/8) (C02-0375-010)  
 2 Whiz Flange Nut (3/8) (C01-0375-030)
- 1..... F02-0041-054..... Roller Chain #41 (54-Rollers) (Hyd Motor to Drive Shaft)  
 Use: 1 Connector Link #41 (F02-0041-001)

## Hydraulic Drive Motor Assembly (6623-A)

1	K01-1022-000	Hydraulic Motor
1	09073678-4	Plate, Motor Mount
		Use: 2 Hex Bolts (3/8 x 1) (C03-0375-041)
		2 Lock Washer (3/8) (C02-0375-010)
1	661-2	Sensor Bracket
		Use: 2 Hex Bolts (3/8 x 1) (C03-0375-041)
		2 Wrought Washer (3/8) (C02-0375-030)
		2 Lock Washer (3/8) (C02-0375-010)
1	661-13	Regulator Block
		Use: 2 Socket Pipe Plug 1/4-18 NPT (C06-0250-300)
		4 Socket Head Cap Screw (5/16 x 2) (C06-0312-130)
1	L08-SV10-230	Solenoid Valve
		Use: 2 Terminal, 14-16ga, Male #634005 (L03-0009-090)
1	661-11	Sensor, Sprocket
		Use: 1 Hex Bolt (1/4 x 3/4) (C03-0250-030)
		1 Lock Washer (1/4) (C02-0250-010)
		1 Whiz Flange Nut (1/4) (C01-0250-030)
1	661-7	Sprocket, 13-Tooth (1-inch Bore w/ 1/4 Keyway)
		Use: 1 Key (1/4 x 1) (5408320-25)
1	661-6	Bushing (1-1/8 O.D. x 1/2 Long)
1	661-4	Sprocket, 20-Tooth (7/8 Bore)
		Use: 2 Spring Pin (1/8 x 1-3/4) (C23-0125-200)
1	661-5	Collar, Hydraulic Speed Comp Drive
		Use: 1 Hex Bolt (1/4 x 1-1/4) (C03-0250-051)
		1 Lock Washer (1/4) (C02-0250-010)

## Hydraulic Valve Assembly (6623-B)

1	L07-0063-195	Hydraulic Control Valve, 16 GPM	
		Use: 3 Apt SAE 10, Male 1/2 NPT, Female Swivel (K04-0500-010)	
1	661-15	Bracket, Motor Control (For 10 & 23/31 Cu Ft Hopper)	
		Use: 2 Hex Bolt (5/16 x 3/4) (C03-0312-030)	
		2 Lock Washer (5/16) (C02-0312-010)	
		2 Whiz Flange Nut (5/16) (C01-0312-030)	
2	K02-0500-120	Hydraulic Hose, 1/2 x 120"	
3	K02-0500-014	Hydraulic Hose, 1/2 x 14" w/ O-Ring Fitting On One End	
1	K02-0500-012	Hydraulic Hose, 1/2 x 12" w/ Fitting	
1	K02-0500-021	Hydraulic Hose, 1/2 x 21"	
1	K04-0500-030	Adaptor, 1/2-NPT Swivel Female to Male	
1	K07-0500-010	Steel Pipe Tee (1/2)	
1	K09-0500-000	90° High Pressure Sp Elbow (1/2)	
1	K11-0500-028	Steel Pipe Nipple (1/2 x 1-13/16)	
1	<b>62113</b>	<b>Hydraulic By-Pass Block Assembly w/Check Valve</b>	
	1	K05-CV10-200	Check Valve
	1	6296-1	Hydraulic By-Pass Block

## Metering Door Assembly

1	6216-F	Metering Door Assembly, 16 (1-1/4) Red Wheels:
1	62851-24	Meter Door, 16 Outlets Use: 2 J-Bolt (5/16) (C16-0312-020) 2 Wrought Washer (5/16) (C02-0312-030) 2 Hex Nut (5/16) (C01-0312-010)
4 Ft.	M05-0125-050	Rubber Strip w/ Adhesive (1/8 x 1/2)
16	M10-0001-100	Metering Cup (1-1/4) Use: 36 Whiz Flange Nut (3/16) (C01-0187-030)
16	62851-76	Hole Closures, Standard 4 Hole Use: 16 Comp Spring (E00-0420-012) 16 Extruded Washer (628720-20) 16 SAE Washer (5/16) (C02-0312-020) 16 Hex Bolt (5/16 x 1-3/4 <b>Stainless</b> ) (C03-0312-071)
16	M10-0001-040	Metering Wheel Red
32	62851-72	Wear Plate, Stainless
1	62851-3	Shaft (41-15/16 x 5/8 Hex)
2	63861-7	Bearing, Plastic (5/8 Bore)
1	62851-4	Center Bearing, Plastic (1-inch Bore)
1	22904-8	Journal Line Shaft (For Center Bearing)
6	C02-0750-020	SAE Washer (3/4)
6	09074690-4	Flangette, Bearing (For Bearing 63861-7) Use: 6 Hex Bolt (1/4 x 3/4 <b>Stainless</b> ) (C03-0250-015) 6 Lock Washer (1/4 <b>Stainless</b> ) (C02-0250-012) 6 Whiz Flange Nut (1/4 <b>Stainless</b> ) (C01-0250-032)
1	62851-41	Sprocket 21-Tooth, (5/8 Bore) Use: 1 Cotter Pin (3/16 x 1-1/4) (C20-0187-030)

1..... K02-0375-024 .....Hydraulic Hose, 3/8 x 24” (Case Drain)

## Hydraulic Blower Assembly

### 1..... 62167-P8LH .....Blower Assembly, 8 GPM Hydraulic Motor, w/out Hoses

- 1 ..... B56-08636 .....Blower Housing, Front & Back Set (Black Plastic)
  - Use: 14 Hex Bolt (1/4 x 3/4) (C03-0250-030)
  - 28 SAE Washer (1/4) (C02-0250-020)
  - 14 Lock Nut, Nylon (1/4) (C01-0250-040)
- 1 ..... 5608636-4.....Back-Up Plate
  - Use: 4 Carriage Bolt (3/8 x 1-1/4) (C04-0375-051)
  - 4 Lock Nut, Nylon (3/8) (C01-0375-041)
- 1 ..... 62167-2.....Mount, Blower (Plastic w/Coupler)
  - Use: 1 Decal, Warning Rotating Parts (N02-0055-010)
  - 1 Decal, Important Hydraulic Motor (N02-0062-043)
  - 1 Decal, Black on Yellow (N02-0062-050)
- 1 ..... L01-0034-004.....Fan, Impeller
  - Use: 1 Bushing (1-inch JA Bore) (L01-0033-002)
- 1 ..... 5408320-25.....Key, Fan Shaft (1/4 x 1)
- 1 ..... 62167-3.....Shaft (6 Inch Long)
- 1 ..... 24078179-11.....Key, for Coupler (3/16 sq. x 1)
- 1 ..... K18-M024-000.....Coupler (9/16 x 7/8)
  - Replacement Parts .....(K18-M024-003 Black Plastic Coupler Sleeve) (5508230-5 1/8 x1 Key)
  - (K18-M024-004 Coupler for 9/16 Shaft on Hyd Motor)
  - (K18-M024-005 Coupler for 7/8 Shaft on End of Fan Shaft)
- 1 ..... K01-0045-003 .....Hydraulic Motor, 8-GPM Casappa
  - Use: 2 Carriage Bolt (3/8 x 1-1/4) (C04-0375-051)
  - 2 Washer, Motor Side, Stainless (62164-2)
  - 2 Lock Nut, Nylon (3/8) (C01-0375-041)
- 2 ..... D05-1000-030 .....Bearing & Locking Collar (For 1-inch Shaft)
- 4 ..... D10-1000-011 .....Flangette, Round
  - Use: 6 Carriage Bolt (5/16 x 1) (C04-0312-040)
  - 6 Lock Washer (5/16) (C02-0312-010)
  - 6 Hex Nut (5/16) (C01-0312-010)
- 1 ..... 5608231-3.....Screen, Blower
  - Use: 3 Pan Head Sheet Screw (#10 x 3/4) (C07-0187-090)
- 1 ..... 5508336-7.....Guard, Blower Shaft
  - Use: 2 Hex Head Self-Tap Bolt (5/16 x 3/4) (C03-0312-032)

**The Following Three Packages Shipped Inside Hopper:**

**1.....642-A .....Parts Carton**

- 8 ..... 09071598-5.....Stud Bolt (5/8 x 13-1/2)
- 8 ..... 550828-3.....Bar Clamp
- 4 ..... 550829-4.....Blank Plate (to Close off Unused Openings on Air Chamber)
- 4 ..... 62852-20.....Blank Plate (to Close off Unused Openings on Metering Door)

**1 ..... 642-BH.....Hardware Bag**

- 16..... C01-0625-010.....Hex Nut (5/8)
- 16..... C02-0625-010.....Lock washer (5/8)

**1.....6216-D .....Air Pressure Gauge Carton:**

- 1 ..... K17-P734-001 .....Air Pressure Gauge 4-inch
- 1 ..... 62851-46.....Mounting Bracket, Air Pressure Gauge
- 1 ..... 62851-47.....Clamp Bracket
- 2 ..... K04-0250-375 .....Adapter Plastic, (1/4 MPT x 3/8 HB)
- 4.5 Ft ..... M06-0375-000.....Tubing 3/8 I.D. x 1/8 Wall (54-inches Long)
- 1 ..... C03-0312-041.....Hex Bolt (5/16 x 1)
- 1 ..... C01-0312-030.....Whiz Flange Nut (5/16)

**1.....662-C .....Run Hold Switch Carton Containing:**

- 1 ..... Parts Bag .....Containing the Following:

- 1 ..... F03-0500-028 .....Sash Chain #50, 28 Links Long
- 2 ..... M11-0001-000.....S-Hook

**1 ..... Run Hold Switch Assembly:**

- 1 ..... 62150-20.....Run Hold Mount
  - Use: 3 Hole Plug (3/8) (J03-0375-000)
- 1 ..... L05-0001-001 .....Switch, Snap Action
  - Use: 2 Slot Rd Hd Mach Screw (#6-32 x 1-1/4) (C08-0138-140)
  - 2 Shake Proof Washer (#6-32) (C02-0138-040)
  - 2 Hex Nut (#6-32) (C01-0138-010)
- 1 ..... 6611-1.....Wire Assembly, Run/Hold
  - Use: 1 Strain Relief Bushing (J04-0500-000)
- 1 ..... C16-0250-010.....Eye Bolt (1/4 x 9/16 I.D. x 2-1/2)
  - Use: 1 Bushing (62150-22)
  - 1 Fender Washer (1-1/2 O.D. (For 1/4 Bolt) (C02-0250-060)
  - 2 Hex Nut (1/4) (C01-0250-010)
  - 1 Coupling Nut (1/4) (C01-0250-101)
  - 1 Hex Bolt (1/4 x 2-3/4) (C03-0250-110)
  - 1 Compression Spring (E01-0664-4)
  - 2 Key Ring (5/8) (M11-0001-000)
  - 1 Spring (E00-0375-040)



## Cover Hinge Bolt Assembly

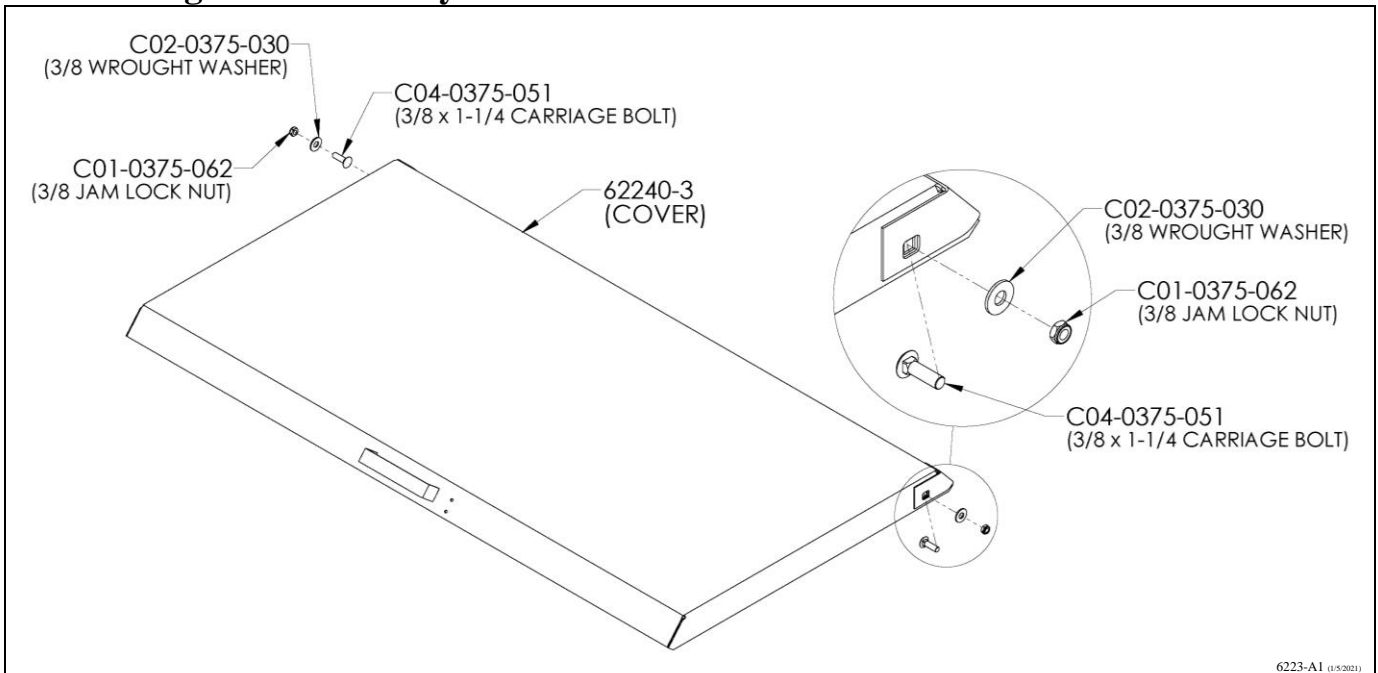

## Roof Hinge Bolt Assembly

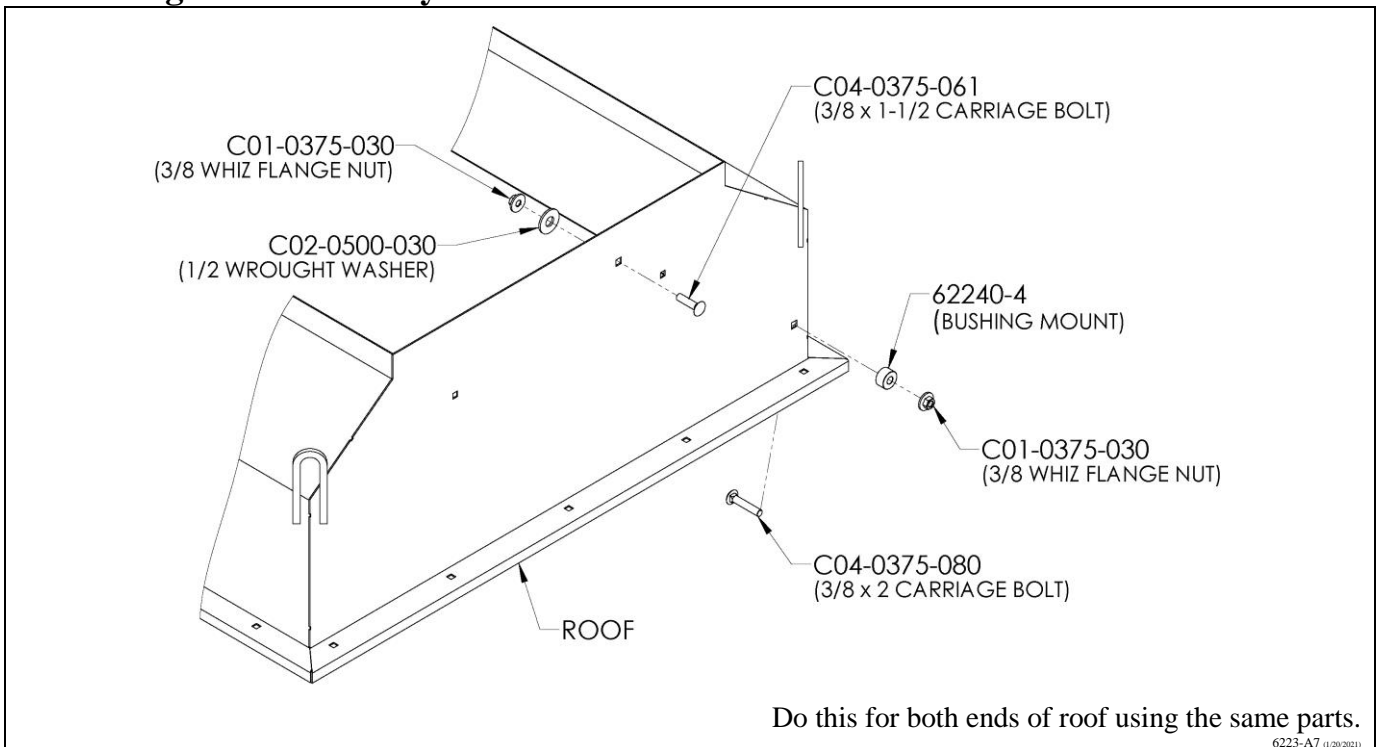

# Roof Assembly

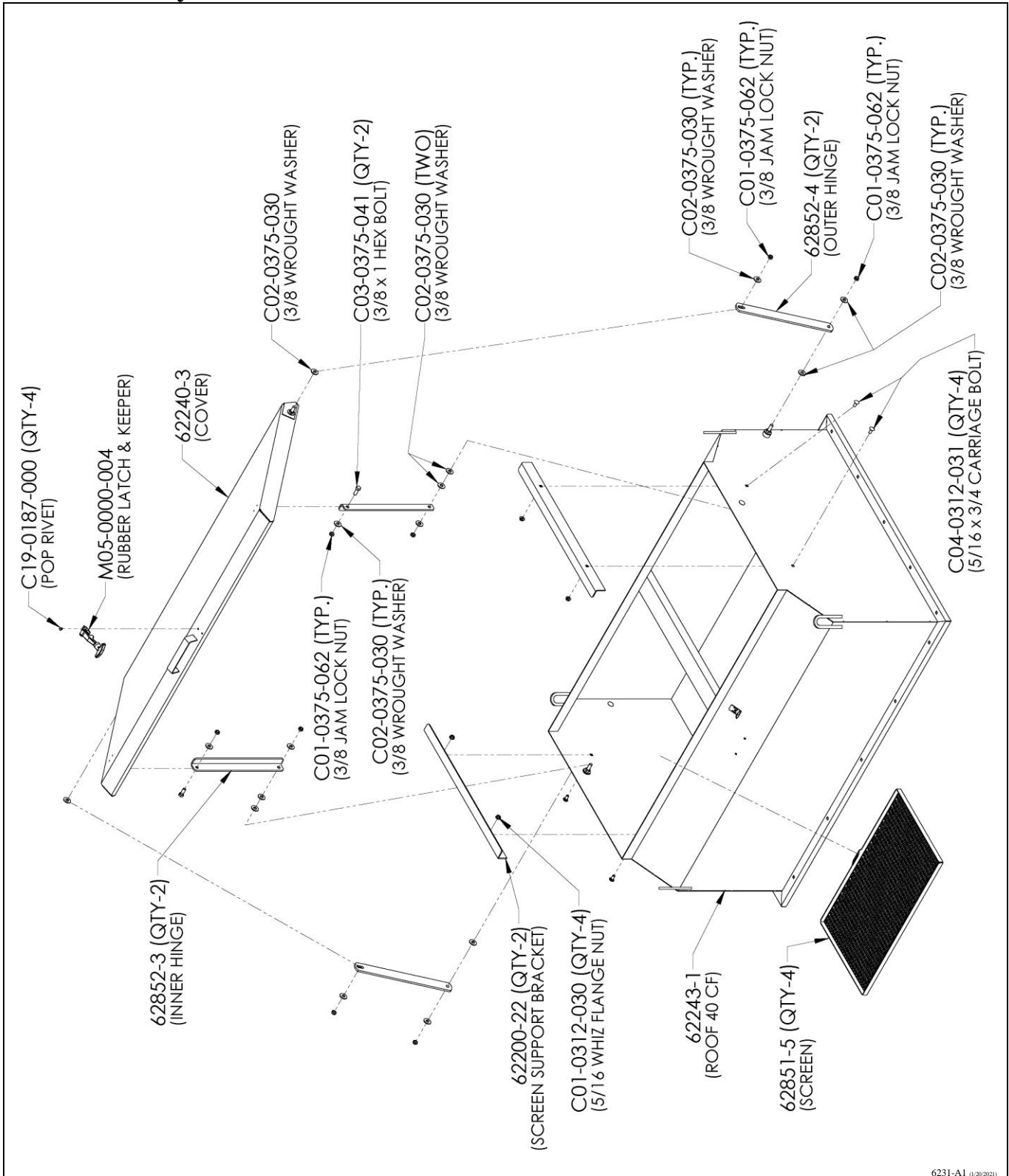

6231-A1 (1/20/2021)

## Sight Window Assembly

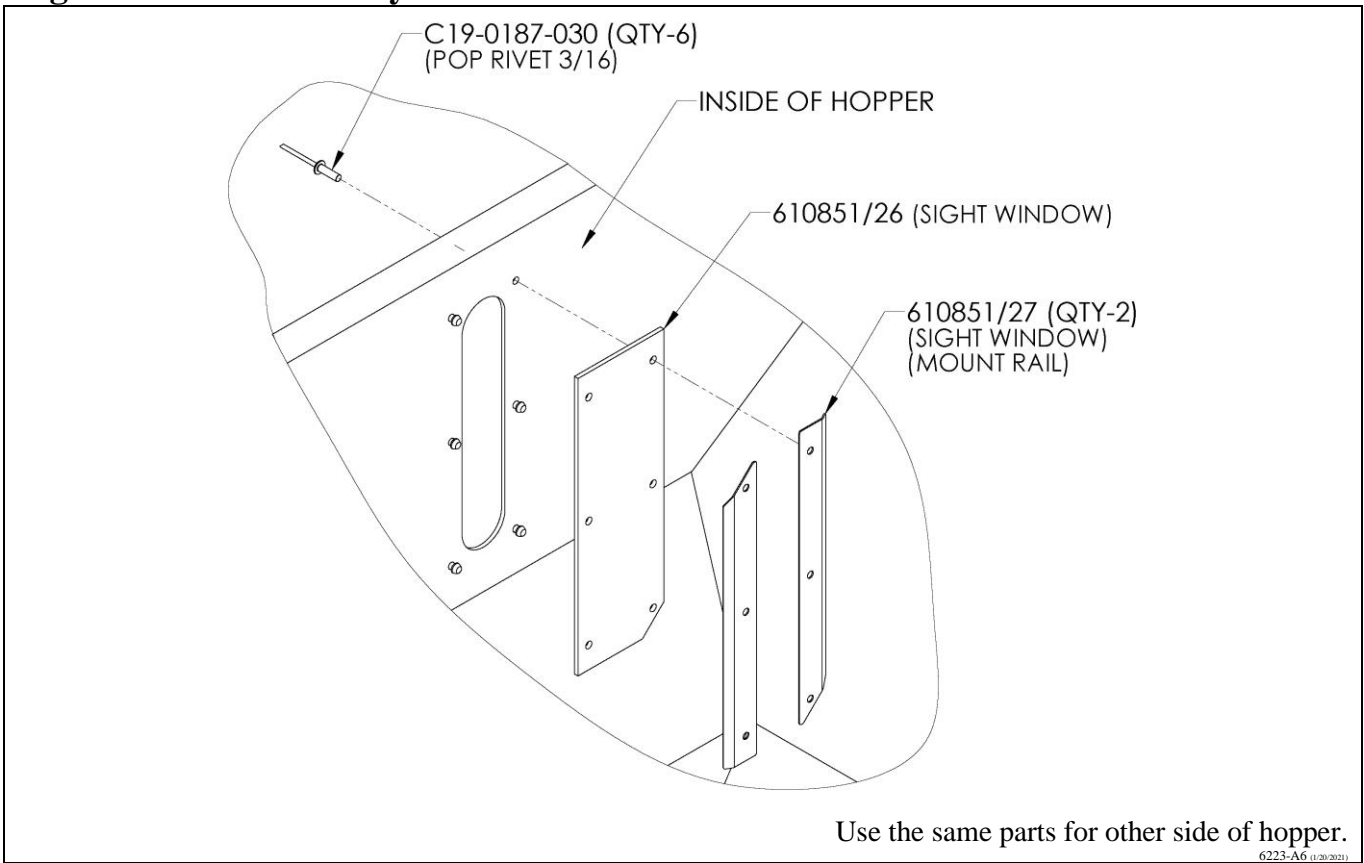

## Roof to Hopper Assembly

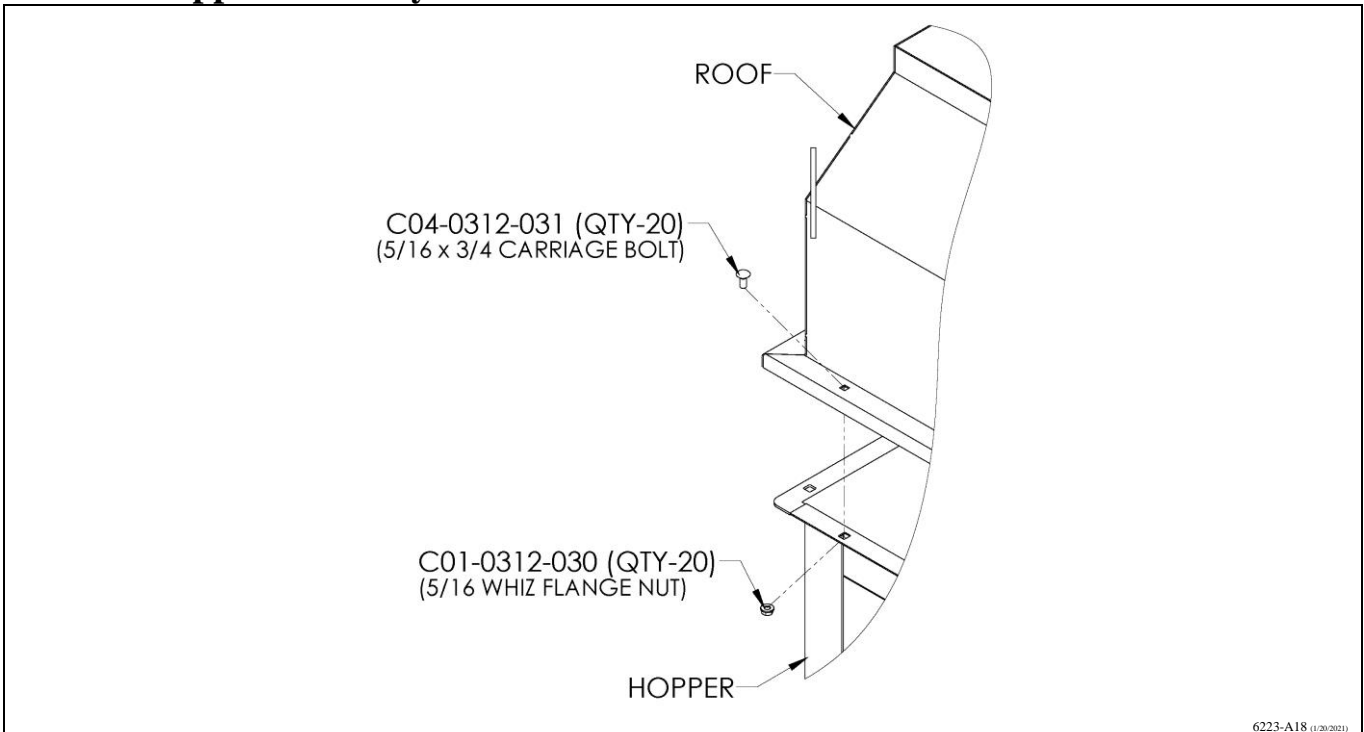

# Hopper Assembly

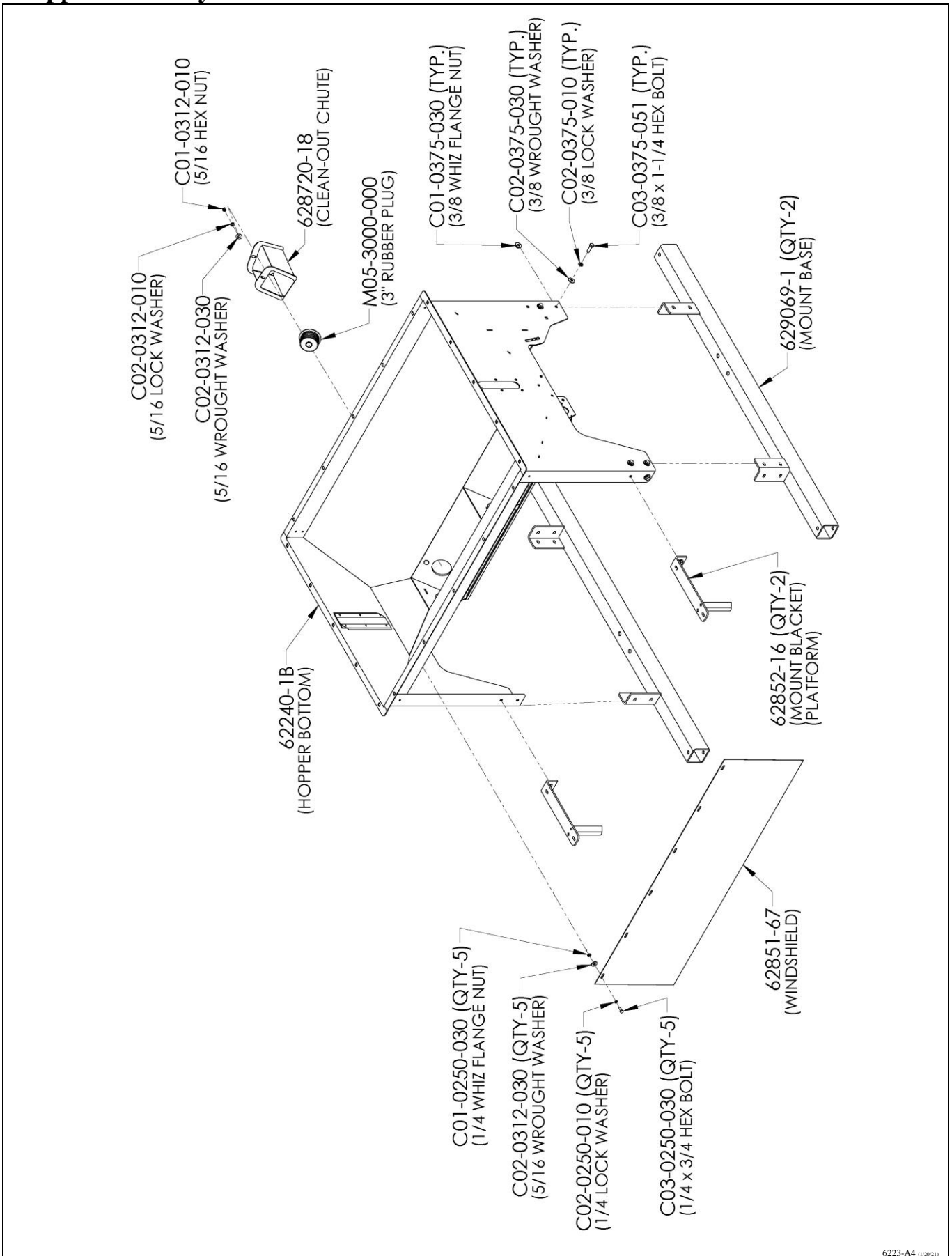

6223-A4 (1/2021)

# Hopper Assembly

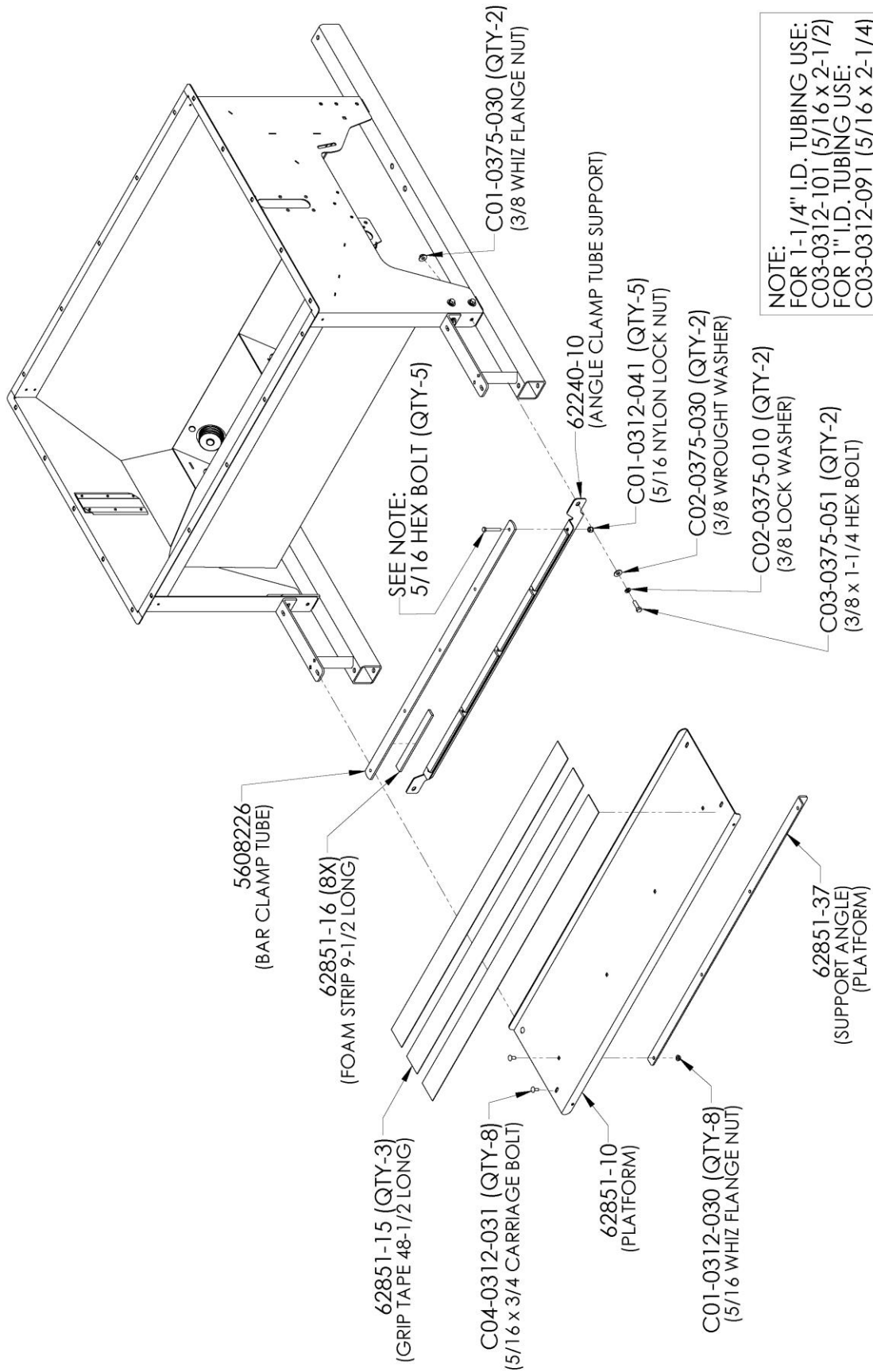

# Drive Shaft Assembly

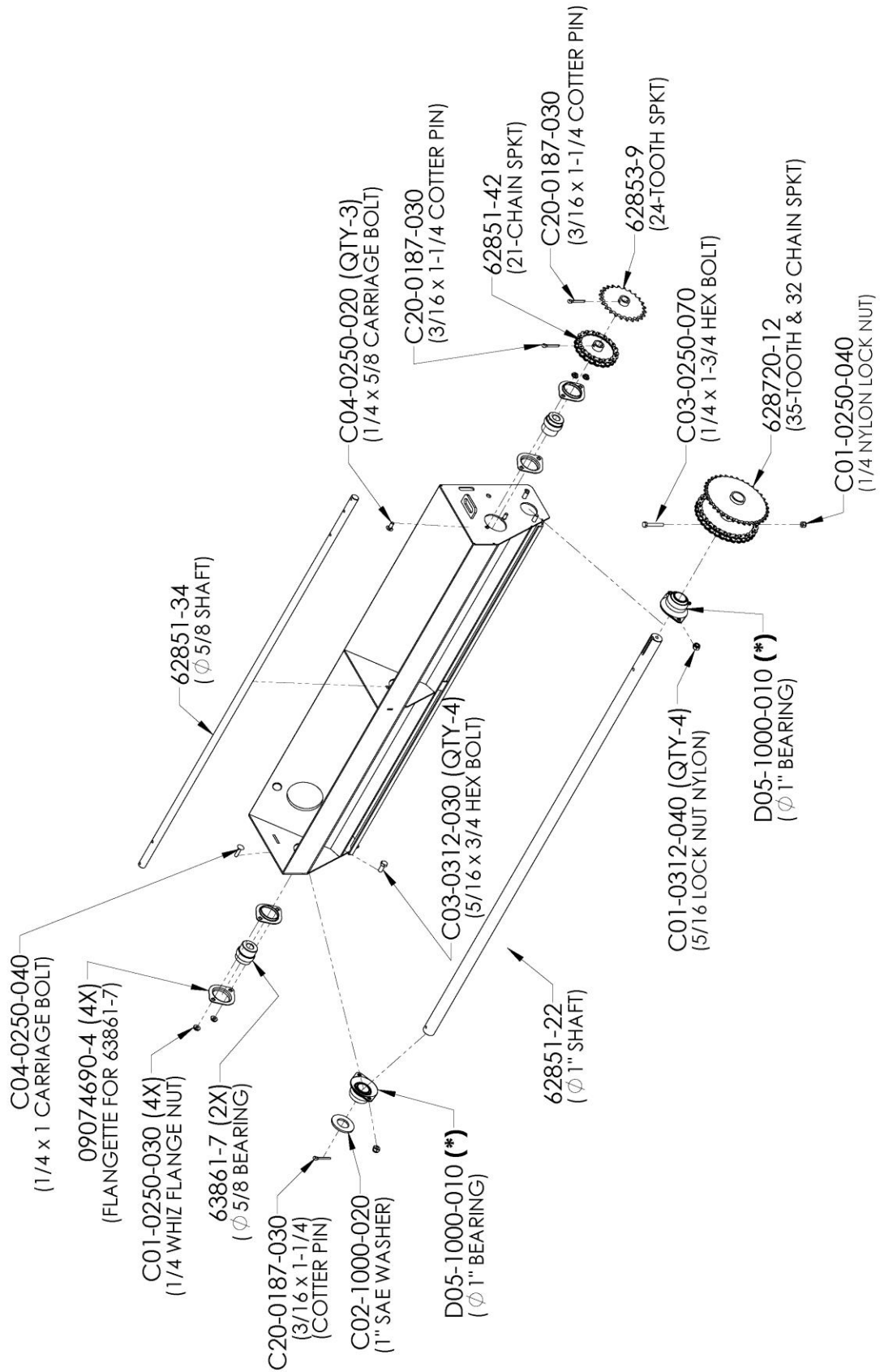

6223-A10 (1/21/2021)

**Part numbers with a (\*) behind them have grease fittings. See first page.**

# Metering Door Assembly (6216-F)

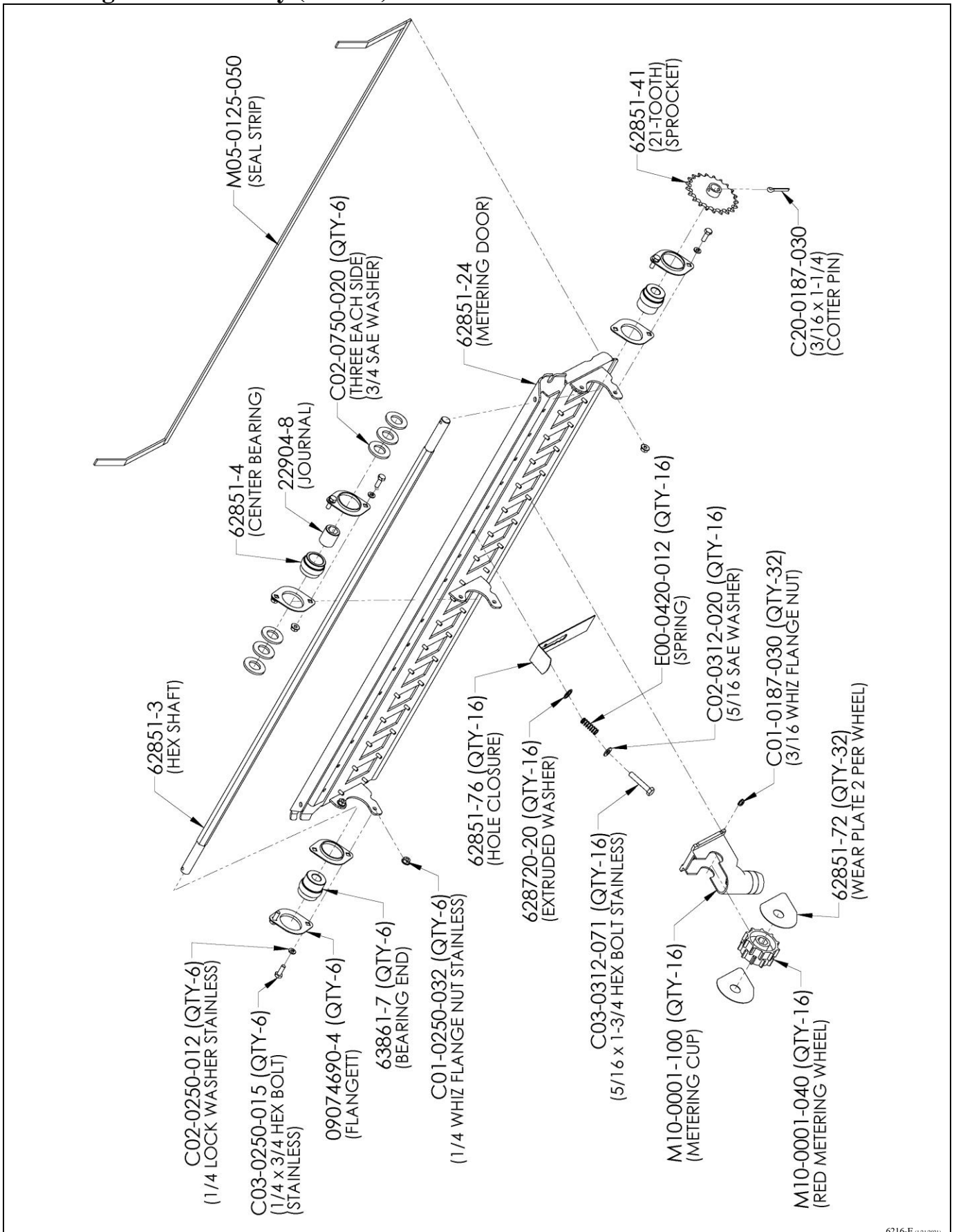

6216-F (1/21/2021)

**Fastening Metering Door in Place (use one J-Bolt on each end of metering door)**

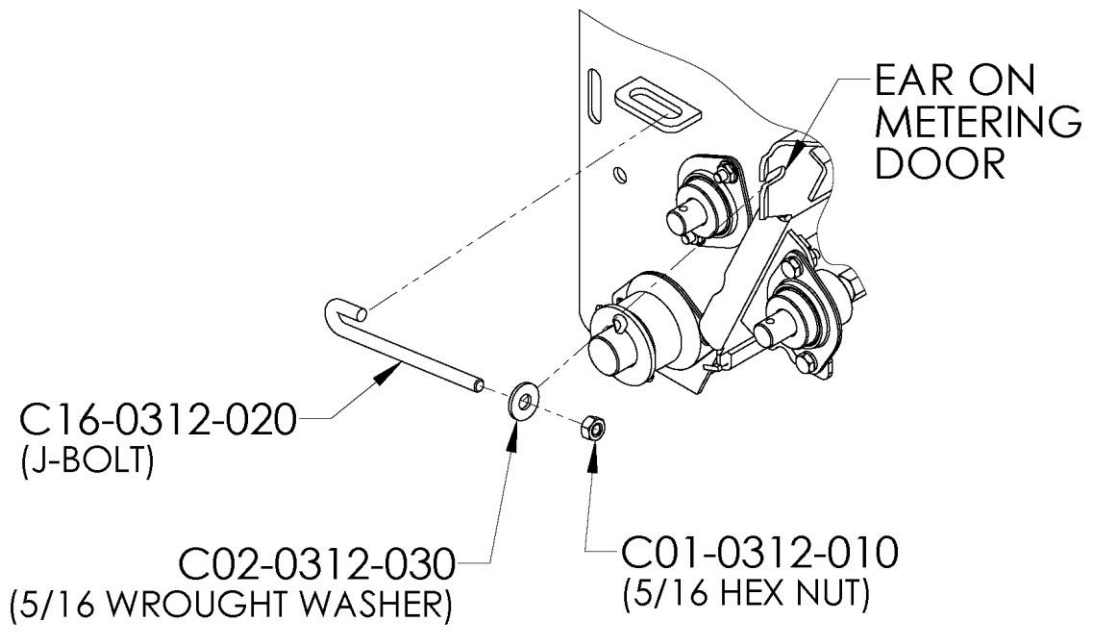

**J-bolt shown in place.**

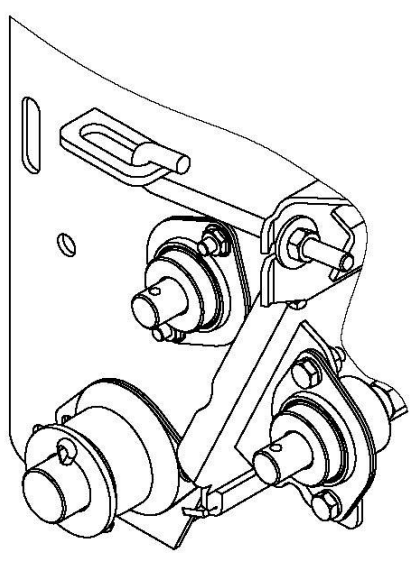



# Air Chamber Assembly

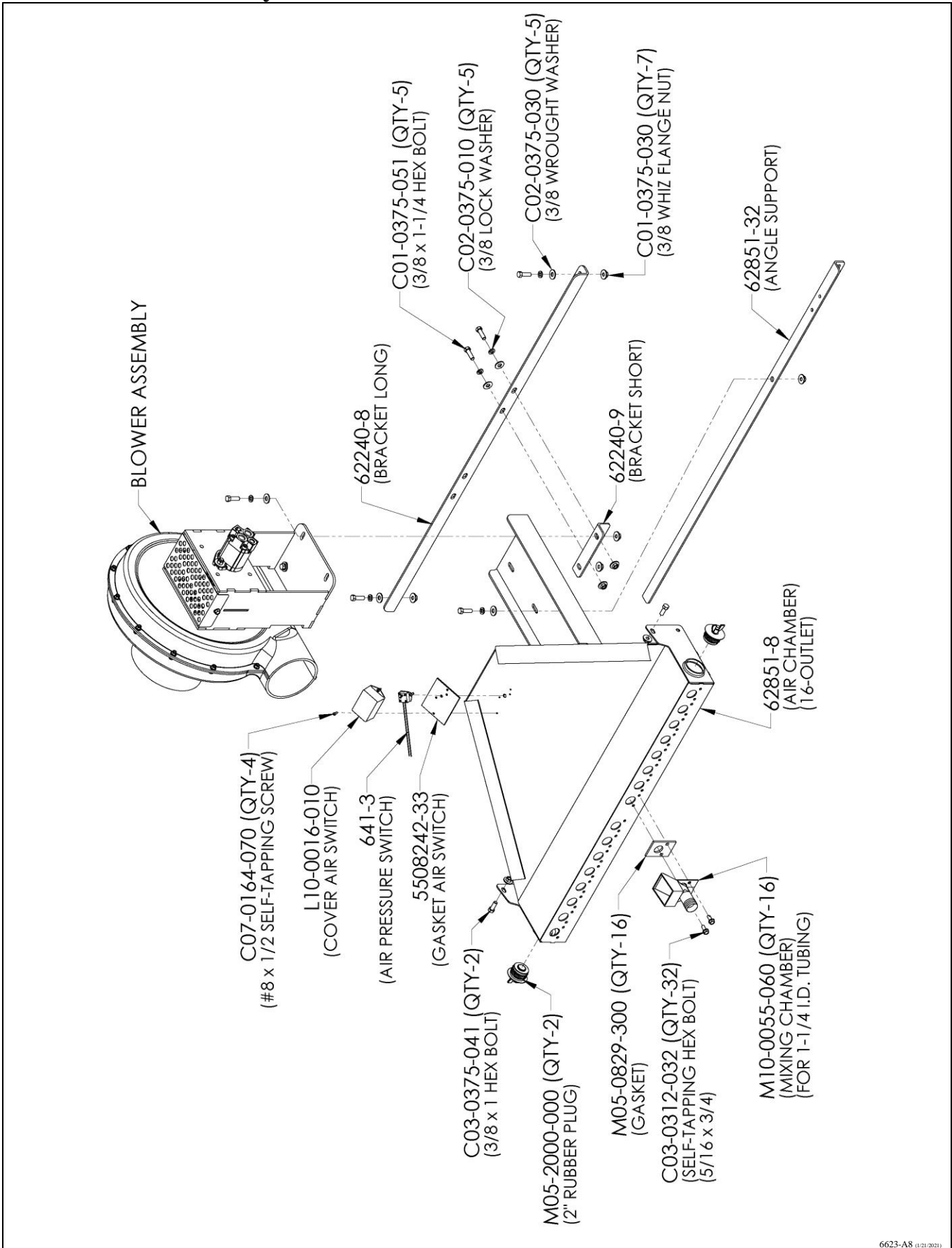

6623-A8 (1/21/2011)

# Hydraulic Blower Assembly (62167-P8LH)

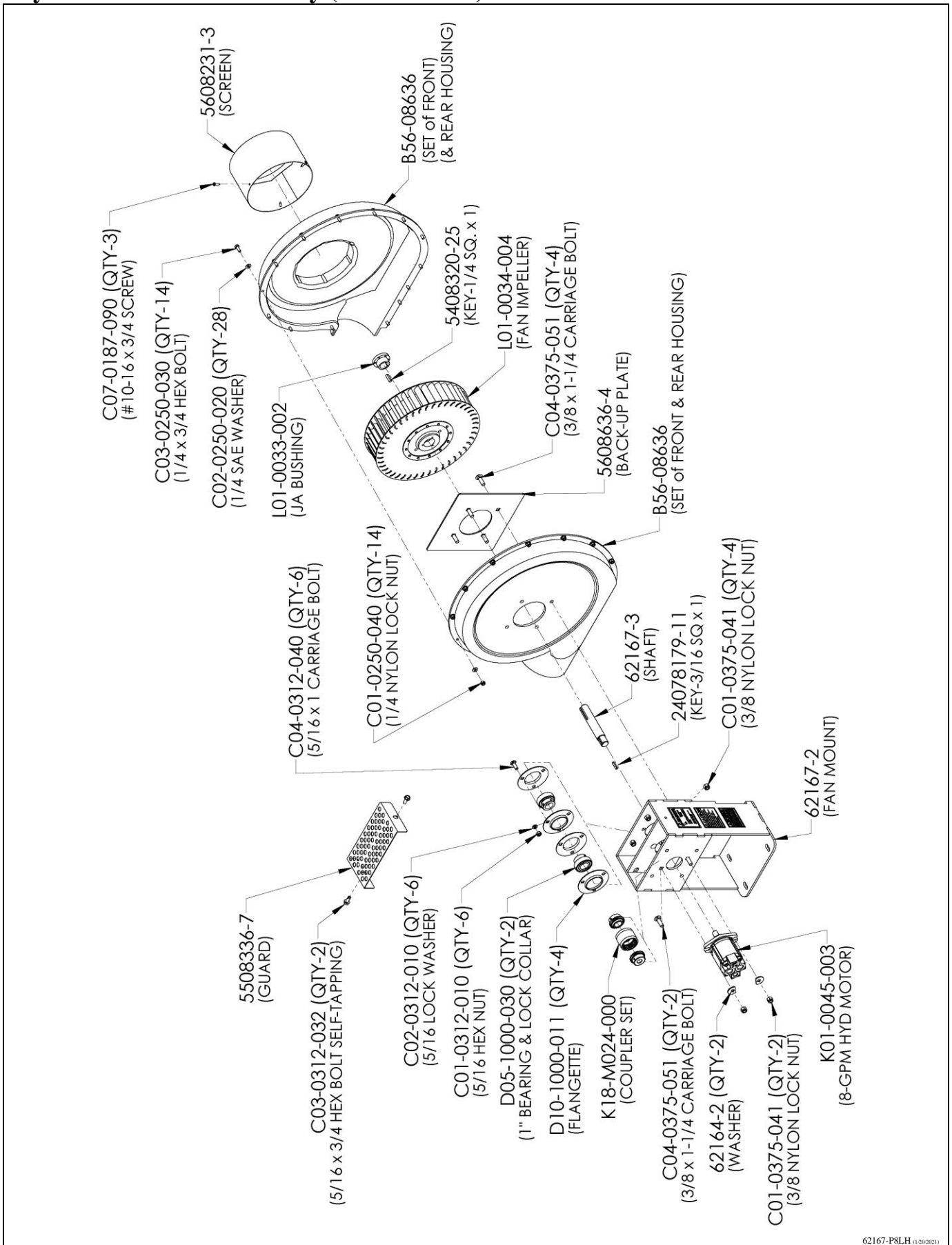

62167-P8LH (1/26/2021)

# Hydraulic Motor Assembly (6623-A)

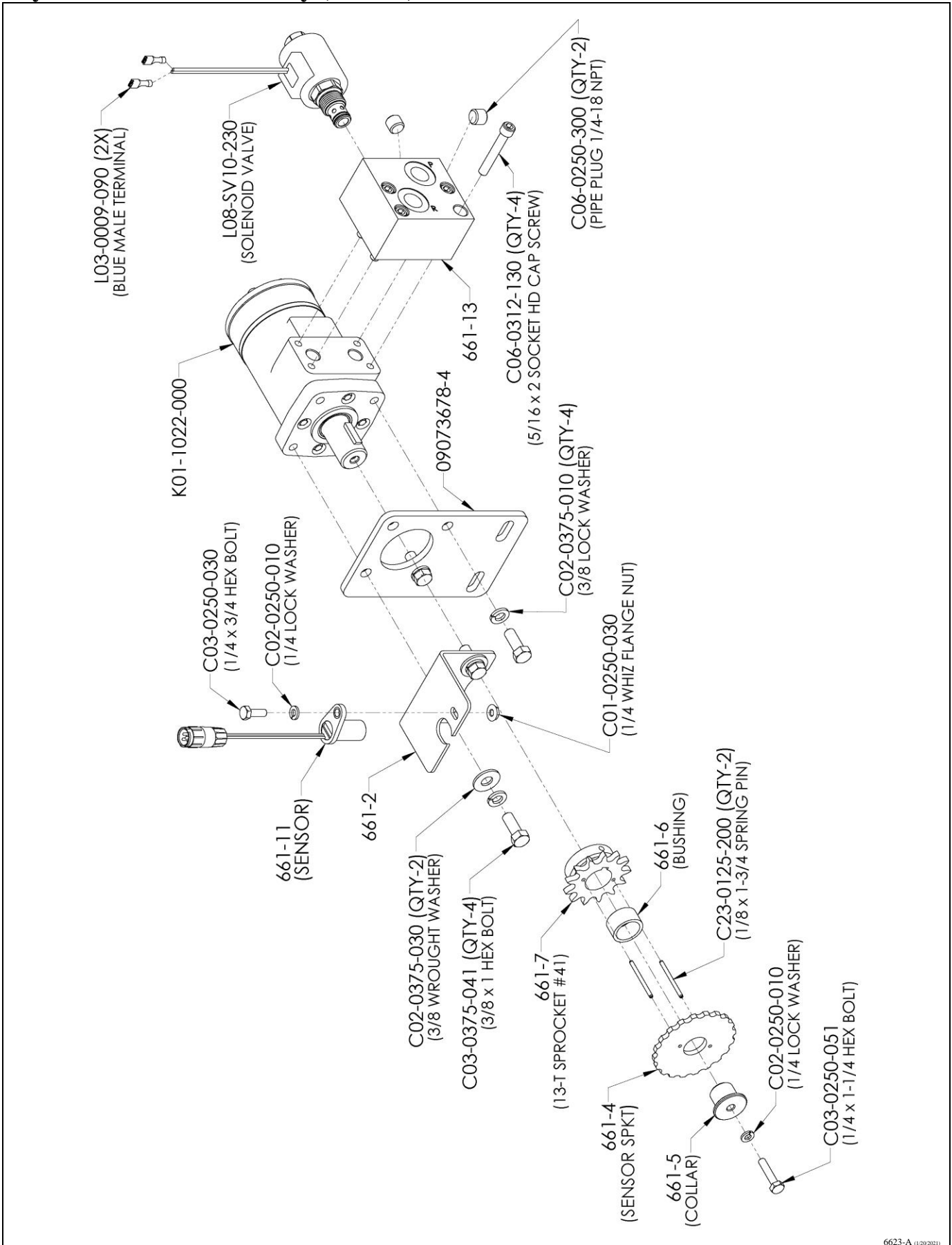

6623-A (1/20/2021)

# Hydraulic Valve Assembly (6623-B)

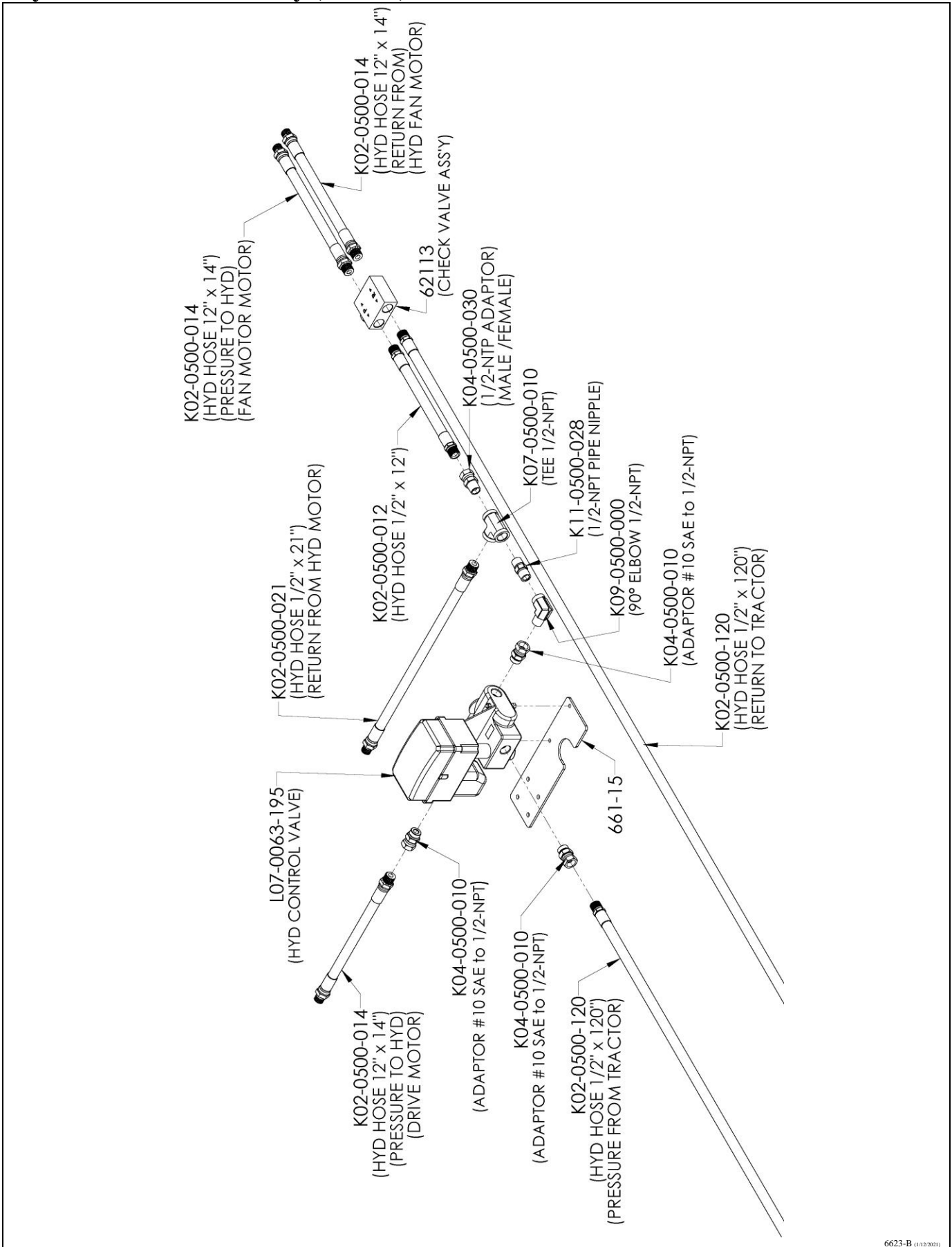

6623-B (1/12/2021)

# Hydraulic Drive Assembly

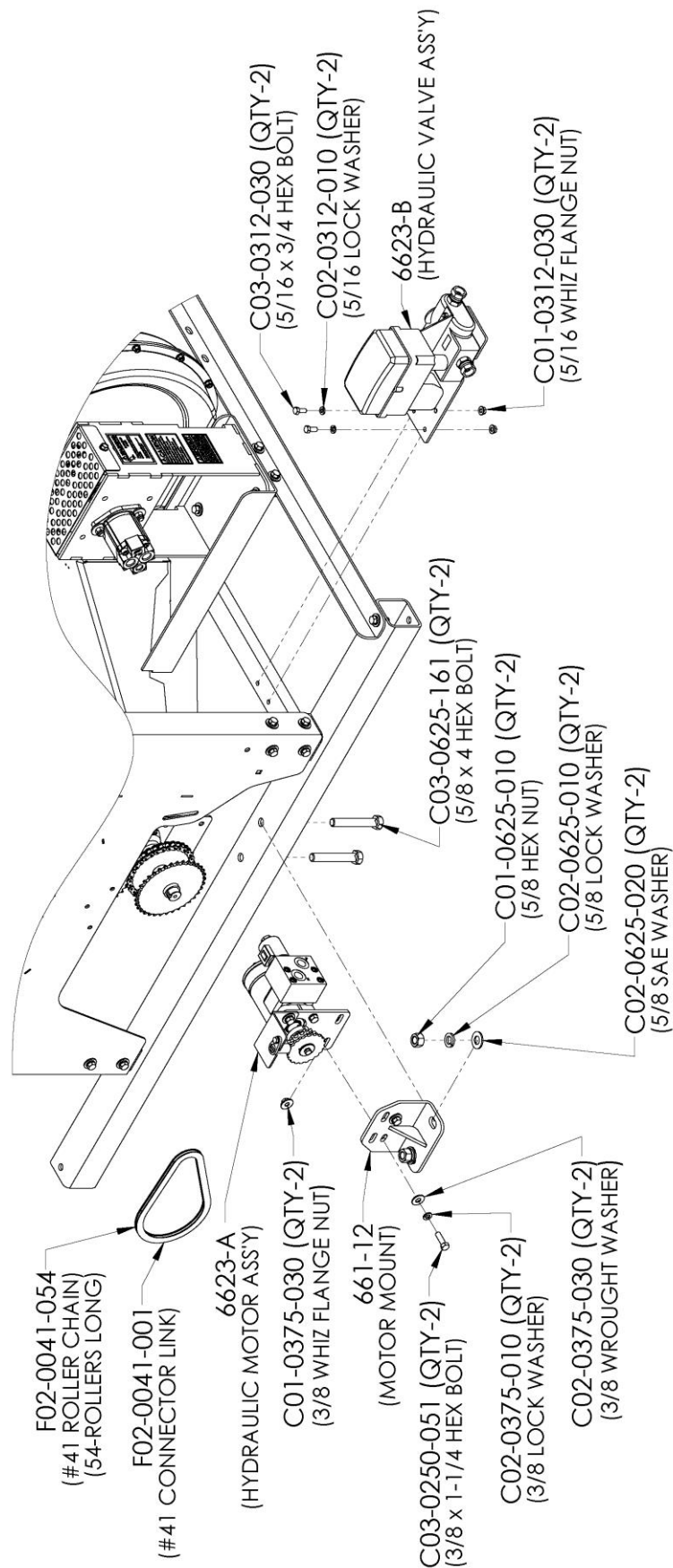

# Hydraulic Motor Hose Connections (Casappa 8-GPM Motor on Gandy Fan)

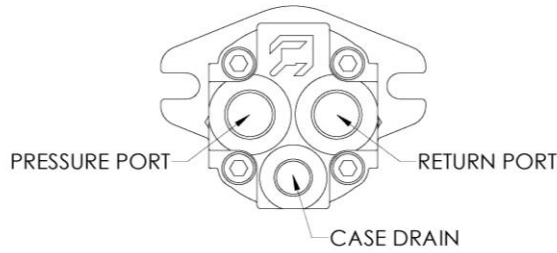

K01-0045-003 (HYD MOTOR)

**NOTE:**  
 EXTRA CASE DRAIN HOSE TO BE SUPPLIED BY CUSTOMER  
 \*\*\*\*\*USE 1/2" HOSE FOR RUNS UP TO 20-FT LONG\*\*\*\*\*  
 \*\*\*\*\*USE 3/4" HOSE FOR RUNS OVER 20-FT LONG\*\*\*\*\*

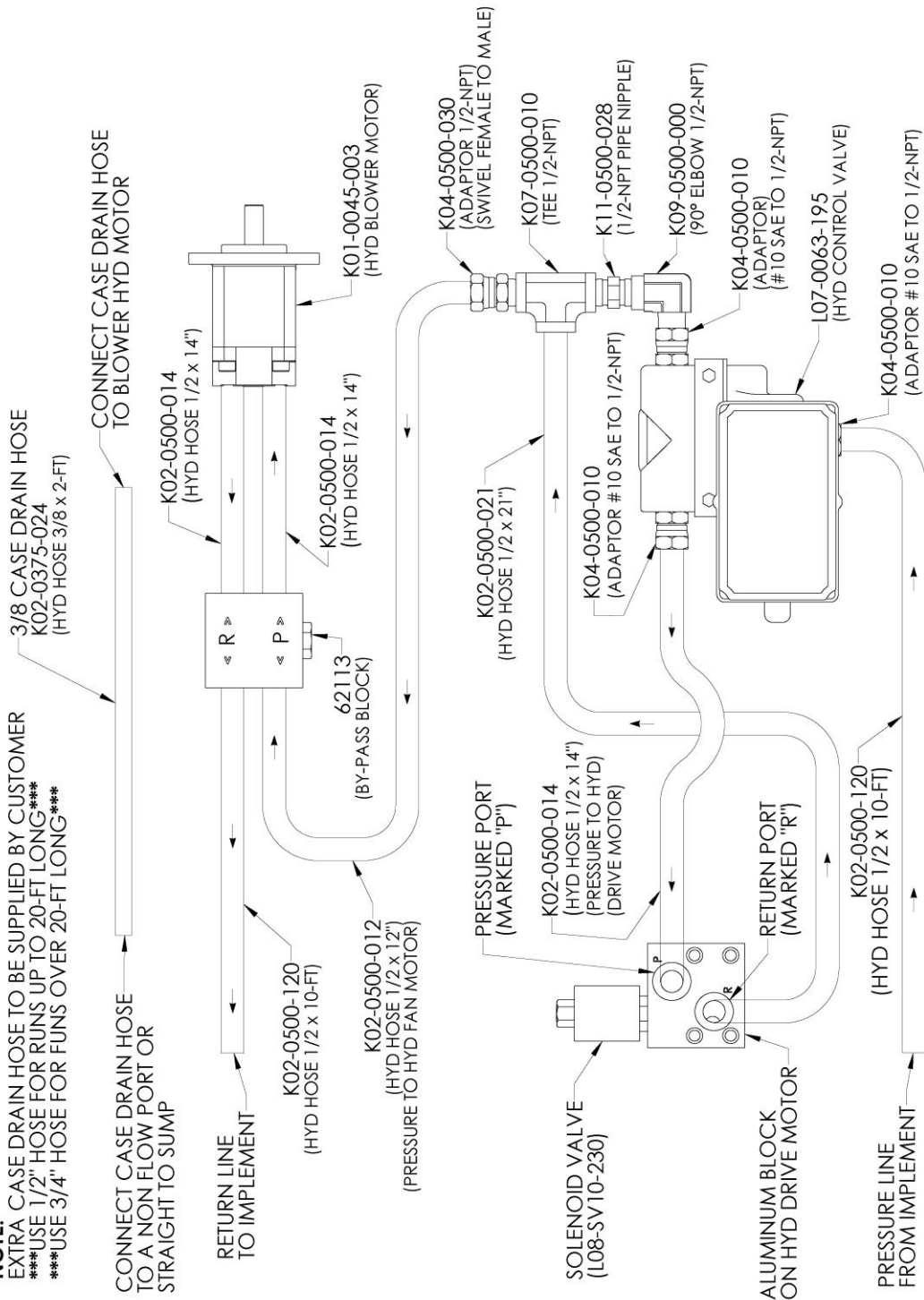

6623-B1 (1/20/2021)

# Wiring Connections for Models w/ Single Shaft No Clutch

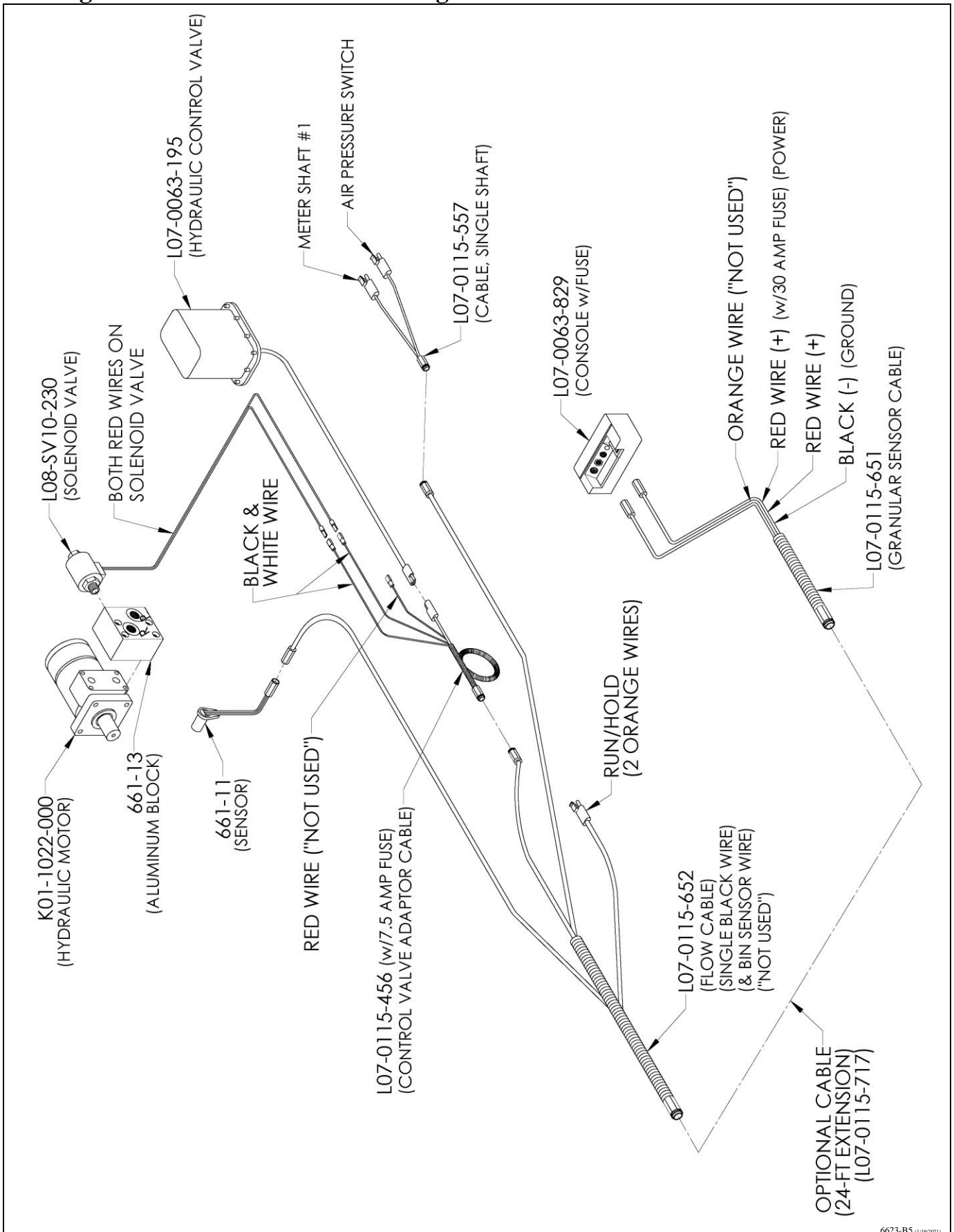

6623-B5 (1/19/2021)

## Shaft Sensor

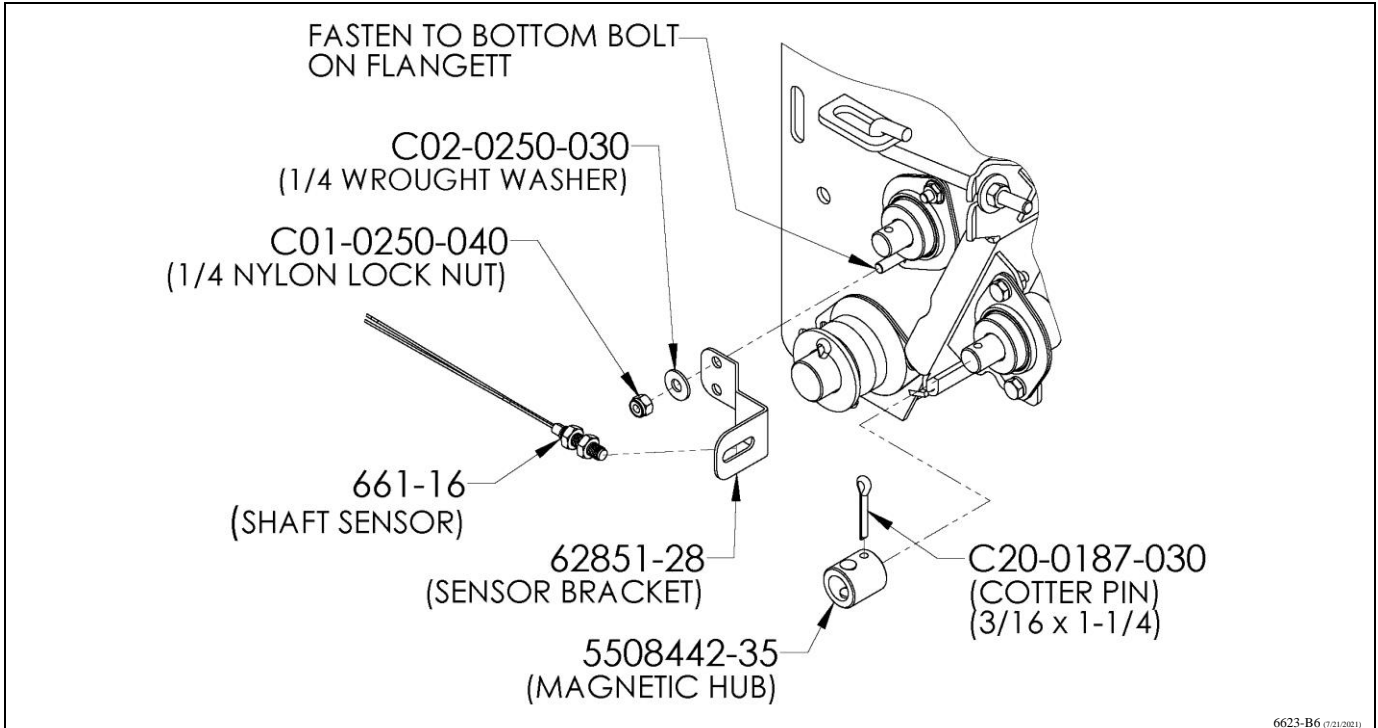

## Hydraulic Drive Sensor

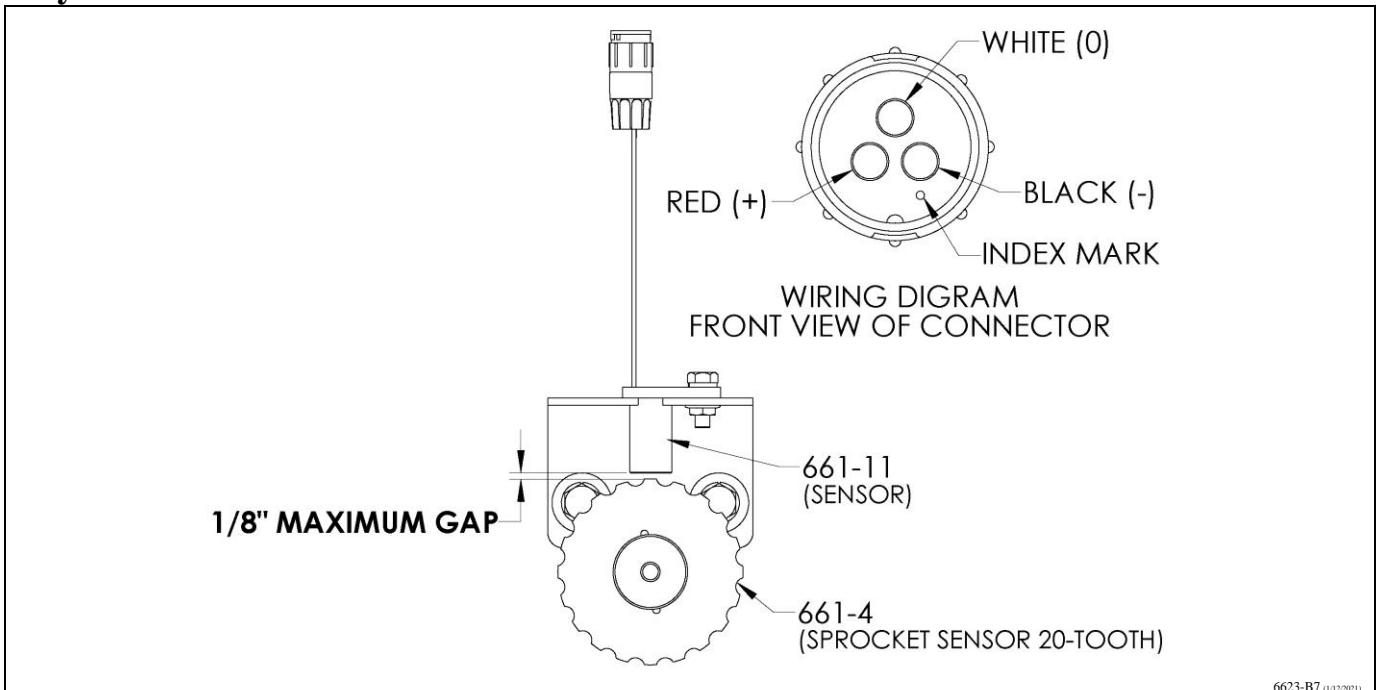



### Decal Location (Drive Side)

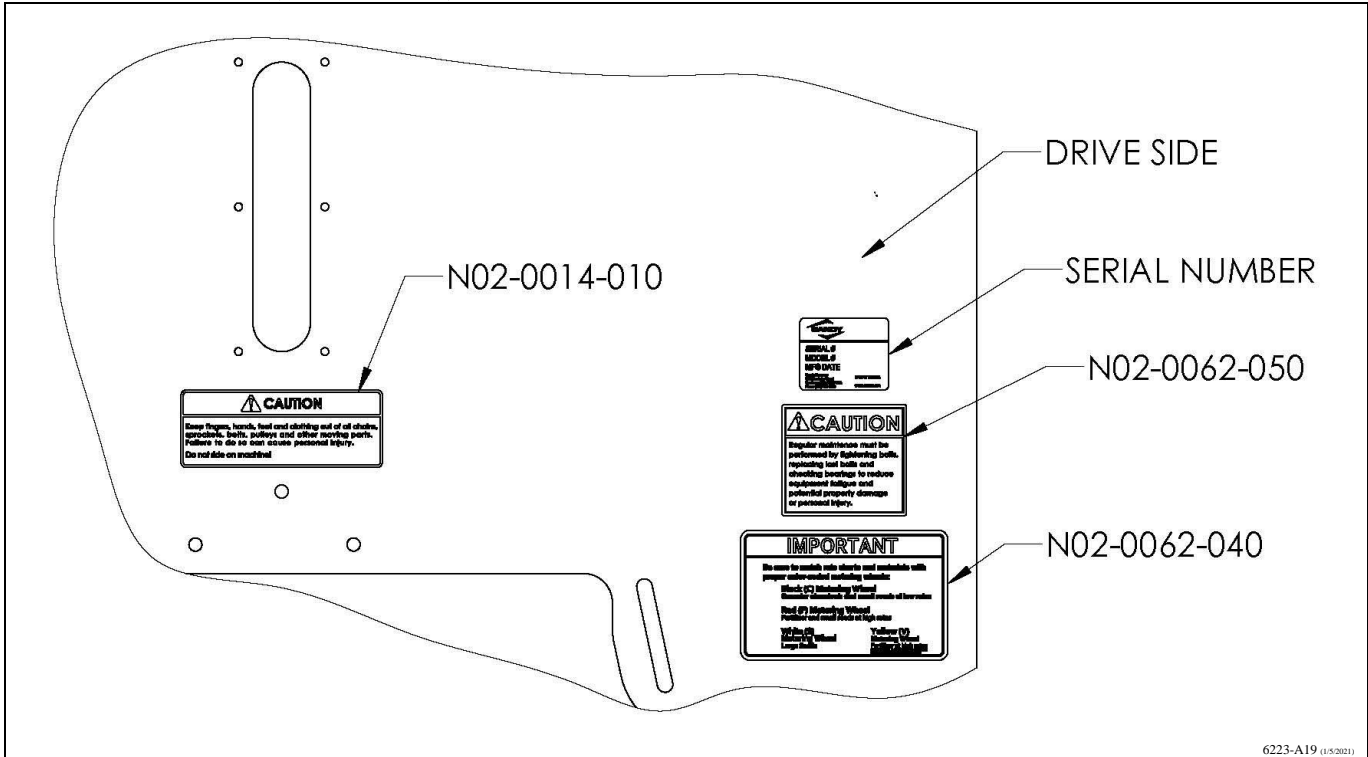

### Decal Location (Opposite Side of Hopper)

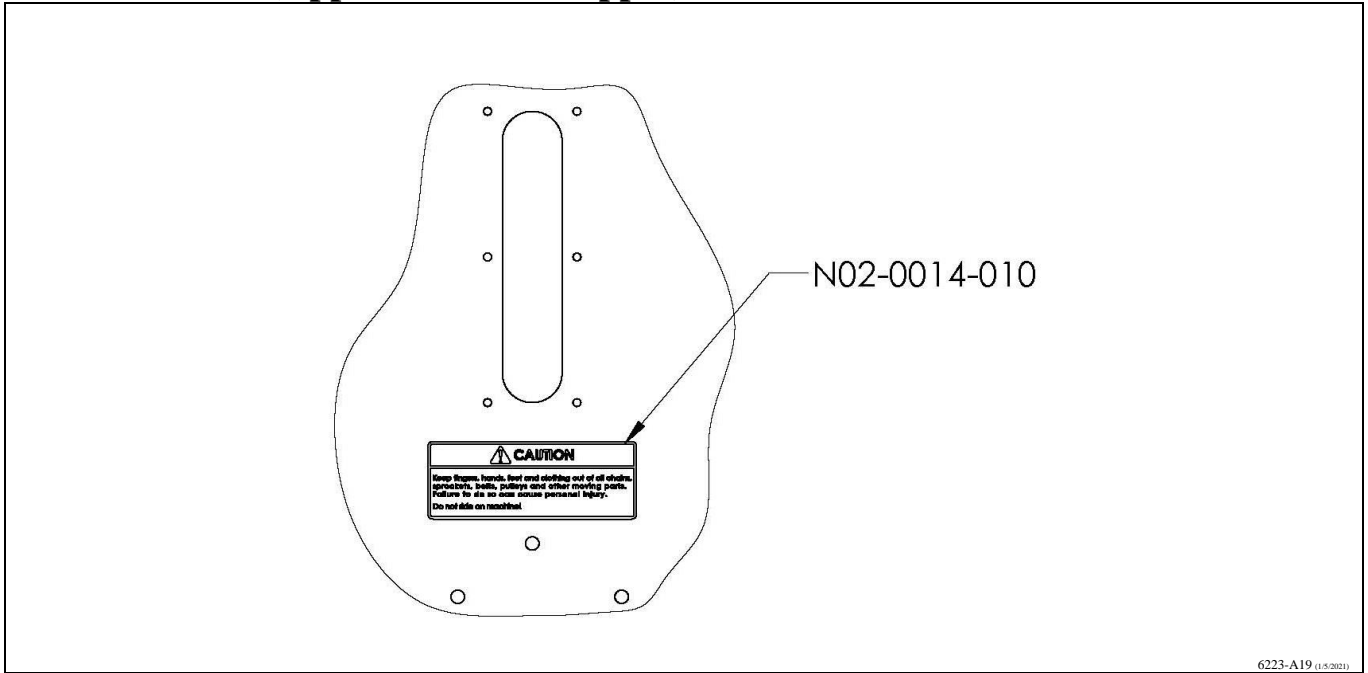

## Clean-Out Decal Location

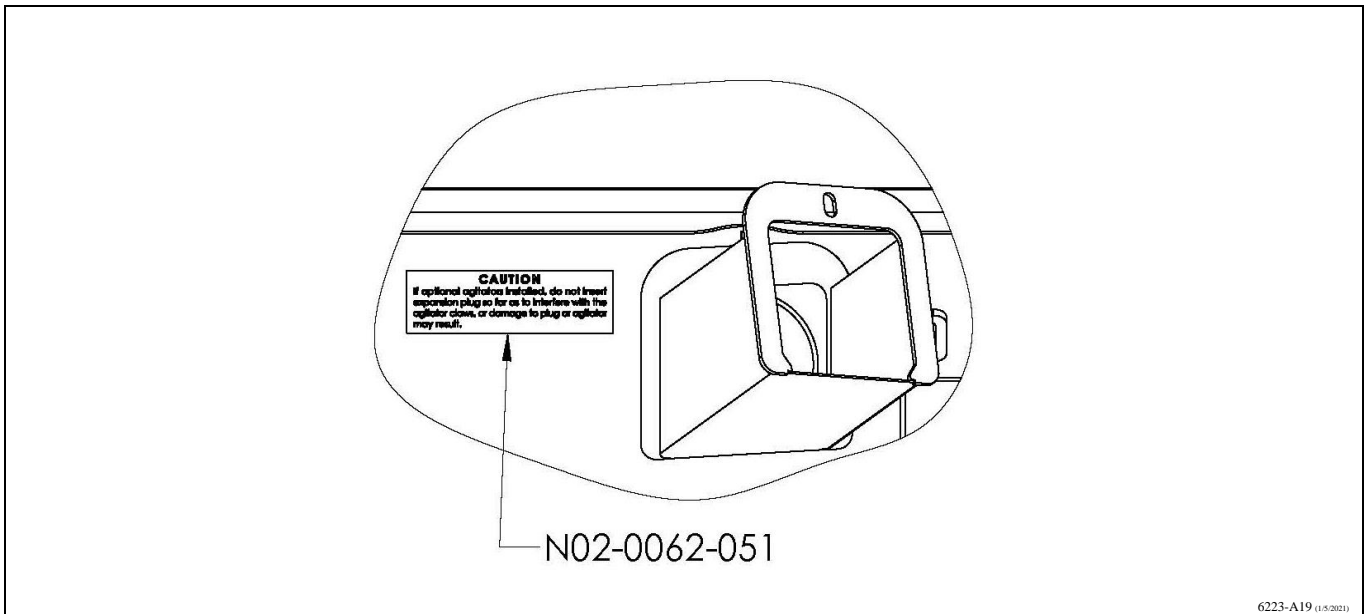

## Front & Rear & End Decals

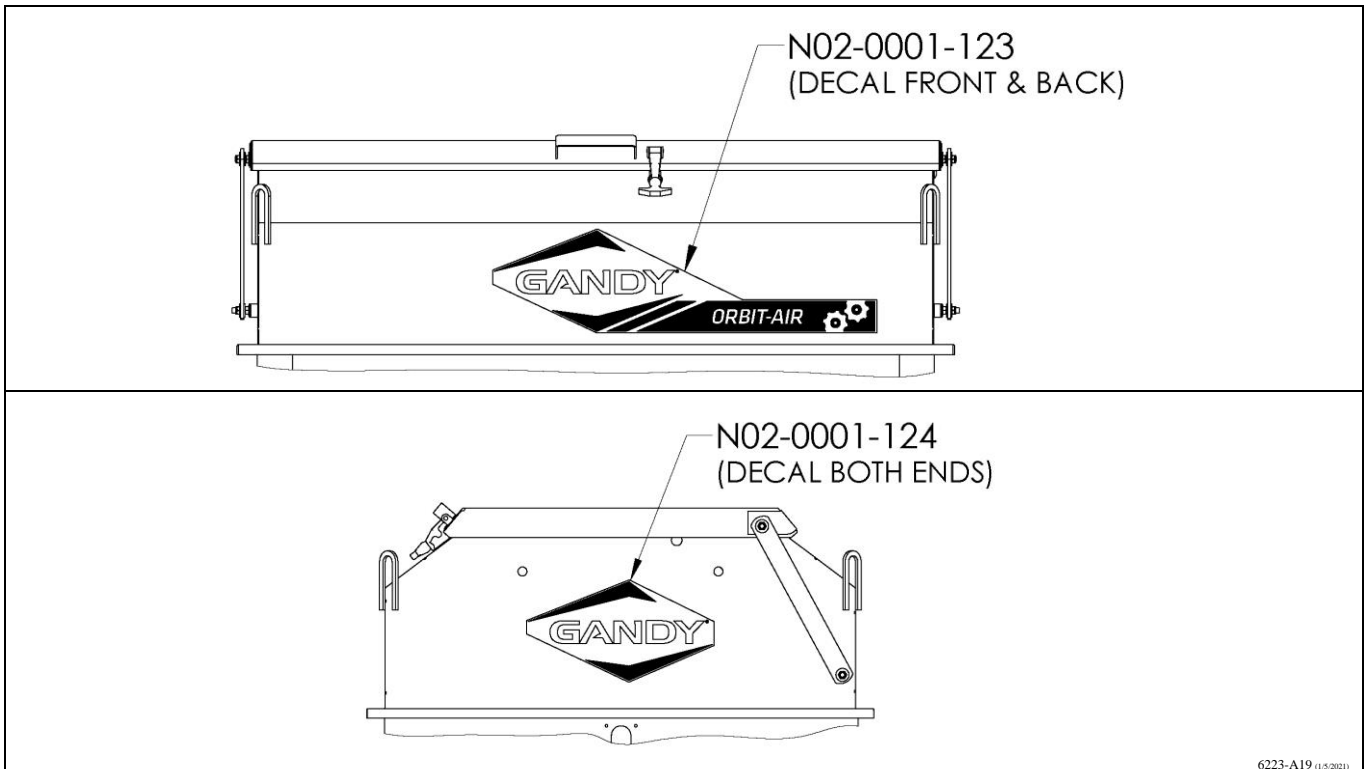

# Run Hold Switch

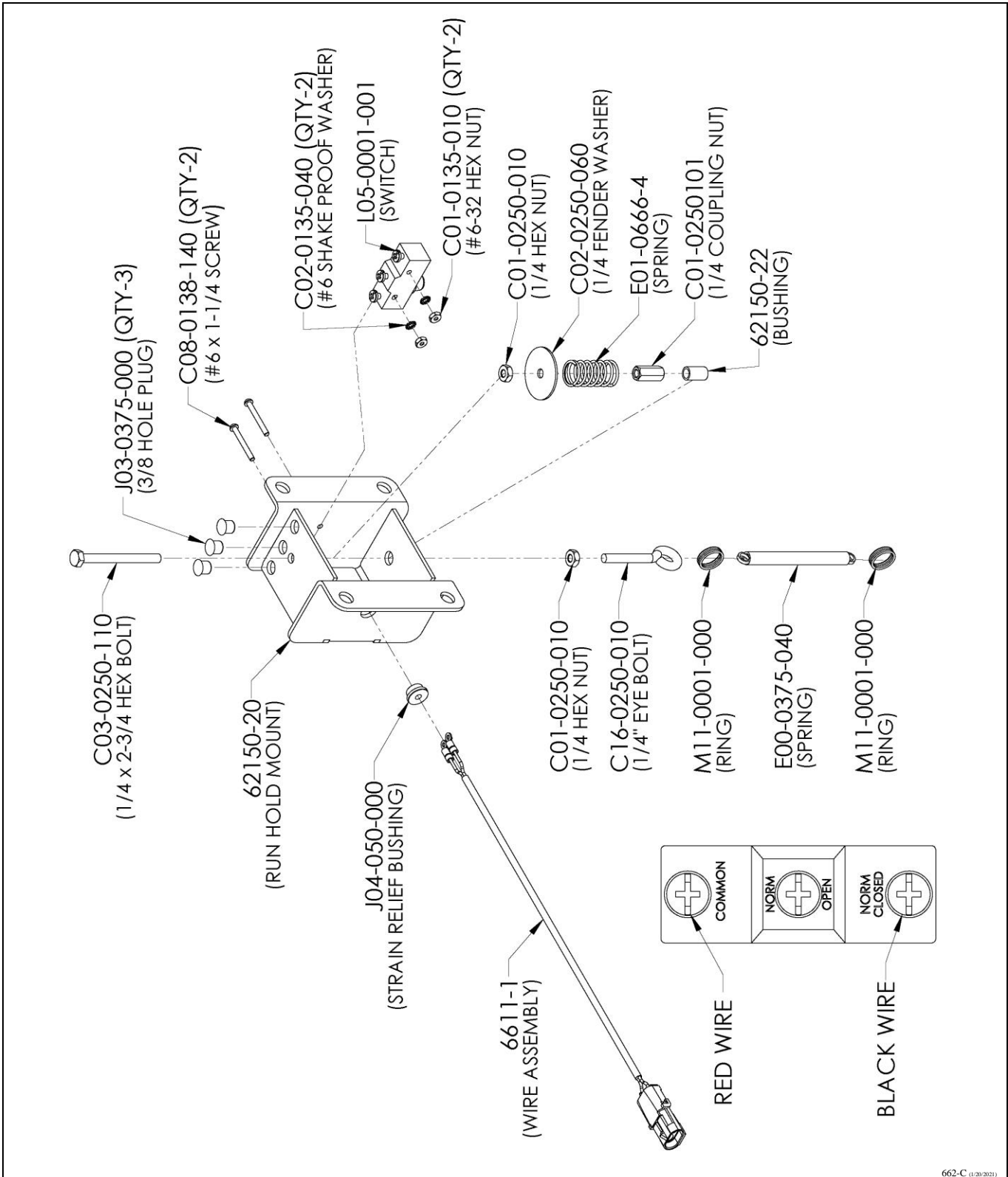

662-C (1/20/2021)

### Air Chamber Blank Plates:

Blank Plate (550829-4) is used to block off unused air chamber openings when not needed.

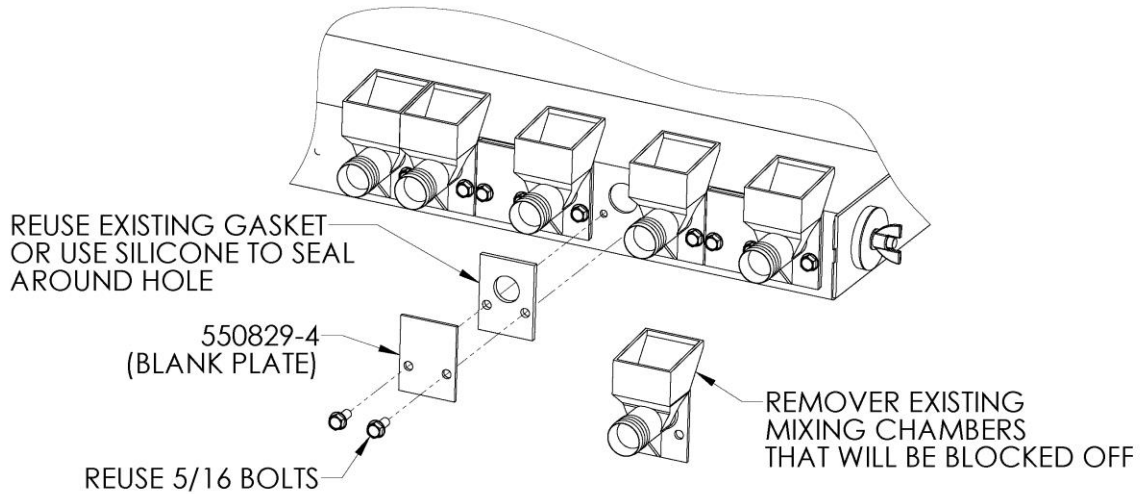

6223-A23 (1/20/2021)

### Metering Door Blank Plate:

Blank Plate (62852-20) is used to block off unused metering door openings when not needed.

To remove shaft; First remove sensor hub from shaft, then unbolt bearing flange by sprocket on metering shaft and pull shaft out. Reassembly by reversing instructions.

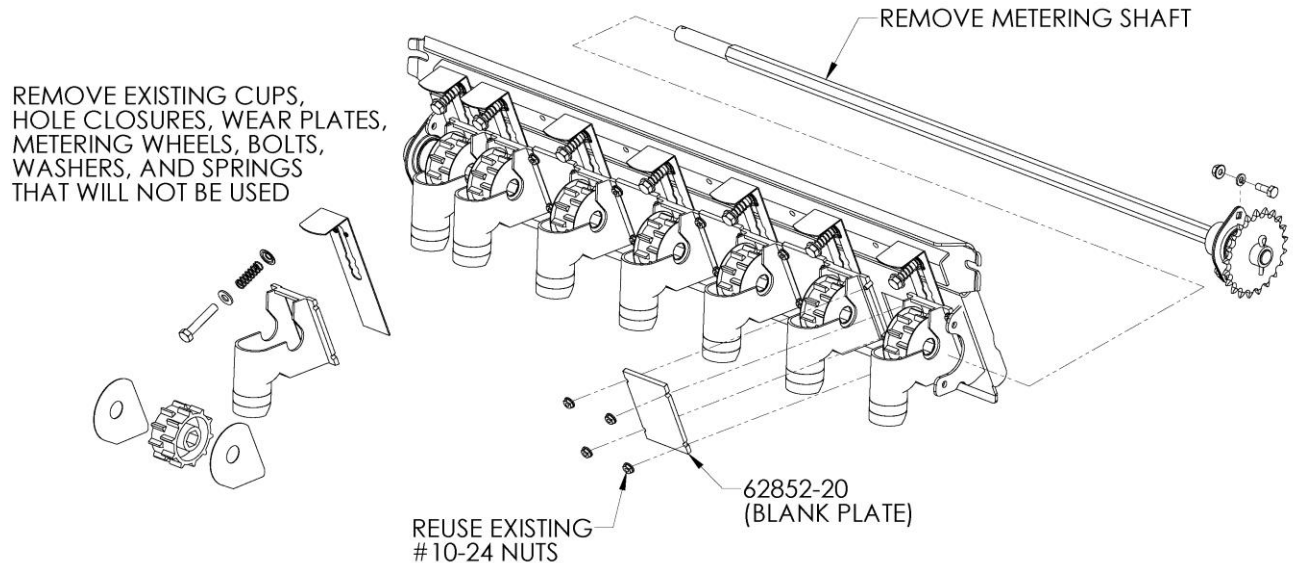

6223-A24 (1/20/2021)

## Manual Holder Bracket

Mount manual holder to corner of hopper or convergent location on implement.  
Store Operator's manual, Packing List & Rate Chart of convergent access.

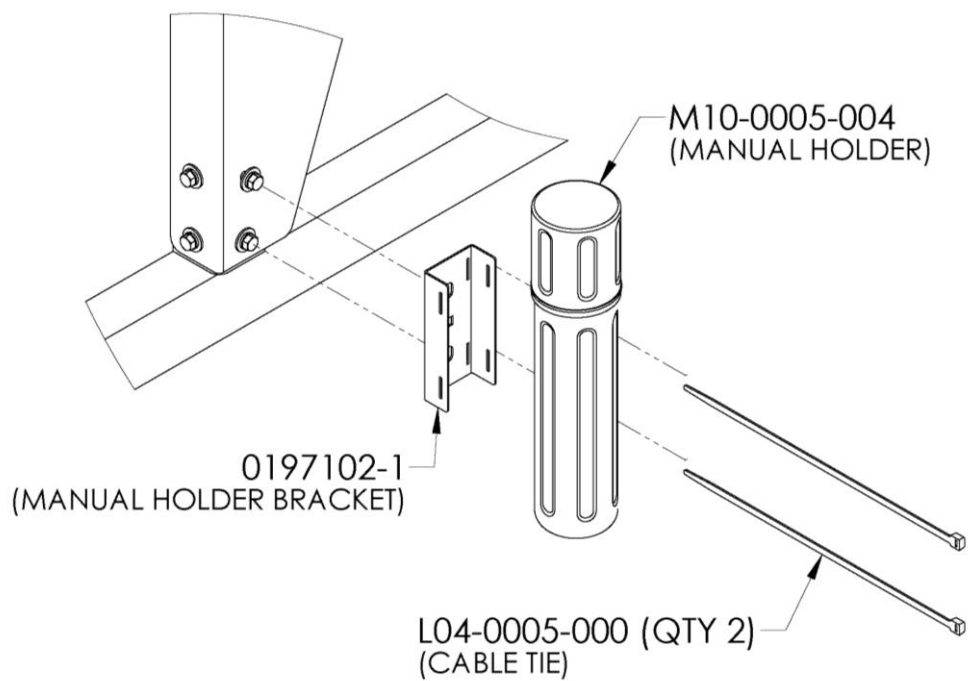

HOLDER-1 (2/20/2021)