



# Illustrated Parts & Packing List

815 Rice Lake Street, Owatonna, MN 55060

For a complete distributor & dealer list go to [www.gandy.net](http://www.gandy.net)

## 6504PTH 65 Series 4-Ft 3-Pt Hitch Spreader

(Purchase Electric or Hydraulic Drive Packages Separately)

1	654-1	Hopper, 4-Foot 65 Series
		Use: 1 Decal, 65 Series Drop Spreader (N02-0001-075)
2	654-5	Bearing, End & Center
2	010743	Grease Tube
		Use: 2 Hex Nut, Fine Thread (3/8-24) (C01-0375-011)
		2 Grease Fitting (D01-5010-050)
1	0646511	Bottom & Slide, 4-Foot (20 Openings) (Assembled)
		Use: 12 Hex Bolt (1/4 x 5/8) (C03-0250-020)
		12 Whiz Flange Nut (1/4) (C01-0250-030)
		12 Wrought Washer (1/4) (C02-0250-030)
		1 Pin, Hitch Handle (0608510)
		2 Cotter Pin (1/8 x 3/4)(C20-0125-020)
		3 Tension "T" (0105215)
		3 Hex Bolt (1/4 x 2-1/4) (C03-0250-090)
		3 Hex Nut (1/4) (C01-0250-010)
		3 Spring (E01-05215-3)
		1 Clevis Pin (5/16 x 4) (C22-0312-310)
		1 Cotter Pin (1/8 x3/4) (C20-0125-020)
1	0405575	Cam Gauge
		Use: 1 SAE Washer (3/8) (C02-0375-020)
		1 Wing Nut (3/8) (C01-0375-020)
1	654-2	Cover, 4 Foot
		Use: 2 Clevis Pin (1/4 x 2-5/8) (C22-0250-200)
		4 Cotter Pin (3/32 x 3/4) (C20-0093-020)
		2 Cover Lock (1406318)
2	654-4	Spacer, Stainless Steel
1	6514-3	Rotor Bar, 4-Foot, One Piece
1	0645521	Wind Guard, 4-Foot (Spreadplate)
		Use: 2 Sash Chain (#50) (21-Links) (05108121-1/1) (in place)
		2 Cotter Pin (3/16 x 3/4) (C20-0187-010) (in place)
1	6510-1	Side Mount Bracket, Left, 3-Pt Hitch
		Use: 4 Hex Bolt (3/8 x 1) (C03-0375-041)
		4 Lock Washer (3/8) (C02-0375-010)
		4 Hex Nut (3/8) (C01-0375-010)
1	6510-2	Side Mount Bracket, Right, 3-Pt Hitch
		Use: 4 Hex Bolt (3/8 x 1) (C03-0375-041)
		4 Lock Washer (3/8) (C02-0375-010)
		4 Hex Nut (3/8) (C01-0375-010)

- 1..... 6510-4..... Tool Bar, 51-inch
- 2..... 09068347..... Clamp Cap
  - Use: 4 Hex Bolt (1/2 x 6) (C03-0500-201)
  - 4 Wrought Washer (1/2) (C02-0500-030)
  - 4 Lock Washer (1/2) (C02-0375-010)
  - 4 Hex Nut (1/2) (C01-0500-010)
- 4..... 6510-3..... Parking Stand, 20-inch
  - Use: 4 Clevis Pin (3/8 x 2-1/4) (C22-0375-140)
  - 4 Hair Pin Cotter (1/8 x 2-9/16) (C21-0125-030)
- 1..... 6510-8..... Mounting Bracket Hand Shut-Off
- 1..... 6510-7..... Shut-Off Handle, 3-Pt Hitch
  - Use: 1 Hex Bolt (1/2 x 1-1/4) (C03-0500-050)
  - 1 Lock Nut, Center Point (1/2) (C01-0500-040)
- 1..... 0605227..... Connector Link
  - Use: 3 Cotter Pin (1/8 x 3/4) (C20-0125-020)
- 1..... 2305880-1..... 3-Pt Hitch, Left
- 1..... 2305880-2..... 3-Pt Hitch, Right
  - Use: 1 Hex Bolt (1/2 x 3-1/2) (C03-0500-141)
  - 1 Lock Washer (1/2) (C02-0500-010)
  - 1 Hex Nut (1/2) (C01-0500-010)
- 1..... 0306982-3..... Bushing (3/4 x 1-7/8 Long)
- 2..... 09068347..... Clamp Cap
  - Use: 4 Hex Bolt (1/2 x 5-1/2) (C03-0500-191)
  - 4 Wrought Washer (1/2) (C02-0500-030)
  - 4 Lock Washer (1/2) (C02-0500-010)
  - 4 Hex Nut (1/2) (C03-0500-010)
- 1..... 0706980-5..... Yoke Pin, Cat 1
  - Use: 1 Spring Pin (5/16 x 2) (C23-0312-220)
  - 1 Lynch Pin (7/16 x 1-3/4) (M11-0437-175)
- 2..... 0706980-3..... Hitch Pin
  - Use: 2 Lock Washer (7/8) (C02-0875-010)
  - 2 Jam Nut (7/8-14) (C02-0875-060)
  - 2 Lynch Pin (7/16 x 1-3/4) (M11-0437-175)
- 1..... Packet Containing: Rate Chart, Operators Manual & Packing List (Shipped in Hopper)**

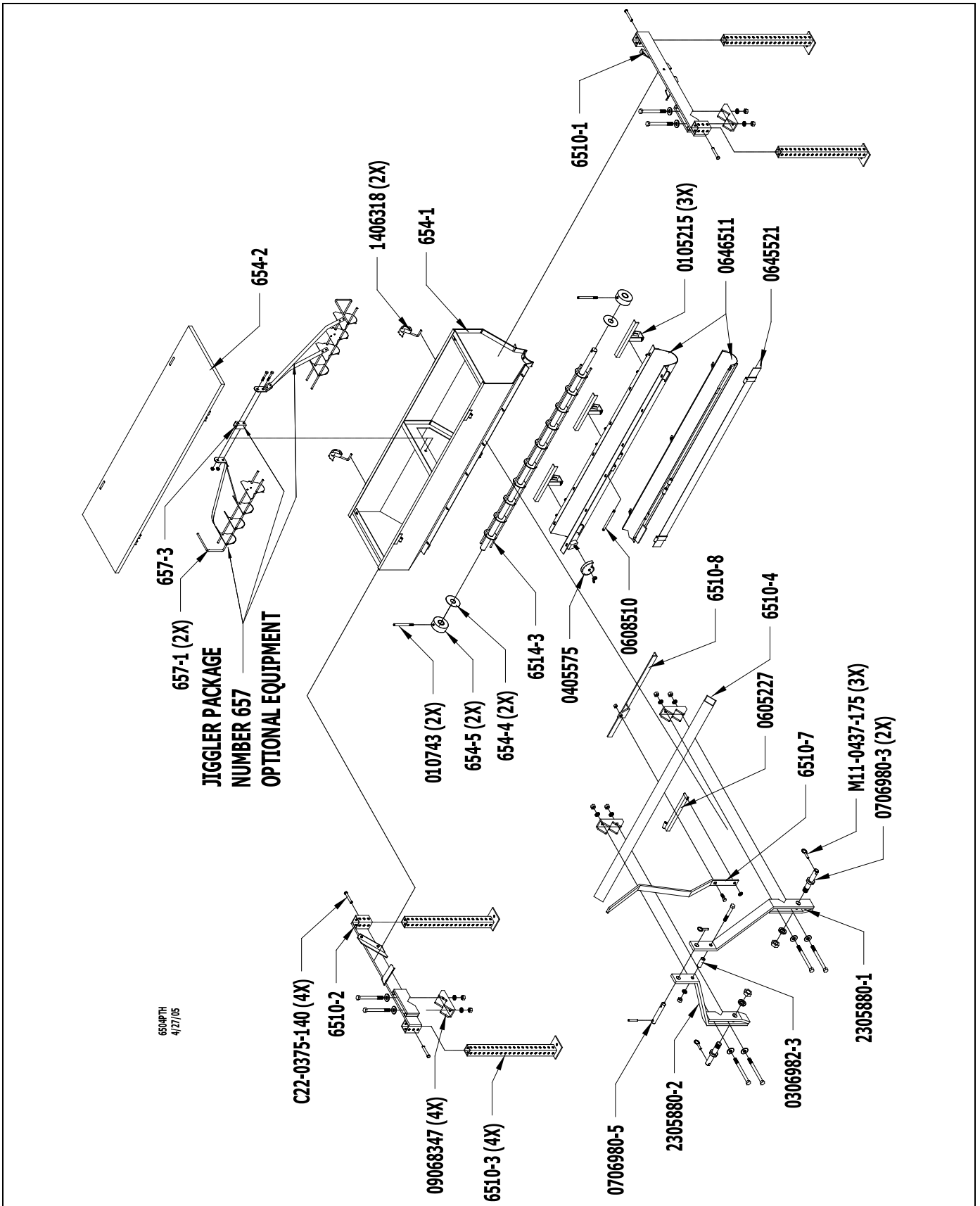

6504PTH  
4/27/05

GDY-6504PTH-PPL  
 Drawings: 6504PTH  
 December 14, 2011  
 Revised From (9/27/11)  
 Printed in the USA