



Illustrated Parts & Packing List

815 Rice Lake Street, Owatonna, MN 55060

For a complete distributor & dealer list go to www.gandy.net

Model 6505PTH

3-PT Hitch Spreader – 5 Foot

(Purchase Electric or Hydraulic Drive Packages Separately)

One Hopper Bundle Containing

1.....	655-1.....	Hopper, 5 Foot
		Use: 1 Decal, 65 Series Drop Spreader (N02-0001-075)
2.....	654-5.....	End & Center Bearing
2.....	010743.....	Grease Tube
		Use: 2 Hex Nut, Fine Thread (3/8-24) (C01-0375-011)
1.....	0656511.....	Bottom & Slide, 5 Foot (26 Openings) (Assembled)
		Use: 16 Hex Bolt (1/4 x 5/8) (C03-0250-020)
		16 Whiz Flange Nut (1/4) (C01-0250-030)
		16 Wrought Washer (1/4) (C02-0250-030)
		1 Pin, Hitch Handle (0608510)
		2 Cotter Pin (1/8 x 3/4) (C20-0125-020)
		3 Tension "T" (0105215)
		3 Hex Bolt (1/4 x 2-1/4) (C03-0250-090)
		3 Hex Nut (1/4) (C01-0250-010)
		3 Spring (E01-05215-3)
		1 Clevis Pin (5/16 x 4) (C22-0312-310)
		1 Cotter Pin (1/8 x 3/4) (C20-0125-020)
1.....	0405575.....	Cam Gauge
		Use: 1 SAE Washer (3/8) (C02-0375-020)
		1 Wing Nut (3/8) (C01-0375-020)
1.....	655-2.....	Cover, 5 Foot
		Use: 2 Clevis Pin (1/4 x 2-5/8) (C22-0250-200)
		4 Cotter Pin (3/32 x 3/4) (C20-0093-020)
		2 Cover Lock (1406318)
2.....	654-4.....	Stainless Steel Spacer
1.....	6515-3.....	Rotor Bar, 5 Foot, One Piece
1.....	0655521.....	Wind Guard, 5 Foot
		Use: 2 Sash Chain (#50, 21-Links) (05108121-1/1) (in place)
		2 Cotter Pin (3/16 x 3/4) (C20-0187-010) (in place)
1.....	6510-1.....	Side Mount Bracket, Left, 3 Point Hitch
		Use: 4 Hex Bolt (3/8 x 1) (C03-0375-041)
		4 Lock Washer (3/8) (C02-0375-010)
		4 Hex Nut (3/8) (C01-0375-010)
1.....	6510-2.....	Side Mount Bracket, Right, 3 Point Hitch
		Use: 4 Hex Bolt (3/8 x 1) (C03-0375-041)
		4 Lock Washer (3/8) (C02-0375-010)
		4 Hex Nut (3/8) (C01-0375-010)

- 1..... 6510-5..... Tool Bar, 63-inch
- 2..... 09068347..... Clamp Cap
 - Use: 4 Hex Bolt (1/2 x 6) (C03-0500-201)
 - 4 Wrought Washer (1/2) (C02-0500-030)
 - 4 Lock Washer (1/2) (C02-0375-010)
 - 4 Hex Nut (1/2) (C01-0500-010)
- 4..... 6510-3..... Parking Stand, 20-inch
 - Use: 4 Clevis Pin (3/8 x 2-1/4) (C22-0375-140)
 - 4 Hair Pin Cotter (1/8 x 2-9/16) (C21-0125-030)
- 1..... 6510-8..... Mounting Bracket Hand Shut-Off
- 1..... 6510-7..... Shut-Off Handle, 3 PT Hitch
 - Use: 1 Hex Bolt (1/2 x 1-1/4) (C03-0500-050)
 - 1 Lock Nut, Center Point (1/2) (C01-0500-040)
- 1..... 0605227..... Connector Link
 - Use: 3 Cotter Pin (1/8 x 3/4) (C20-0125-020)
- 1..... 2305880-1..... 3-PT Hitch, Left
- 1..... 2305880-2..... 3-PT Hitch, Right
 - Use: 1 Hex Bolt (1/2 x 3-1/2) (C03-0500-141)
 - 1 Lock Washer (1/2) (C02-0500-010)
 - 1 Hex Nut (1/2) (C01-0500-010)
- 1..... 0306982-3..... Bushing (3/4 x 17/32 w. x 1-7/8)
- 2..... 09068347..... Clamp Cap
 - Use: 4 Hex Bolt (1/2 x 5-1/2) (C03-0500-191)
 - 4 Wrought Washer (1/2) (C02-0500-030)
 - 4 Lock Washer (1/2) (C02-0500-010)
 - 4 Hex Nut (1/2) (C03-0500-010)
- 1..... 0706980-5..... Yoke Pin, Cat 1
 - Use: 1 Spring Pin (5/16 x 2) (C23-0312-220)
 - 1 Lynch Pin (7/16 x 1-3/4) (M11-0437-175)
- 2..... 0706980-3..... Hitch Pin
 - Use: 2 Lock Washer (7/8) (C02-0875-010)
 - 2 Jam Nut (7/8-14) (C02-0875-060)
 - 2 Lynch Pin (7/16 x 1-3/4) (M11-0437-175)
- 1..... **Envelope Containing: Rate Chart, Operators Manual & Packing List Taped To Cover**

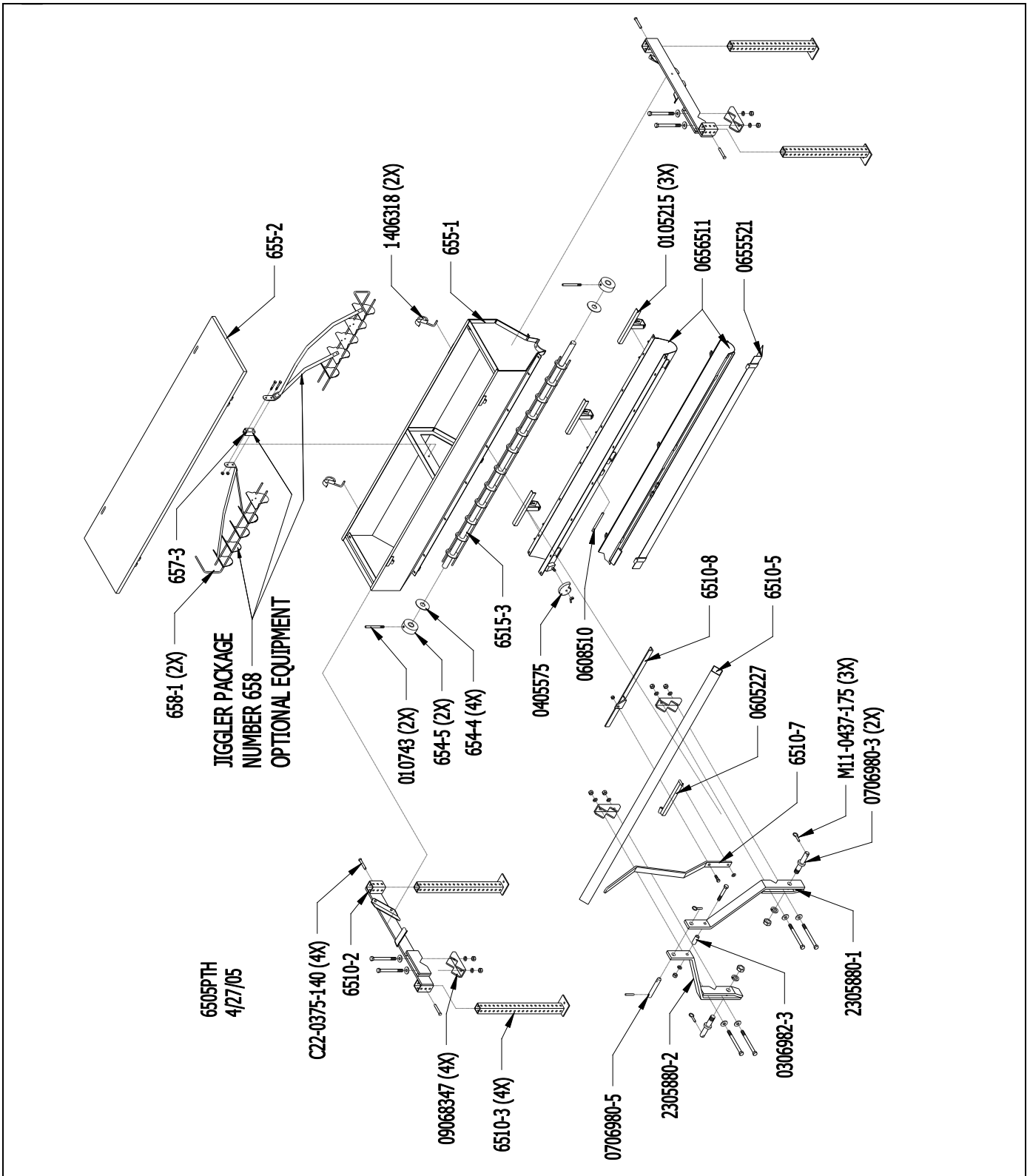

6505PTH
4/27/05

GDY-6505PTH-PPL
 Drawings: 6505PTH
 September 27, 2011
 Revised From (4/27/05)
 Printed in the USA